

Legacy® Series Integrated Positioning System

PRESSURIZED OUTDOOR ENCLOSURE, COAXITRON® COMPATIBLE

Product Features

- Indoor/Outdoor Operation, Offering Extra Protection from Adverse Environmental Conditions
- RediLINK® Quick-Connect Feature
- Delrin® Worm-Gear Drives
- Optional Preset Positioning and 360° Pan Rotation
- Gold-Plated Pin Connectors Ensure Reliable Contact
- Prewired, Internal Feedthrough
- Easily Removed Clamshell Covers
- Bottom-Opening Wall Mount Houses Integral Receiver
- Receiver Offers Adjustable Lens Voltages, Selectable Camera Voltages for NTSC or PAL Video, Transient Suppression Circuit Protection, and Auto/Random Scan as Standard Features

The **Legacy® Series** for adverse environments is designed to protect equipment exposed to severe indoor/outdoor conditions. The innovative system consists of “building block” components designed to simplify installation. Components include a pressurized enclosure, pan/tilt, receiver, and wall mount. The system also features Pelco’s RediLINK® mechanical and electrical quick-connectors making assembly fast and effortless.

The **Legacy Series** pressurized enclosure is designed to meet stringent environmental standards. The enclosure is factory sealed and pressurized with dry nitrogen to 5 psi. Should the camera or lens require servicing, the enclosure may be easily recharged in the field. A relief valve prevents overcharging of the enclosure. Constructed of aluminum, the enclosure features an adjustable mounting cradle, thermostatically controlled heaters, and lens preset capabilities. An optional sun shroud is available for additional protection from the elements.



LEGACY PT780 PAN/TILT
AND EH8106L ENCLOSURE

The **Legacy Series** pan and tilt is capable of handling loads up to 52 pounds (23.6 kilograms) and features gold-plated electrical pin connectors to ensure reliable contact and smooth operation. The pan and tilt also features a Delrin® worm gear that requires no lubrication, is corrosion-resistant, and ensures long life. Limit stops are internally adjustable. Available in fixed or variable speed models, options for the pan and tilt include preset positioning, heater blanket, and 360-degree pan positioning. The pan and tilt is prewired for internal feedthrough for all enclosure and camera functions.

The receivers in the **Legacy Series** have a simple 3-wire power connection with an on/off switch that supplies power to the entire system. Choose from fixed or variable speed models, with or without presets, for 120/24/230 VAC applications. All models are compatible with Coaxitron® control systems and Pelco RS-422 control systems utilizing Pelco D or Pelco P type protocols.

The **Legacy Series** wall mount is constructed from aluminum. The mount opens from the bottom for easy access and installation of the **Legacy Series** receiver. The mount can also be used for pole, corner, and parapet applications when used with the appropriate adapter.



by Schneider Electric

International Standards
Organization Registered Firm;
ISO 9001 Quality System



C1420 / REVISED 3-29-11

TECHNICAL SPECIFICATIONS

Pan/Tilt

MECHANICAL

Pan Rotation	Movement in horizontal plane: 0 to 355° 0 to 360° (SL models only)
Pan Speed	
VS Models Only	1 to 17°/sec ±1° (maximum load condition)
All Others	9°/sec ±1°
Tilt Rotation	90° down from horizontal; 60° up from horizontal
Tilt Speed	
VS Models Only	1 to 4°/sec ±0.5° (maximum load condition)
All Others	3°/sec ±0.5°
Torque Output	
VS Models Only	18.3 ft-lb (24.8 N-m) at rated voltage and 75°F (23°C)
All Others	23.8 ft-lb (32.3 N-m) at rated voltage and 75°F (23°C)
Maximum Load	
VS Models Only	40 lb (18.14 kg) at specified torque
All Others	52 lb (23.55 kg) at specified torque
Pan/Tilt Drive System	Delrin worm gear; ground and polished stainless steel worm
Pan/Tilt Bearings	Roller thrust bearings and bronze Oilite bushings
Lubricants	
Bearings	NLGI #2; Lithium complex grease fortified with molybdenum
Chain	Teflon chain lubricant, such as Tri-Flow®
Braking	Friction

ELECTRICAL

Input Voltage	120 VAC or 24 VAC, 50/60 Hz 12 VDC (VS models)		
VA Required	(At specified input voltage)		
	<u>120 VAC</u>	<u>24 VAC</u>	<u>12 VDC</u>
Pan	19.2 VA (0.16 A)	21.6 VA (0.9 A)	17.04 VA (1.42 A)
Tilt	32.4 VA (0.27 A)	24 VA (1 A)	12.48 VA (1.04 A)
Total	51.6 VA (0.43 A)	45.6 VA (1.9 A)	29.52 VA (2.46 A)
Maximum Current	2 A per conductor (SL models only)		
Connectors	Amp CPC type, mate supplied (37 pins)		
Motor Type			
VS Models Only	12 VDC continuous duty; DC permanent magnet		
All Others	Single phase, instantaneous reversing, induction type. 120 VAC or 24 VAC, 50/60 Hz, impedance protected. 50% duty cycle; 30 minute rating		
Limit Switches	5 A, 250 VAC maximum; internal adjustment		
Pan/Tilt Conductor Requirements			
Standard Model	20 unshielded, plus video and camera sync coaxial*		
Standard with /PP	27 unshielded, plus video and camera sync coaxial*		
Standard with /SL	14 unshielded, plus video and camera sync coaxial*		
Standard with SL/PP	20 unshielded, plus video and camera sync coaxial*		

*Including safety ground

Note: Two additional conductors may be required with the heater blanket option.

Cable Distances†

PT780P Series

	6 Conductors	7 Conductors†
20 AWG (0.5 mm²)	1,370 ft (417 m)	2,745 ft (836 m)
18 AWG (1.0 mm²)	2,180 ft (664 m)	4,370 ft (1,331 m)
16 AWG (1.5 mm²)	3,470 ft (1,057 m)	6,940 ft (2,115 m)

PT780-24P Series

	6 Conductors	7 Conductors†
20 AWG (0.5 mm²)	59 ft (17.98 m)	118 ft (35.96 m)
18 AWG (1.0 mm²)	94 ft (28.65 m)	188 ft (57.30 m)
16 AWG (1.5 mm²)	149 ft (45.41 m)	298 ft (90.83 m)

PT780-VS Series

	5 Conductors
20 AWG (0.5 mm²)	24 ft (7.3 m)
18 AWG (1.0 mm²)	38 ft (11.58 m)
16 AWG (1.5 mm²)	60 ft (18.28 m)

†Cable distances are based on:

- 26.4 VAC output voltage from controller (24 VAC models) or 132 VAC output voltage from controller (120 VAC models) or 12 VDC output voltage from controller (12 VDC models), and
- 10% cable loss with both motors (pan/tilt) running simultaneously

‡Using 2-wire motor common

GENERAL

Construction	
Pan/Tilt	Aluminum exterior; painted steel and aluminum interior parts
Worm Gear	Delrin, premium performance acetal
Worm	Ground and polished stainless steel
Environment	Indoor/outdoor
Ambient Temperature	-10° to 140°F (-23° to 60°C)
Unit Weight	21.5 lb (9.7 kg) approximate
Shipping Weight	25.0 lb (11.3 kg) approximate

CERTIFICATIONS/RATINGS (Pan/Tilt Only)

- CE, Class B
- Meets NEMA Type 3R and IP54 standards (pan/tilt only)

LEGACY PT780 SERIES PAN/TILT

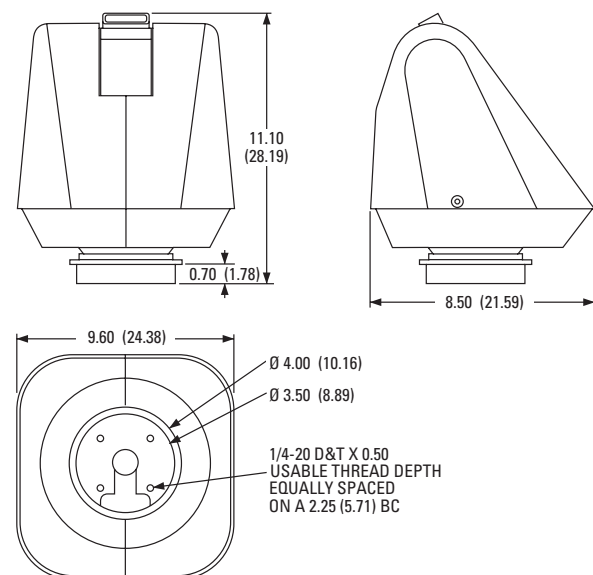

NOTE: VALUES IN PARENTHESES ARE CENTIMETERS; ALL OTHERS ARE INCHES.

TECHNICAL SPECIFICATIONS

Enclosure MECHANICAL

Front Window	Tempered glass, 0.225-inch (5.71 mm) thick
Camera Mounting	Multiple mounting holes on camera sled allow for linear adjustment
Maximum Camera/Lens Size	Accepts camera and lens combinations* (including BNC connector) up to: 18" L x 4.00" W x 4.00" H (45.72 x 10.16 x 10.16 cm) or 18" L x 5.00" D (45.72 x 12.7 cm)
Enclosure Mounting	RediLINK 26-pin connector mates enclosure to pan/tilt
Purge Fitting	Standard Schrader valve to allow enclosure to be filled with dry nitrogen
Purge Relief Fitting	Prevents over pressurization of enclosure

*Assumes lens is fully extended.

ELECTRICAL

Input Voltage	120 VAC (230 VAC optional) for heaters (factory wired for 120 VAC; must specify 230 VAC at time of order)
Power Consumption (for heaters)	80 W Heaters are thermostatically controlled to activate on at 40°F (4°C) and off at 60°F (15°C)
Input Connector	16-pin environmental connector on back plate (links enclosure to pan/tilt). This adheres to military specifications (MIL).
Maximum Cable Distances (120 VAC)	16 AWG (0.5 mm ²) 2,238 ft (682 m) 18 AWG (1.0 mm ²) 1,410 ft (430 m) 20 AWG (1.5 mm ²) 886 ft (270 m)
(230 VAC)	16 AWG (0.5 mm ²) 8,224 ft (2,507 m) 18 AWG (1.0 mm ²) 5,182 ft (1,579 m) 20 AWG (1.5 mm ²) 3,257 ft (993 m)

GENERAL

Construction	Aluminum 6061 T6
Finish	Gray polyester powder coat
Unit Weight	17.2 lb (7.8 kg)
Shipping Weight	23.0 lb (10.4 kg)

ENVIRONMENTAL

Ambient Operating Temperature	–40° to 122°F (–40° to 50°C) with heater(s)
Vibration	5 to 60 Hz with 0.082-inch total travel (15 g at 60 Hz); from 60 to 1,000 Hz, 5 g RMS with random vibration
Altitude	Sea level to equivalent of 10,000 ft (3,048 m)
Acoustic Noise	Operates in 150 dB acoustic noise environments
Humidity	Up to 100% relative humidity; standard Schrader and pressure relief valves provide positive internal pressure with dry nitrogen

CERTIFICATIONS/RATINGS (Enclosure Only)

- CE, Class A
- UL/cUL Listed
- C-Tick
- Meets NEMA Type 6 and IP67 standards (enclosure only)

LEGACY EH8106L ENCLOSURE

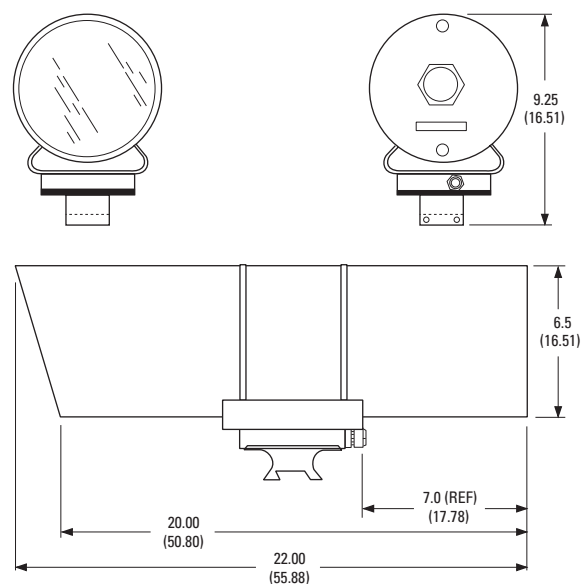

NOTE: VALUES IN PARENTHESES ARE CENTIMETERS;
ALL OTHERS ARE INCHES.

MODEL NUMBERS

MODELS

ENCLOSURE

EH8106L	Legacy pressurized outdoor enclosure with lens preset capabilities and 120 or 230 VAC heaters (specify heater voltage at time of order); contains a 6-inch (15.24 cm) inside diameter and 20-inch (50.8 cm) lower body length; for use with PT780 Series pan/tilts
---------	--

PAN/TILTS

PT780P/PP	Medium duty, indoor/outdoor pan/tilt with RediLINK connector and preset positioning option, 120 VAC
PT780-VS	Medium duty, indoor/outdoor variable speed pan/tilt, 12 VDC
PT780-VS/PP	Medium duty, indoor/outdoor variable speed pan/tilt with preset positioning option, 12 VDC
PT780-VSSL	Medium duty, indoor/outdoor variable speed pan/tilt with 360° pan rotation, 12 VDC
PT780-VSSL/PP	Same as PT780-VSSL except with preset positioning option
PT780-24P	Medium duty, indoor/outdoor pan/tilt with RediLINK connector, 24 VAC
PT780-24P/PP	Same as PT780-24P except with preset positioning option
PT780-24SL	Same as PT780-24P except unit is capable of 360° pan rotation
PT780-24SL/PP	Same as PT780-24SL except with preset positioning option

Note: Legacy systems (enclosure, pan/tilt, receiver, mount, camera, and lens) are available. Consult the factory for available configurations.

OPTIONAL ACCESSORIES

ENCLOSURE

EH8000RKIT	Dry nitrogen recharging kit (nonrefillable)
PSKIT8100	Pressure sensor kit; provides a contact closure that can be wired to trigger an alarm when internal pressure drops to 2 psi
SS8006	Sun shroud

PAN/TILT

HB1*	Heater blanket option, 120 VAC, 40 W (0.33 A); allows operation to -50°F (-45°C); thermostatically controlled to activate at 40°F (4°C) and turn off at 60°F (15°C)
HB2*	Same as HB1 except 24 VAC, 40 W (1.7 A)
HB3*	Same as HB1 except 230 VAC, 40 W (0.17 A)

*Factory installed options only. Please consult factory.

LEGACY RECEIVERS

LRD41A11-1	Integral receiver for use with LWM41 wall mount; fixed speed, Coaxitron compatible; 120 VAC
LRD41C21-1/-2/-3	Integral receiver for use with LWM41 wall mount; fixed speed, Coaxitron/RS-422 compatible with 64 presets; 120/24/230 VAC
LRD41C22-1/-2/-3	Integral receiver for use with LWM41 wall mount; variable speed, Coaxitron/RS-422 compatible with 64 presets; 120/24/230 VAC
LRD41C-CONNKIT	Two 9-pin connectors that interface with the 18-position double-stack Aux/Alarm connector on the LRD41C Series receiver; required to enable the Aux/Alarm capabilities of the receiver
LRD41TLC	Receiver plug-in module for testing control functions

RECOMMENDED MOUNTS

LWM41	Wall mount; can be used with/without optional integral Legacy receiver
PM2000, PM2010	Ceiling/pedestal mount
CM400	Corner mount adapter for LWM41 wall mount
PA2000	Pan/tilt adapter for ceiling/pedestal mount; must use with PM2000/PM2010 mounts
PA402	Pole mount adapter for LWM41 wall mount
PP400	Parapet mount (wall) for LWM41 wall mount
PP4348	Parapet mount (rooftop) for LWM41 wall mount

Pelco by Schneider Electric

3500 Pelco Way, Clovis, California 93612-5699 United States

USA & Canada Tel (800) 289-9100 Fax (800) 289-9150

International Tel +1 (559) 292-1981 Fax +1 (559) 348-1120

www.pelco.com

Pelco, the Pelco logo, and other trademarks associated with Pelco products referred to in this publication are trademarks of Pelco, Inc. or its affiliates. All other product names and services are the property of their respective companies. Product specifications and availability are subject to change without notice.

©Copyright 2011, Pelco, Inc. All rights reserved.