

THIS COPY IS PROVIDED ON A RESTRICTED BASIS AND IS NOT TO BE USED IN ANY WAY DETRIMENTAL TO THE INTERESTS OF PANDUIT CORP.

| PANDUIT PART # | STUD SIZE | | DIMENSIONS in. [mm] | | | | |
|----------------|-----------|--------|---------------------|---------------|---------------|---------------|---------------|
| | ENGLISH | METRIC | L ± .03 [0,8] | W ± .01 [0,3] | C ± .02 [0,5] | M ± .03 [0,8] | H ± .01 [0,3] |
| PMNF1-3F* | -- | M3 | .83 [21,1] | .23 [5,8] | .20 [5,1] | .69 [17,5] | .13 [3,3] |
| PNF18-6F | #6 | M3,5 | .80 [20,3] | .30 [7,6] | .22 [5,6] | .66 [16,8] | .15 [3,8] |
| PNF18-8F | #8 | M4 | .86 [21,8] | .31 [7,9] | .25 [6,4] | .69 [17,5] | .17 [4,3] |
| PNF18-10F | #10 | -- | .87 [22,1] | .34 [8,6] | .26 [6,6] | .71 [18,0] | .20 [5,1] |
| PMNF1-5F* | -- | M5 | .90 [22,9] | .35 [8,9] | .25 [6,4] | .74 [18,8] | .21 [5,3] |
| PNF18-14F | 1/4" | M6 | 1.05 [26,7] | .44 [11,2] | .35 [8,9] | .80 [20,3] | .27 [6,9] |

* NOT UL LISTED OR CSA CERTIFIED

NOTES:

- USED FOR:
 - A. #22-18 AWG [0,5-1,0 mm²] STRANDED COPPER WIRE
 - B. 221°F [105°C] MAX. OPERATING TEMPERATURE
 - C. 600V. MAX. BLDG WIRE (1000 V. MAX. IN SIGNS, FIXTURES & LUMINAIRES)
- INSTALLATION TOOLS:
 - A. UL APPROVED: CT-100A, CT-1550, CT-1551
 - B. PANDUIT APPROVED: CT-160, CT-260, CT-400, CT-460, CT-600A (CT-550CH), CT-2500 (CT-2550CH)
- WIRE STRIP LENGTH: 7/32" ^{+1/32} [5,6 ^{+0,8}]
- MATERIAL:
 - A. STAMPING: .03" [0,8] THK COPPER, TIN PLATED
 - B. HOUSING: NYLON, RED
 - C. SLEEVE: BRASS, TIN PLATED
- SEE www.panduit.com FOR PACKAGE QUANTITIES INDICATED BY PART NUMBER SUFFIX
- DIMENSIONS IN BRACKETS ARE METRIC EQUIVALENT

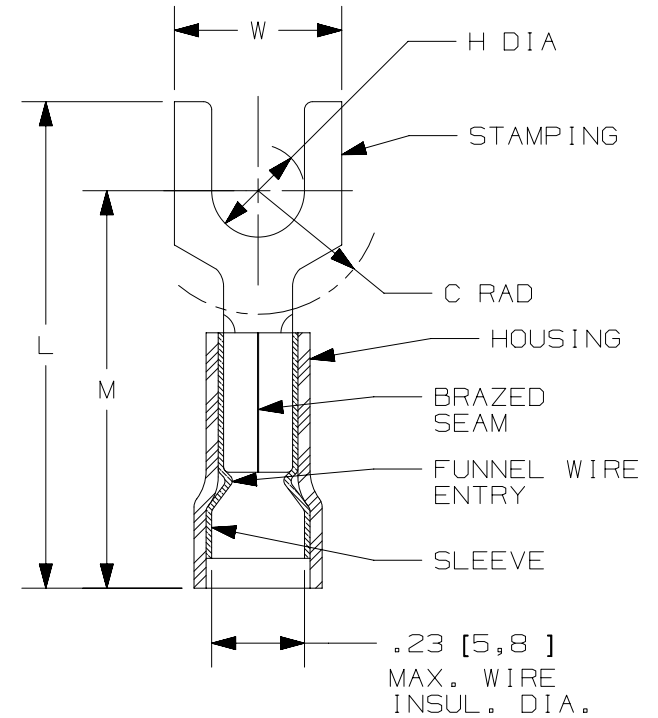

LISTED
587H
E52164



CERTIFIED
LR31212

| REV | DATE | BY | CHK | APR | DESCRIPTION | ECN |
|-----|----------|------|------|-----|--|--------|
| 09 | 12.12.13 | JHNU | JHNU | RGB | REVISED NOTE 2B: CT-550CH WAS CT-520CH, CT-2550CH WAS CT-2525 | A41260 |
| 08 | 11.26.13 | JHNU | TMR | RGB | INDICATED PART NUMBERS WHICH ARE NOT UL LISTED/CSA CERTIFIED | A41260 |
| 07 | 09.19.12 | JBN | LCA | VMB | ADDED METRIC EQUIVALENT. REVISED NOTES. UPDATED TO CURRENT STANDARDS | A41260 |

| | | | | |
|---|------|---------------------------------------|--------|------|
| TITLE | | FORK, NYLON (FUNNEL) INSULATED #22-18 | | |
| | | CUSTOMER DRAWING | | |
| ITEM REVISION NAME | | N41260BA/09 | | |
| DATASET FILE NAME | | N41260BA_DC/09A | | |
| UNLESS OTHERWISE SPECIFIED, DIMENSIONAL TOLERANCES ARE: IN [mm] | | MATERIAL: SEE NOTES | | |
| .x ± .1 [2.54] .xxx ± .005 [.13] | | DRAWING NUMBER: A41260 | | |
| .xx ± .01 [.25] ANGLES ± 5° | | THIRD ANGLE PROJECTION | | |
| DRAWN BY | DATE | CHK | SCALE | SIZE |
| DAW | - | LA | N.T.S. | A |
| SHT 1 OF 1 | | | | |

D101000DA/15