

THIS COPY IS PROVIDED ON A RESTRICTED BASIS AND IS NOT TO BE USED IN ANY WAY DETRIMENTAL TO THE INTERESTS OF PANDUIT CORP.

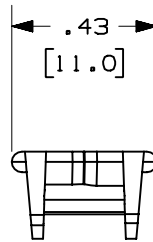
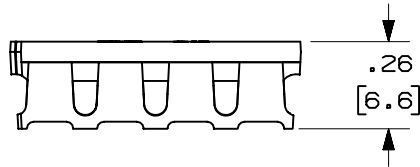
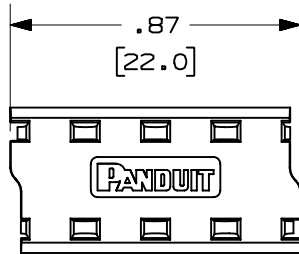

* PANDUIT P/N	WEIGHT
GPRC4	.018 LB/10 PCS (8.0 g/10 PCS)

NOTES:

1. SEE CURRENT CATALOG FOR ADDITIONAL PART NUMBER SUFFIXES TO INDICATE COLOR AND OR PACKAGE QUANTITY.
2. SEE CATALOG FOR COMPLETE LIST OF PARTS APPLICABLE FOR USE WITH THIS PART.
3. DIMENSIONS IN PARENTHESES ARE IN METRIC.
4. MATERIAL:
HOUSING: POLYCARBONATE

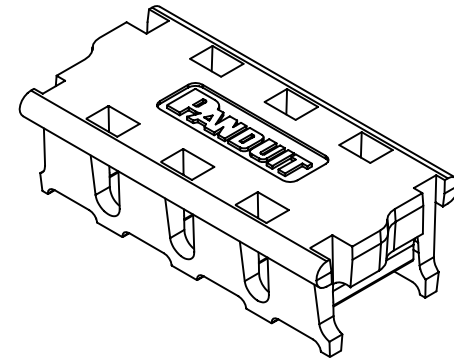

CAD FILENAME/LAYERS

M01122BB_DC_00B.PRT

PANDUIT CORP. TINLEY PARK, ILLINOIS

GIGA-PUNCH™ 4 PAIR WIRE RETENTION CAP
(GPRC4) CUSTOMER DRAWING

UNLESS OTHERWISE SPECIFIED,
DIMENSIONAL TOLERANCES ARE:
(.X) ± (.XXX) ± .010 (.3)
(.XX) ± .03 (.8) ANGLES ±

UNLESS OTHERWISE SPECIFIED,
ALL DIMENSIONS ARE GIVEN
IN INCHES, THIRD ANGLE PROJECTION.

DRAWN BY

LZ

MAT'L:

SEE
NOTES

SCALE

NONE

DATE

02-20-01

DRAWING NO.

01122-02

DWG

A
SIZE

CHECKED BY

KLR

REV	DATE	BY	CHK	DESCRIPTION	ECN	CHK	CUST	SUP
01	7-20-01	LZ		A. UPDATED PRODUCT DESCRIPTION	01122-02			
R	2-20-01	LZ	KLR	RELEASED TO PRODUCTION.	01122-02			