

ULISSE MAXI

PTZ FOR DYNAMIC MONITORING OF LARGE OUTDOOR AREAS

MAIN FEATURES

Variable speed: 0.02°-20°/s Pan and Tilt
 Horizontal continuous rotation, vertical +45°/-20°
 Weatherproof housing for large-size lenses
 IP66
 Optical sensors for absolute positioning feedback
 Camera and lens maximum allowed weight is 7.6kg
 Integrated wiper
 Position accuracy: 0.02°
 Up to 250 Presets
 Operating temperature: -10°C / +60°C (14°F / 140°F)
 Power supply available 230Vac, 24Vac or 120Vac

OPTIONS:

IP based control, MPEG4, 25fps, Full D1 (compatible with Milestone XProtect Suite and ONVIF protocol)
 Germanium window for thermal cameras
 Prearrangement for mounting of two UPTIRN LED illuminators

DESCRIPTION

ULISSE MAXI is a robust and efficient Pan/Tilt/Zoom unit designed for dynamic non-stop video surveillance of large outdoor areas covering significant distances. Reliable and powerful, ULISSE MAXI can contain and manage the largest motorised zoom lenses on the market, with a total weight of up to almost 8 kilos (17.6 pounds), providing a 360° coverage of the area to be monitored.

The version for LED, infrared or white light, illuminators guarantees detailed images even at night.

The robust mechanical structure and the powerful motors of this PTZ are designed to guarantee maximum resistance to high operating stress, vibrations and temperatures up to 60°C, thereby eliminating maintenance needs.

The optical sensors guarantee precise positioning control for any kind of use.

Thanks to the built-in wiper, the images result always perfectly clear; wide choice of tanks with washer pump available with different capacities and delivery heights.

The IP versions can integrate ULISSE MAXI PTZ in a network system with the control of all PTZ functions.

ULISSE MAXI is the ideal solution for demanding safety applications such as coastal and port monitoring, border patrol, military installations and perimeter surveillance.



ULISSE MAXI + 2 UPTIRN



ULISSE MAXI + 2 UPTIRN+ UPTWBTAB

TECHNICAL DATA**GENERAL**

Built in aluminium and ABS
 Epoxypolyester powder painting, RAL9002 colour
 Top mount (OTT)
 Transmission through toothed belt
 Slip-ring
 Electronic limit switches
 Plug installation thanks to connector and easy replacement on-site
 Zero backlash
 Max weight camera+lens: 7.6kg (17lb)
 Optical sensors for absolute positioning feedback
 Configuration of telemetry protocol parameters through dip-switch for RS485

MECHANICAL

Cable glands: 3xM16
 Horizontal rotation: continuous
 Vertical rotation: from +45° to -20°
 Horizontal speed (variable): from 0.02° up to 20°/s
 Tilt speed (variable): from 0.02° up to 20°/s
 Internal usable area: See drawings
 Enclosure glass window (WxH): 112x95mm (4.4x3.7in)
 Preset accuracy: 0.02°
 Unit weight: 30kg (66lb)
 ULISSE MAXI, for thermal cameras:
 Germanium window

- Dimensions (Ø): 85mm (3.3in) (external), 70mm (2.8in) (usable diameter)
- Thick: 2mm (0.07in)
- External scratch-resistant treatment: Hard Carbon Coating (DLC)
- Internal antireflection treatment

 Spectral range: 7.5µm ÷ 14µm
 Medium transmittance (7.5µm ÷ 11.5µm): 94%
 Medium transmittance (11.5µm ÷ 14µm): 90%

ELECTRICAL

Input voltage:

- 230Vac, 50/60Hz, 100W
- 24Vac, 50/60Hz, 100W (150-190W max, version with LED illuminators)
- 120Vac, 50/60Hz, 100W

 Current consumption:

- 230Vac, 0.4A
- 24Vac, 4A (8A, version with LED illuminators)
- 120Vac, 0.8A

 Input cables size: AWG 16 (24Vac) - AWG 18 (120/230Vac)
 Dimensions of signal cables: AWG 20-26
 Housing standard heater: 24Vac, 20W max
 Alarm input: 4 (2, version with LED illuminators), from 10Vdc to 35Vdc
 Dry contacts: 2 (1, version with LED illuminators), 50Vdc max or 30Vac@1A
 Video line: coaxial cable (1Vpp, 750hm)
 Camera power supply: 12Vdc, 800mA
 Power supply to the lens: From 6Vdc to 15Vdc, 200mA max
 Zoom lens controller: polarity inversion and common wire
 Functions: Autopan, Preset, Patrol
 Maximum number of presets for protocol: 250 (VIDEOTEC MACRO)
 15 characters string for Area and Preset titling
 Configuration through OSD

COMMUNICATIONS

RS232 interface for PC control and firmware update
 2-ports RS485: daisy chain configuration or RS232
 Addressable through dip-switch up 255 units
 ULISSE MAXI, IP based control mode:

- Connection Ethernet port LAN 10/100T

PROTOCOLS

Configuration of telemetry protocol parameters through dip-switch
 AMERICAN DYNAMICS, PANASONIC, PELCO D, VIDEOTEC MACRO, VISTA
AMERICAN DYNAMICS, PANASONIC, PELCO, VISTA are registered trademarks.
The product may be interfaced with devices not manufactured by VIDEOTEC. It is possible that the interface protocols have changed or are in a different configuration from earlier tested units by VIDEOTEC. VIDEOTEC recommends a test prior to installation. VIDEOTEC will not be liable for any installation costs or lost revenues in the event a compatibility problem will occur.

ULISSE MAXI, IP based control mode:

- Compression MPEG-4
- Image resolution: Full D1 (720x576), VGA (640x480), CIF (352x288), QCIF (176x144)
- Image frame rate max 25fps at Full D1
- Web Server

ENVIRONMENT

Indoor/Outdoor
 Operating temperature (with heater): -10° (14°F)/+60°C (140°F)
 Resistant to salty fog (EN50130-5, EN60068-2-52)
 Surge immunity: up to 2kV line to line, up to 4kV line to earth (Class 4)

CERTIFICATIONS

CE EN60950-1, EN60950-22, EN61000-6-3 and EN50130-4
 FCC Part 15, Class B
 IP66 EN60529

ACCESSORIES

UPTJBUL	Junction weatherproof box for cables connexion (according UL norm)
UPTIRN108A00	LED illuminator for ULISSE, 10°, 850nm, 24Vac - 12/24Vdc
UPTIRN308A00	LED illuminator for ULISSE, 30°, 850nm, 24Vac - 12/24Vdc
UPTIRN608A00	LED illuminator for ULISSE, 60°, 850nm, 24Vac - 12/24Vdc
UPTIRN109A00	LED illuminator for ULISSE, 10°, 940nm, 24Vac - 12/24Vdc
UPTIRN309A00	LED illuminator for ULISSE, 30°, 940nm, 24Vac - 12/24Vdc
UPTIRN10WA00	LED illuminator for ULISSE, 10°, white light, 24Vac - 12/24Vdc
UPTIRN30WA00	LED illuminator for ULISSE, 30°, white light, 24Vac - 12/24Vdc
UPTIRN60WA00	LED illuminator for ULISSE, 60°, white light, 24Vac - 12/24Vdc
UPTIRPS230	External power supply for ULISSE and ULISSE PLUS, prearranged for two LED illuminators, and control to synchronize IR illuminators with camera Day/Night switching, IN 230Vac, in weatherproof box. Night switch included.
UPTIRPS120	External power supply for ULISSE and ULISSE PLUS, prearranged for two LED illuminators, and control to synchronize IR illuminators with camera Day/Night switching, IN 120Vac, in weatherproof box. Night switch included.
WASPT0V5L5M00	Water tank 5l, pump with delivery up to 5m (16ft), IN 230Vac-24Vac-120Vac
WASPT0V23L5M00	Water tank 23l, pump with delivery up to 5m (16ft), IN 230Vac-24Vac-120Vac
WASPT0V23L11M00	Water tank 23l, pump with delivery up to 11m (36ft), IN 230Vac-24Vac-120Vac
WASPT1V23L30M00	Water tank 23l, pump with delivery up to 30m (98ft) with water floating, IN 230Vac
WASPT3V23L30M00	Water tank 23l, pump with delivery up to 30m (98ft) with water floating, IN 120Vac

RELATED PRODUCTS

ALBERT	Encoder for video content analysis and smart system management
SM82A	Video matrix 8 inputs and 2 outputs
SM164B	Video matrix 16 inputs and 4 outputs
SM328B	Matrix 32 inputs and 8 outputs
DCJ	Keyboard for video and telemetry control
DCT	Video and telemetry touch-screen control keyboard
DCZ	Universal control keyboard for PC applications

BRACKETS AND ADAPTORS

UPTWBA	Wall bracket with internal cable channel
UPTWBTAB	Parapet bracket with internal cable channel

PACKAGE

Model Number	Weight	Dimensions (WxHxL)	Master carton
UPT1SLWA000E	38kg (84lb)	76x41x67cm (30x16x26.4in) -	
UPT1SLGA000E	38kg (84lb)	76x41x67cm (30x16x26.4in) -	

ULISSE MAXI - CONFIGURATION OPTIONS

	Voltage		Options		Video output	
UPT	1 230Vac	SL	W With wiper	A	O Analog control	00E
	2 24Vac		G With germanium front window for thermal cameras applications		X IP MPEG4 control	
	3 120Vac		J With wiper and brackets for UPTIRN (only 24Vac, illuminators not included)			

Not all combinations are possible.

TECHNICAL DRAWINGS

Sizes in millimeters.

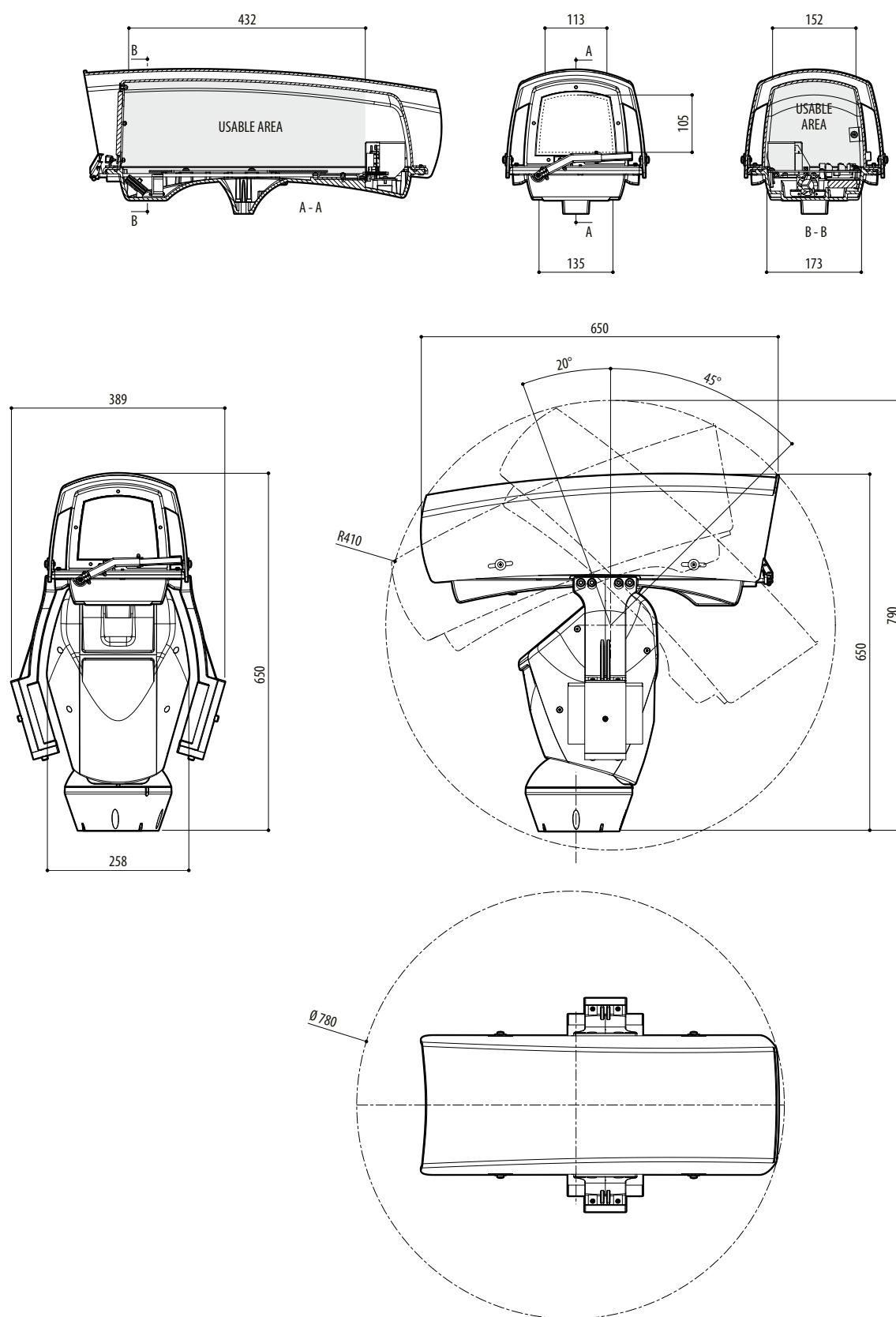

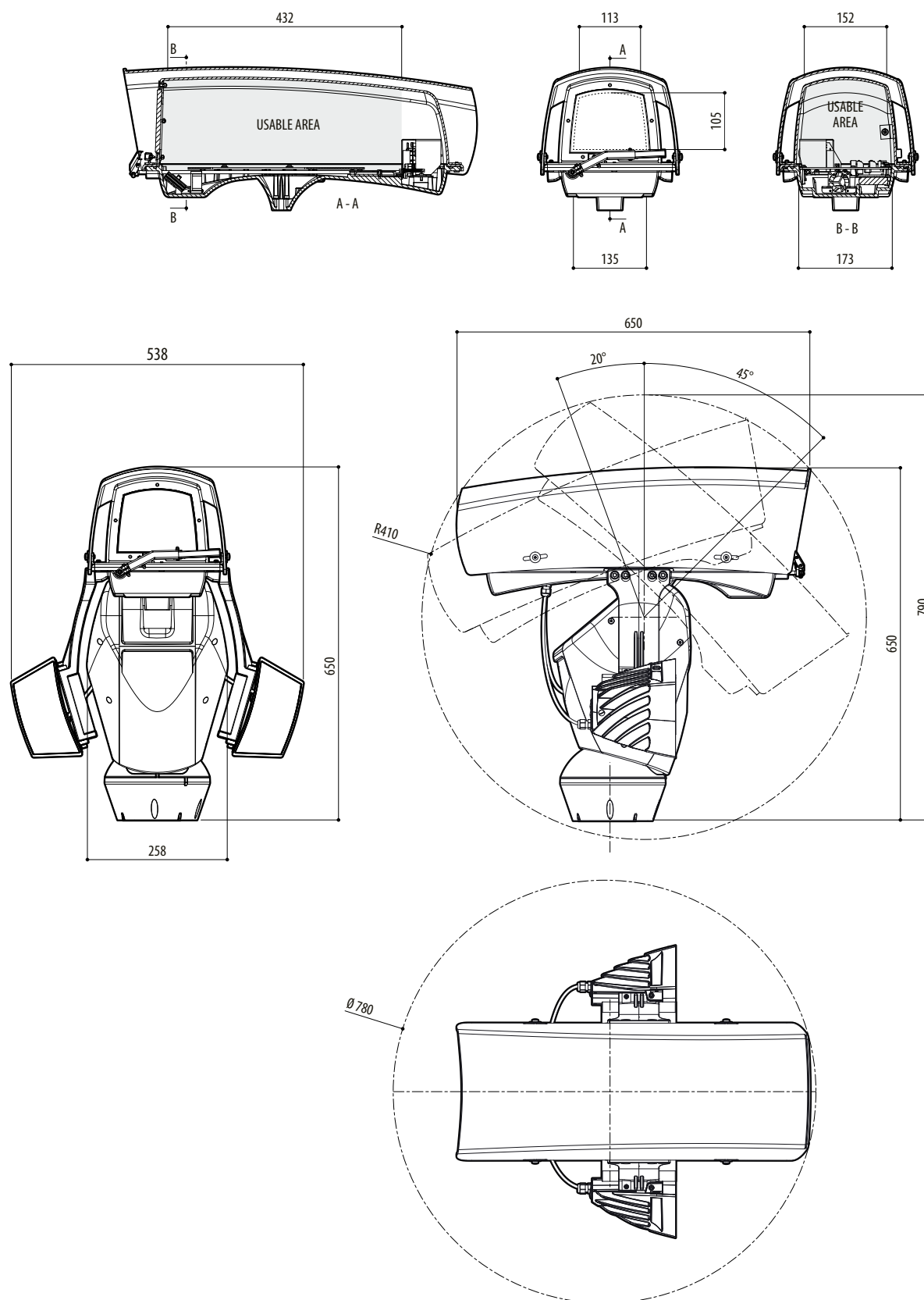

ULISSE MAXI, PRE-ARRANGED VERSION FOR TWO LED ILLUMINATORS INSTALLATION

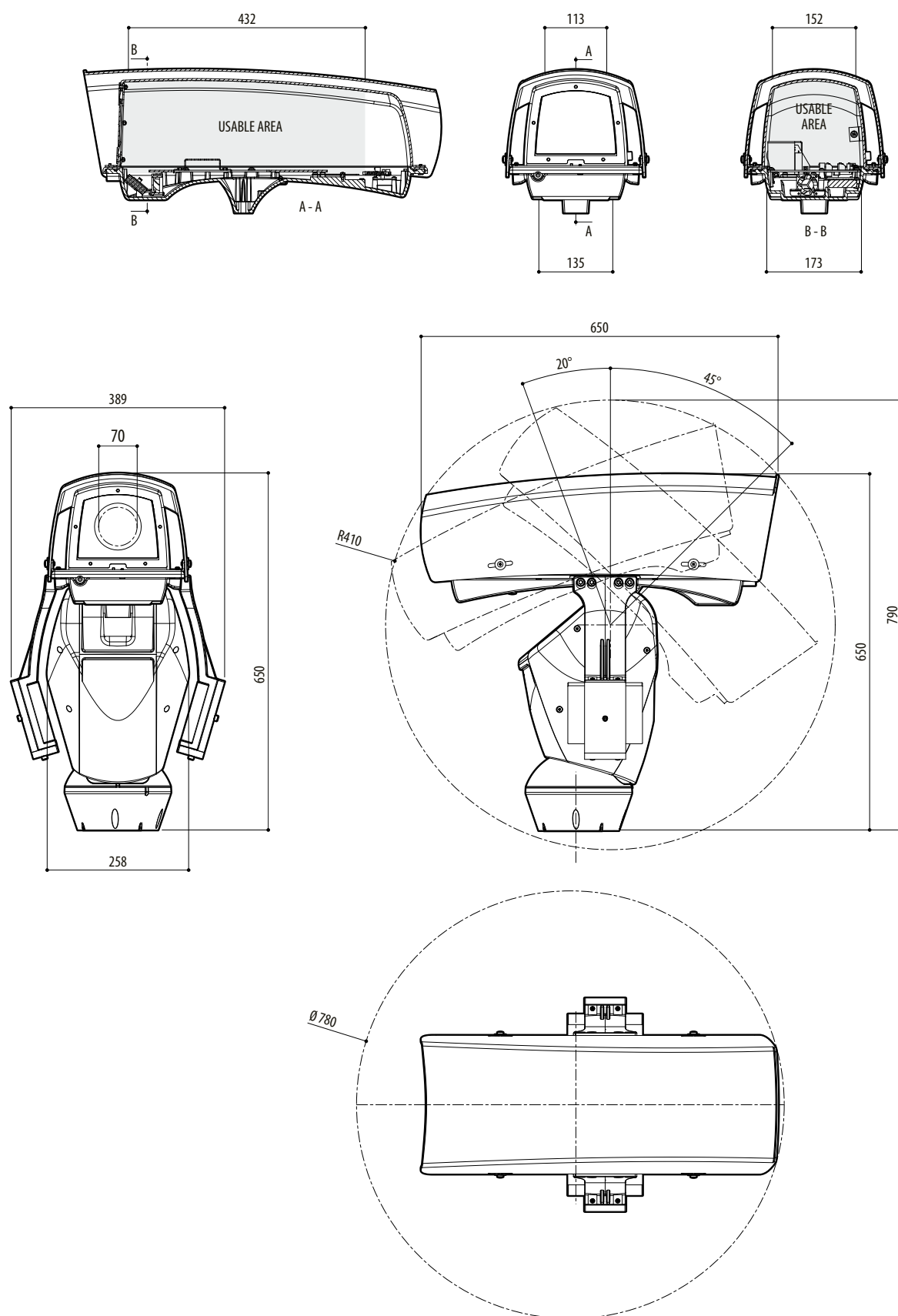

ULISSE MAXI, VERSION FOR THERMAL CAMERAS