

KA-DGR PANEL

Stainless Steel Housing for Color Video Door Stations

KA-DAR With KA-DGR PANEL

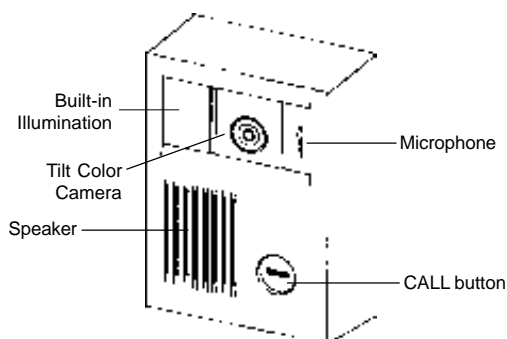

KA-DGR PANEL FEATURES:

- Vandal resistant faceplate
- Weather resistant for outdoor use

K-SERIES DOOR STATION FEATURES:

- Push button to call inside station(s)
- Compact surface mount design
- Cameras mount to 1-gang box or ring
- Tilt color camera
- Call button rings chime at inside monitor
- Audio and video activate with door call-in
- Hands free communication when master answers
- Built-in illumination for low light applications
- External light with automatic activation can be added
- Simple 2-wire hook up - can replace existing doorbell

MOUNTING & INSTALLATION:

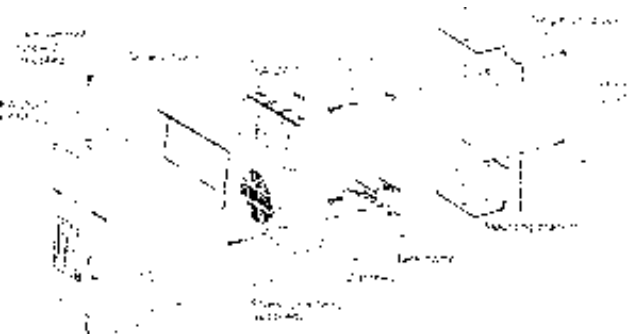

SPECIFICATIONS:

System:	KA, KB and KC series
Power Source:	24V DC - Supplied by monitor
Operating Tempature:	14° ~ 140° F
Communication:	Hands free
Camera Unit:	1/4" Color CCD (Charged Coupled Device) with DSP (Digital Signal Processor)
Image Viewing Area:	31" V x 22" H at 20"
Wiring Distance:	165' w/22AWG; 330' w/18AWG
Faceplate Material:	Stainless Steel
Color:	Polished Stainless Steel
Camera Mounting:	Surface mount
Camera Backbox:	1-Gang box or ring
Dimensions:	5-1/2" x 4-1/8" x 1-5/8"

DESCRIPTION:

The KA-DGR PANEL is a stainless steel housing for Aiphone K-series video system. All K-series cameras feature a color CCD camera with built-in illumination for low light viewing.

A call button on the Color Video Door Station activates an internal monitor(s) with a four stroke chime. Communication at the door is hands free.