

VZ-HDC-8 ADVANTAGES

- Full HD 1080p over coaxial cable, BNC connection
- Optical multi coated ICR Filter
- Aluminum Die-Casting body
- True WDR, True Day and Night, Dual Voltage
- Panasonic 2.2 Megapixel CMOS Sensor
- C & CS Mount
- 1920x1080p/30fps, HD-SDI(BNC) and 700TVL Analog (BNC)
- 0.5Lux (Color), 0.1Lux (B/W), 0.02Lux (Sens-up 30X)
- AGC, ATW, DNR (2D + 3D), Privacy masking, Defog, HLC



MODEL #	VZ-HDC-8
SPECIFICATION	
Imaging Sensor	PANASONIC 2.2 Megapixel CMOS Sensor
HD-SDI Scanning System	Progressive Scan
Number of active pixels	1944 (H) x 1092 (V) = 2,122,848 (pixel)
Number of effective pixels	2010 (H) x 1108 (V) = 2,227,080 (pixel)
S/N Ratio	More than 50dB
HD-SDI Video Output	1080P (1920x1080)
Analog Video Output Level	1.0 Vp-p (75Ω, Composite) NTSC
Min. Illumination	0.5Lux (Color), 0.1Lux (BW), 0.02Lux (Sens-up x30)
Lens	C&CS Mount
Electronic Shutter Speed	Auto / Flk (NTSC : 1/30sec ~ 1/50,000sec)
White Balance	AWC-SET, MANUAL, INDOOR, OUTDOOR
Backlight Compensation	WDR, BLC, HSBLC, Off
Digital - WDR	On, Off
AGC	Adjustable 1 ~ 15
Adjust	SHARPNESS, MONITOR, LSC, NTSC/PAL
True Day & Night	Auto, B.W, Color, EXT
2D/3D-NR	On, Off
Digital Zoom	On (x2 ~ x64) / Off
Privacy Masking	On (8 Zone Selectable) / Off
Motion Detection	On (4 Zone Selectable) / Off
Defect	LIVE DPC / STATIC DPC
Sens - up	On (X2 ~ X30) / Off
D - EFFECT	Freeze / Mirror / D-Zoom / NEG.IMAGE

INTERFACE

HD-SDI – BNC	1
CVBS – BNC (Yellow)	1

WEIGHT & DIMENSIONS

Dimensions	2.36" x 2.36" x 4.33" / 60 x 60 x 110 mm
Net Weight	1.102 lbs / 500g

GENERAL

Language	English (Selectable)
Construction	Aluminum Die-Casting body
Power	- Supplied Voltage AC 24V / DC12V ± 10%
	- Power Consumption Max. 150mA
Regulation	CE, FCC, RoHS, KCE
Humidity	0% to 90%
Operating Temperature	14 ~ 122°F / -10°C ~ 50°C
Storage Temperature	-4 ~ 140°F / -20°C ~ 60°C



OSD Control



OSD Button D-Pad

- SET : Used to access the menu and confirm selection
- UP: Used to move the cursor up
- DOWN : Used to move the cursor down.
- LEFT : Used to move the cursor left and change the value
- RIGHT : Used to move the cursor right and change the value

Contact ViewZ

- Address : 177 W. Orangethorpe Ave., Placentia, CA 92870
- Phone : (714) 996-1177, Fax : (714) 996-1138
- Sales : sales@viewzusa.com
- Specification subject to change without notice.

Manual IRIS LENS CONNECTION

1. Please check whether lens mount type is a C mount or CS mount.
2. **CS mount type:** connect the lens, removing the protective rubber.
C mount type: attach the C mount ring and connect the lens.
3. Go to the camera setup and set the LENS mode as MANUAL.

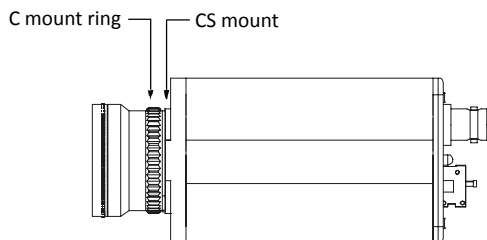

Auto IRIS LENS CONNECTION

1. Connect the lens just like the manual lens connection.
2. Connect the auto IRIS lens connector to the connector on the rear panel.
3. Go to the camera setup and set the LENS mode as AUTO.

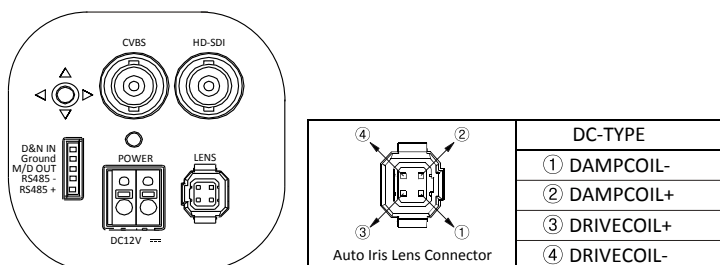

DIMENSIONS

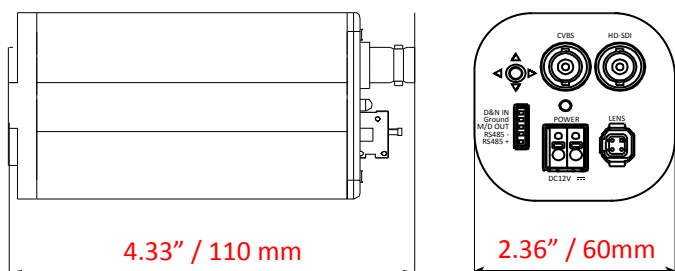

PRECAUTIONS



Do not use the camera if fumes, smoke or a strange odor is emitted from the unit, or if it seems to not function correctly. Disconnect the power source immediately and consult your supplier.



Always follow the instructions in the installation guide when applying power. Fire and equipment damage can occur if power is applied incorrectly. For the correct power supply, refer to the specification sheet.



Do not install or operate in small, unventilated areas. Heat build up can significantly reduce the performance and operating life of the product and may cause a fire.



To prevent damage, do not drop the camera or subject it to strong shock or vibration.



If installed close to a TV, radio transmitter, magnet, electric motor transformer or audio speakers the magnetic field generated may interfere with or distort the image.



Whether or not the camera is used outdoors, never point it toward the sun. Use caution when operating the camera in the vicinity of spot lights or other bright lights and light reflecting objects.



Do not use the camera in extreme environments where high temperatures or high humidity exists. Use the camera under conditions where temperatures are between 14°F ~ 122°F (-10°C ~ 50°C), and humidity is below 90%.

REGULATORY NOTICE

This device complies with part 15 of the FCC Rules.
Operation is subject to the following two conditions:

- This device may not cause harmful interference
- This device must accept any interference received, including interference that may cause undesired operation.

Contact ViewZ

- Address : 177 W. Orangethorpe Ave., Placentia, CA 92870
- Phone : (714) 996-1177, Fax : (714) 996-1138
- Sales : sales@viewzusa.com
- Specification subject to change without notice.