

inorax-ST Cabinets

inorax-ST Network Cabinet

Inorax-ST, a cost effective network rack cabinet system fulfills high density cabling and data center requirements. With its modular structure, a practical option for your future plans. Offers advanced fiber and copper cable management options; helps simplify cable installation and maintenance while providing maximum cable capacity for your high-density cabling requirements. A wide range of cable management accessories is available to ensure perfect management of copper, fiber cables and 19" equipment.

Flat-pack option enables savings up to 60% in the transport cost and warehouse space.

Technical Features

Material 1,2 - 1,5 - 2mm Steel

Color RAL 7035 or RAL 9005

Compliance RoHS, UL Certified

Packaging Assembled or unassembled

Maximum Static Load Up to 1500 kg.

Finish Doors, side panels, top and bottom covers

Electrostatic Powder Paint, 19" mounting rails: Zinc-plated

Related Accessories Cable Organizer

Blanking Panels

Cable Channels

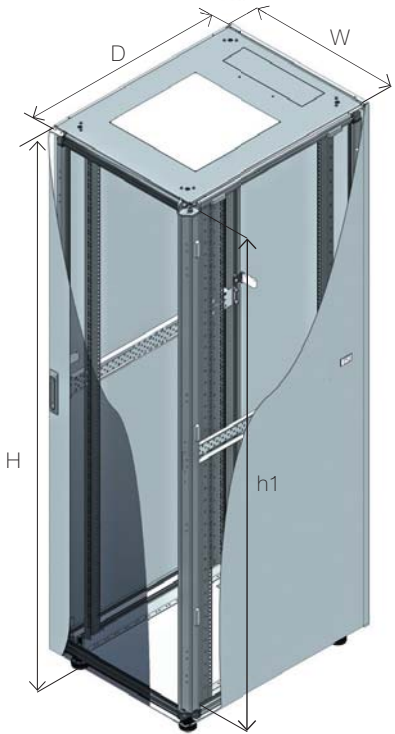

Standard Configuration:

- ✓ Front door with safety glass
- ✓ Solid Side Panels with cylindrical locks and latches
- ✓ Solid Rear Panel with cylindrical locks
- ✓ Internal top sheet with 3 cable entry and fan cut-outs
- ✓ 2 Pairs of depth adjustable heavy duty 19" Mounting Rails
- ✓ 2 Pairs of Adjustable Feet
- ✓ Front Door with swing-handle single point lock
- ✓ Color RAL 7035 or RAL 9005
- ✓ RoHS compliant, UL and Gost-R Certificated
- ✓ Bottom cover

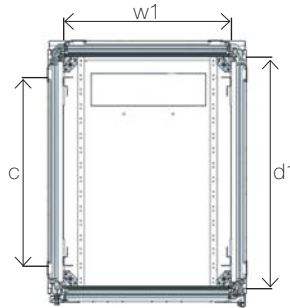

Order Information

Height U	Outer Width (W) mm	Outer Depth (D) mm	Outer Height (H) mm	Inner Height (h1) mm	Inner Width (w1) mm	Inner Depth (d1) mm	19" Rails Adjustable Depth Range (c)	Weight kg	Part No
16U	600	600	878	718	503	550	123 - 373	52,82	CSN-X-1666A
22U	600	600	1144	984	503	550	123 - 373	62,21	CSN-X-2266A
22U	600	800	1144	984	503	750	123 - 573	70,66	CSN-X-2268A
26U	600	600	1322	1162	503	550	123 - 373	68,49	CSN-X-2666A
26U	600	800	1322	1162	503	750	123 - 573	77,60	CSN-X-2668A
26U	800	800	1322	1162	703	750	123 - 573	91,62	CSN-X-2688A
32U	600	600	1588	1428	503	550	123 - 373	77,88	CSN-X-3266A
32U	600	800	1588	1428	503	750	123 - 573	88,01	CSN-X-3268A
32U	800	800	1588	1428	703	750	123 - 573	103,14	CSN-X-3288A
36U	600	600	1766	1723	503	550	123 - 373	84,17	CSN-X-3666A
36U	600	800	1766	1723	503	750	123 - 573	94,95	CSN-X-3668A
36U	800	800	1766	1723	703	750	123 - 573	109,81	CSN-X-3688A
39U	800	800	1900	1740	703	750	123 - 573	115,56	CSN-X-3988A
42U	600	600	2033	1873	503	550	123 - 373	93,62	CSN-X-4266A
42U	600	800	2033	1873	503	750	123 - 573	105,41	CSN-X-4268A
42U	600	1000	2033	1873	503	950	123 - 773	113,85	CSN-X-4260A
42U	800	800	2033	1873	703	750	123 - 573	121,31	CSN-X-4288A
42U	800	1000	2033	1873	703	950	123 - 773	133,54	CSN-X-4280A
47U	600	600	2255	2095	503	550	123 - 373	101,47	CSN-X-4766A
47U	600	800	2255	2095	503	750	123 - 573	114,09	CSN-X-4768A
47U	600	1000	2255	2095	503	950	123 - 773	123,20	CSN-X-4760A
47U	800	800	2255	2095	703	750	123 - 573	130,91	CSN-X-4788A
47U	800	1000	2255	2095	703	950	123 - 773	144,10	CSN-X-4780A

X (Color code): 7:RAL 7035 Light Grey, 9:RAL 9005 Black

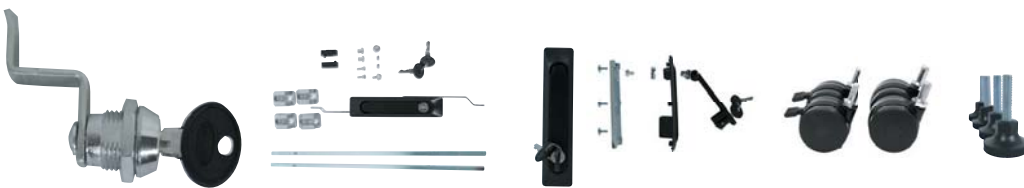
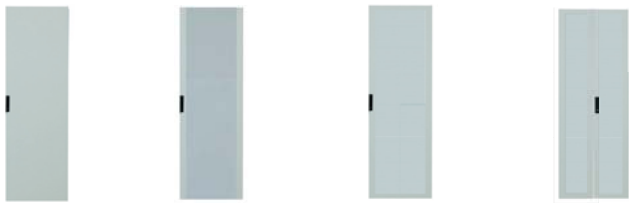
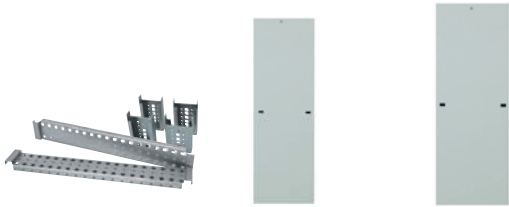

inorax-ST Cabinets

Components of inorax-ST

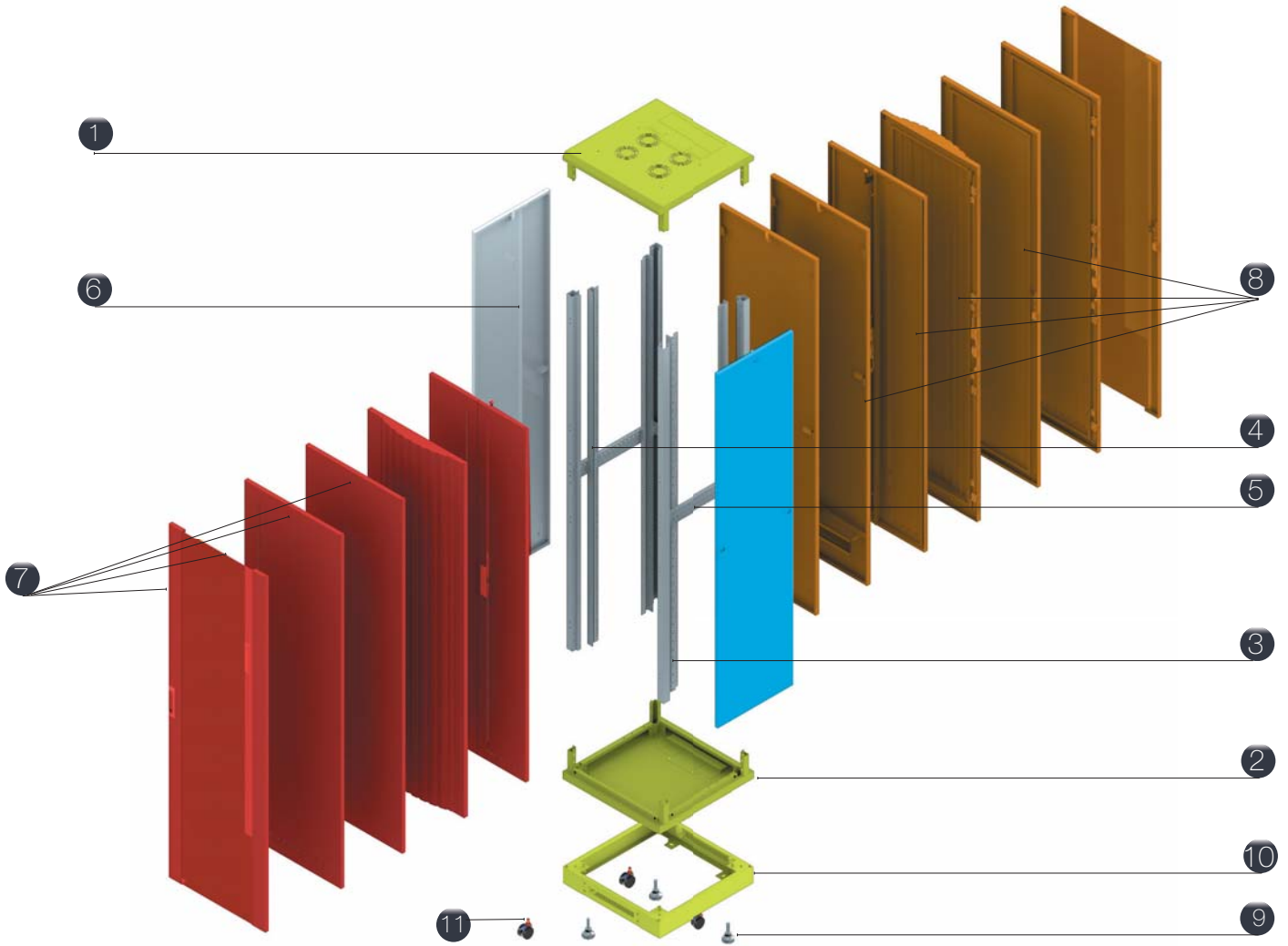

- 1- Top Cover
- 2 - Bottom Cover
- 3 - Vertical Profiles
- 4 - 19" Mounting Rails
- 5 - Side Support Rails
- 6 - Side Panel
- 7 - Front Door Options
- 8 - Rear Door Options

- 9 - Adjustable Feet
- 10 - Plinth
- 11 - Castor

inorax-ST Cabinets

Components of inorax-ST

Top Cover



Material 1.5 mm Steel **Finish** Electrostatic Powder Paint
Color RAL 7035 (Light Grey) and RAL 9005 (Black)

W (mm)	D (mm)	H (mm)	Weight kg	Part No
600	600	154	10,79	CSZ-X-YY660-0401
600	800	154	12,70	CSZ-X-YY680-0401
600	1000	154	14,62	CSZ-X-YY600-0401
600	1100	154	15,47	CSZ-X-YY610-0401
600	1200	154	16,42	CSZ-X-YY620-0401
800	800	154	16,76	CSZ-X-YY880-0401
800	1000	154	19,62	CSZ-X-YY800-0401
800	1100	154	20,95	CSZ-X-YY810-0401
800	1200	154	22,39	CSZ-X-YY820-0401

X : Color code = 7: RAL 7035 (Grey); 9: RAL 9005 (Black)

Bottom Cover



Material 1.5 mm Steel **Finish** Electrostatic Powder Paint
Color RAL 7035 (Light Grey) and RAL 9005 (Black)

W (mm)	D (mm)	H (mm)	Weight kg	Part No
600	600	154	11,16	CSZ-X-YY660-0403
600	800	154	13,07	CSZ-X-YY680-0403
600	1000	154	14,99	CSZ-X-YY600-0403
600	1100	154	15,94	CSZ-X-YY610-0403
600	1200	154	16,90	CSZ-X-YY620-0403
800	800	154	17,17	CSZ-X-YY880-0403
800	1000	154	20,04	CSZ-X-YY800-0403
800	1100	154	21,47	CSZ-X-YY810-0403
800	1200	154	22,91	CSZ-X-YY820-0403

X : Color code = 7: RAL 7035 (Grey); 9: RAL 9005 (Black)

Vertical Profiles



Material 1.5 mm Steel **Finish** Electrostatic Powder Paint
Color RAL 7035 (Light Grey) and RAL 9005 (Black)

H (U)	W (mm)	D (mm)	H (mm)	Weight kg	Part No
16U	48,5	57	754	1,36	CSZ-X-16YY0-0300
22U	48,5	57	1021	1,84	CSZ-X-22YY0-0300
26U	48,5	57	1199	2,17	CSZ-X-26YY0-0300
32U	48,5	57	1465	2,65	CSZ-X-32YY0-0300
36U	48,5	57	1643	2,97	CSZ-X-36YY0-0300
39U	48,5	57	1777	3,21	CSZ-X-39YY0-0300
42U	48,5	57	1910	3,46	CSZ-X-42YY0-0300
47U	48,5	57	2132	3,86	CSZ-X-47YY0-0300

X : Color code = 7: RAL 7035 (Grey); 9: RAL 9005 (Black)

19" Mounting Rails



Material 2 mm Steel **Finish** Zinc-Plated
Color Metal Grey

H (U)	W (mm)	D (mm)	H (mm)	Weight kg	Part No
16U	33	52	753	0,96	CSZ-0-16YY0-0600
22U	33	52	1020	1,29	CSZ-0-22YY0-0600
26U	33	52	1198	1,52	CSZ-0-26YY0-0600
32U	33	52	1464	1,85	CSZ-0-32YY0-0600
36U	33	52	1642	2,08	CSZ-0-36YY0-0600
39U	33	52	1776	2,25	CSZ-0-39YY0-0600
42U	33	52	1909	2,42	CSZ-0-42YY0-0600
47U	33	52	2131	2,70	CSZ-0-47YY0-0600

X : Color code = 7: RAL 7035 (Grey); 9: RAL 9005 (Black)

inorax-ST Cabinets

Side Support Rails

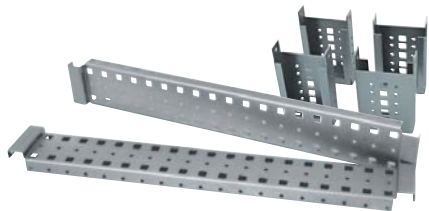

Material 2 mm Steel

Finish Zinc-Plated

Color Metal Grey

Cabinet W (mm)	Cabinet D (mm)	Weight kg	Part No
600	600	0,75	CSZ-0-YY660-0700
600	800	0,80	CSZ-0-YY680-0700
600	1000	0,85	CSZ-0-YY600-0700
600	1100	0,87	CSZ-0-YY610-0700
600	1200	0,90	CSZ-0-YY620-0700
800	800	0,85	CSZ-0-YY880-0700
800	1000	0,92	CSZ-0-YY800-0700
800	1100	0,97	CSZ-0-YY810-0700
800	1200	1,0 2	CSZ-0-YY820-0700

X : Color code = 7: RAL 7035 (Grey); 9: RAL 9005 (Black)

Side Panel

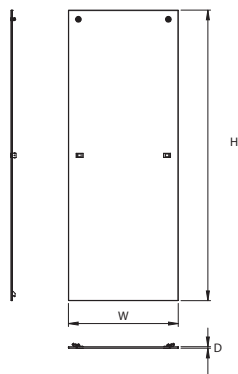

Material 1.5 mm Steel **Finish** Electrostatic Powder Paint

Color RAL 7035 (Light Grey) and RAL 9005 (Black)

H (U)	H (mm)	W (mm)	D (mm)	Weight kg	Part No
16U	749	600	22	600	CSZ-X-16Y60-0501
22U	1016	600	22	600	CSZ-X-22Y60-0501
22U	1016	800	22	800	CSZ-X-22Y80-0501
26U	1194	600	22	600	CSZ-X-26Y60-0501
26U	1194	800	22	800	CSZ-X-26Y80-0501
26U	1194	1000	22	1000	CSZ-X-26Y00-0501
32U	1460	600	22	600	CSZ-X-32Y60-0501
32U	1460	800	22	800	CSZ-X-32Y80-0501
36U	1638	600	22	600	CSZ-X-36Y60-0501
36U	1638	800	22	800	CSZ-X-36Y80-0501
36U	1638	1000	22	1000	CSZ-X-36Y00-0501
36U	1638	1200	22	1200	CSZ-X-36Y20-0501
39U	1772	800	22	800	CSZ-X-39Y80-0501
39U	1772	1000	22	1000	CSZ-X-39Y00-0501
42U	1905	600	22	600	CSZ-X-42Y60-0501
42U	1905	800	22	800	CSZ-X-42Y80-0501
42U	1905	1000	22	1000	CSZ-X-42Y00-0501
42U	1905	1100	22	1100	CSZ-X-42Y10-0501
42U	1905	1200	22	1200	CSZ-X-42Y20-0501
47U	2127	600	22	600	CSZ-X-47Y60-0501
47U	2127	800	22	800	CSZ-X-47Y80-0501
47U	2127	1000	22	1000	CSZ-X-47Y00-0501
47U	2127	1100	22	1100	CSZ-X-47Y10-0501
47U	2127	1200	22	1200	CSZ-X-47Y20-0501

X : Color code = 7: RAL 7035 (Grey); 9: RAL 9005 (Black)

Rear Metal Solid Panel

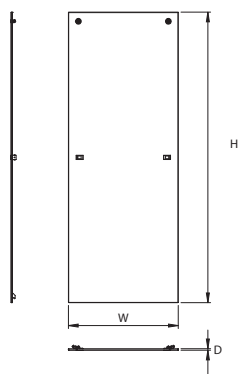

Material 1.5 mm Steel **Finish** Electrostatic Powder Paint

Color RAL 7035 (Light Grey) and RAL 9005 (Black)

H (U)	H (mm)	W (mm)	D (mm)	Weight kg	Part No
16U	752	600	23	5,11	CSZ-X-166Y0-0901
22U	1018	600	23	6,76	CSZ-X-226Y0-0901
22U	1018	800	23	8,79	CSZ-X-228Y0-0901
26U	1196	600	23	7,86	CSZ-X-266Y0-0901
26U	1196	800	23	10,22	CSZ-X-268Y0-0901
32U	1463	600	23	9,5	CSZ-X-326Y0-0901
32U	1463	800	23	12,37	CSZ-X-328Y0-0901
36U	1641	600	23	10,6	CSZ-X-366Y0-0901
36U	1641	800	23	13,80	CSZ-X-368Y0-0901
39U	1774	800	23	14,88	CSZ-X-398Y0-0901
42U	1907	600	23	12,25	CSZ-X-426Y0-0901
42U	1907	800	23	15,95	CSZ-X-428Y0-0901
47U	2130	600	23	13,62	CSZ-X-476Y0-0901
47U	2130	800	23	17,74	CSZ-X-478Y0-0901

X : Color code = 7: RAL 7035 (Grey); 9: RAL 9005 (Black)

inorax-ST Cabinets

Metal Solid Door

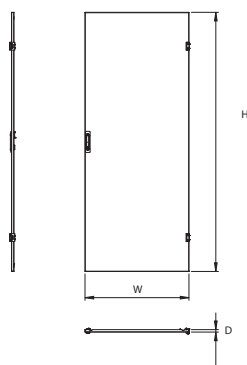

Material 1.2 mm Steel **Finish** Electrostatic Powder Paint

Color RAL 7035 (Light Grey) and RAL 9005 (Black)

H (U)	H (mm)	W (mm)	D (mm)	Weight kg	Part No
16U	749	600	22	6,87	CSZ-X-166Y0-0902
22U	1016	600	22	8,94	CSZ-X-226Y0-0902
22U	1016	800	22	11,26	CSZ-X-228Y0-0902
26U	1194	600	22	10,32	CSZ-X-266Y0-0902
26U	1194	800	22	12,97	CSZ-X-268Y0-0902
32U	1460	600	22	12,39	CSZ-X-326Y0-0902
32U	1460	800	22	15,54	CSZ-X-328Y0-0902
36U	1638	600	22	13,77	CSZ-X-366Y0-0902
36U	1638	800	22	17,26	CSZ-X-368Y0-0902
39U	1772	800	22	18,54	CSZ-X-398Y0-0902
42U	1905	600	22	15,84	CSZ-X-426Y0-0902
42U	1905	800	22	19,83	CSZ-X-428Y0-0902
47U	2127	600	22	17,56	CSZ-X-476Y0-0902
47U	2127	800	22	21,97	CSZ-X-478Y0-0902

X : Color code = 7: RAL 7035 (Grey); 9: RAL 9005 (Black)

Glass Door

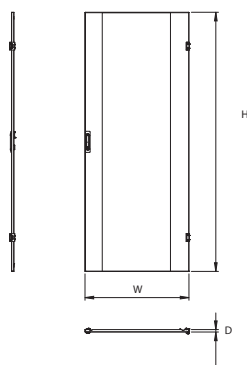

Material 1.2 mm Steel **Finish** Electrostatic Powder Paint

Color RAL 7035 (Light Grey) and RAL 9005 (Black)

H (U)	H (mm)	W (mm)	D (mm)	Weight kg	Part No
16U	749	600	22	5,53	CSZ-X-166Y0-0903
22U	1016	600	22	7,42	CSZ-X-226Y0-0903
22U	1016	800	22	9,77	CSZ-X-228Y0-0903
26U	1194	600	22	8,68	CSZ-X-266Y0-0903
26U	1194	800	22	11,42	CSZ-X-268Y0-0903
32U	1460	600	22	10,56	CSZ-X-326Y0-0903
32U	1460	800	22	13,9	CSZ-X-328Y0-0903
36U	1638	600	22	11,82	CSZ-X-366Y0-0903
36U	1638	800	22	15,55	CSZ-X-368Y0-0903
39U	1772	800	22	16,79	CSZ-X-398Y0-0903
42U	1905	600	22	13,7	CSZ-X-426Y0-0903
42U	1905	800	22	18,02	CSZ-X-428Y0-0903
47U	2127	600	22	15,27	CSZ-X-476Y0-0903
47U	2127	800	22	20,09	CSZ-X-478Y0-0903

X : Color code = 7: RAL 7035 (Grey); 9: RAL 9005 (Black)

Perforated Flat Door

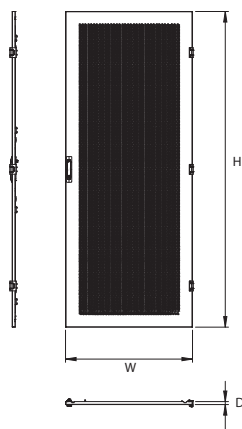

Material 1.2 mm Steel **Color** RAL 7035 (Light Grey) and RAL 9005 (Black)

Finish Electrostatic Powder Paint **Perforation Rate** 67%

H (U)	H (mm)	W (mm)	D (mm)	Weight kg	Part No
26U	1194	600	22	7,81	CSZ-X-266Y0-0904
36U	1638	600	22	10,15	CSZ-X-366Y0-0904
39U	1772	800	22	14,02	CSZ-X-398Y0-0904
42U	1905	600	22	11,80	CSZ-X-426Y0-0904
42U	1905	800	22	15,17	CSZ-X-428Y0-0904
47U	2127	600	22	12,97	CSZ-X-476Y0-0904
47U	2127	800	22	16,69	CSZ-X-478Y0-0904

X : Color code = 7: RAL 7035 (Grey); 9: RAL 9005 (Black)

Double Perforated Door

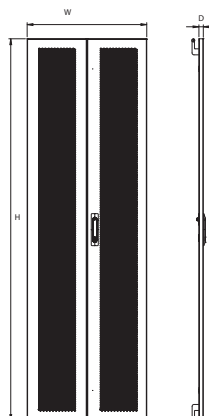

Material 1.2 mm Steel **Color** RAL 7035 (Light Grey) and RAL 9005 (Black)

Finish Electrostatic Powder Paint **Perforation Rate** 67%

H (U)	H (mm)	W (mm)	D (mm)	Weight kg	Part No
26U	1194	600	22	11,99	CSZ-X-266Y0-0908
36U	1638	600	22	15,70	CSZ-X-366Y0-0908
39U	1772	800	22	21,19	CSZ-X-398Y0-0908
42U	1905	600	22	18,16	CSZ-X-426Y0-0908
42U	1905	800	22	22,83	CSZ-X-428Y0-0908
47U	2127	600	22	20,01	CSZ-X-476Y0-0908
47U	2127	800	22	25,16	CSZ-X-478Y0-0908

X : Color code = 7: RAL 7035 (Grey); 9: RAL 9005 (Black)

inorax-ST Cabinets

High Perforation Rated Flat Door

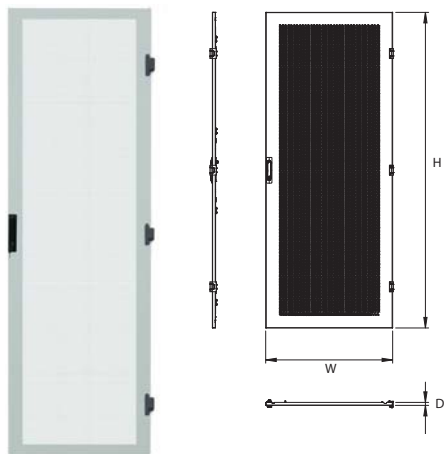

Material 1.2 mm Steel **Finish** Electrostatic Powder Paint
Perforation Rate 80% **Color** RAL 7035 (Light Grey) and RAL 9005 (Black)

H (U)	H (mm)	W (mm)	D (mm)	Weight kg	Part No
26U	1194	600	22	7,51	CSZ-X-266Y0-0909
36U	1638	600	22	9,85	CSZ-X-366Y0-0909
39U	1772	800	22	13,72	CSZ-X-398Y0-0909
42U	1905	600	22	11,50	CSZ-X-426Y0-0909
42U	1905	800	22	14,87	CSZ-X-428Y0-0909
47U	2127	600	22	12,67	CSZ-X-476Y0-0909
47U	2127	800	22	16,39	CSZ-X-478Y0-0909

X : Color code = 7: RAL 7035 (Grey); 9: RAL 9005 (Black)

High Perforation Rated Double Door

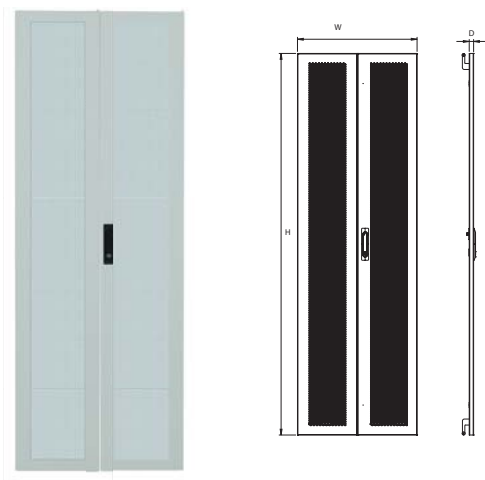

Material 1.2 mm Steel **Finish** Electrostatic Powder Paint
Perforation Rate 80% **Color** RAL 7035 (Light Grey) and RAL 9005 (Black)

H (U)	H (mm)	W (mm)	D (mm)	Weight kg	Part No
26U	1194	600	22	11,69	CSZ-X-266Y0-0911
36U	1638	600	22	15,40	CSZ-X-366Y0-0911
39U	1772	800	22	20,89	CSZ-X-398Y0-0911
42U	1905	600	22	17,86	CSZ-X-426Y0-0911
42U	1905	800	22	22,53	CSZ-X-428Y0-0911
47U	2127	600	22	19,71	CSZ-X-476Y0-0911
47U	2127	800	22	24,86	CSZ-X-478Y0-0911

X : Color code = 7: RAL 7035 (Grey); 9: RAL 9005 (Black)

Rear Metal Panel with Cable Entry

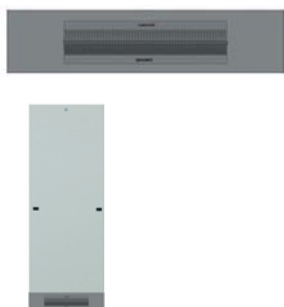

Material 1.5 mm Steel **Finish** Electrostatic Powder Paint
Color RAL 7035 (Light Grey) and RAL 9005 (Black)

H (U)	H (mm)	W (mm)	D (mm)	Weight kg	Part No
3U	133	600	23	0,97	CSZ-X-036Y0-0915
3U	133	800	23	1,35	CSZ-X-038Y0-0915
4U	178	600	23	1,24	CSZ-X-046Y0-0915
4U	178	800	23	1,71	CSZ-X-048Y0-0915
5U	222	600	23	1,52	CSZ-X-056Y0-0915
5U	222	800	23	2,06	CSZ-X-058Y0-0915
6U	267	600	23	1,79	CSZ-X-066Y0-0915
6U	267	800	23	2,42	CSZ-X-068Y0-0915

X : Color code = 7: RAL 7035 (Grey); 9: RAL 9005 (Black)

Adjustable Cable Entry Panel with EPDM Gasket



Material 1.2 mm Steel **Finish** Electrostatic Powder Paint
Color RAL 7035 (Light Grey) and RAL 9005 (Black)

H (mm)	W (mm)	D (mm)	Weight kg	Part No
20	350	152	0,53	CSZ-X-YYYY0-0803

X : Color code = 7: RAL 7035 (Grey); 9: RAL 9005 (Black)

inorax-ST Cabinets

Adjustable Feet

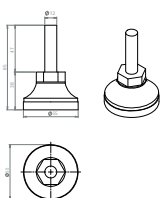

Material Steel and Plastic ABS **Finish** Zinc Plated
Packaging 4 pcs in a box

Maximum Static Load	Set Weight kg	Part No
600 kg / piece	0.35	CCA-0-7014

Multi Point Lock for Double Doors



Material Polyamide
Packaging 1 pc in a box
Part No CPZ-0-YYYY0-1005

Multi Point Lock for Single Perforated Door



Material Polyamide
Packaging 1 pc in a box
Part No CPZ-0-YYYY0-1004

Cylindrical Lock for Rear Metal Solid Panel

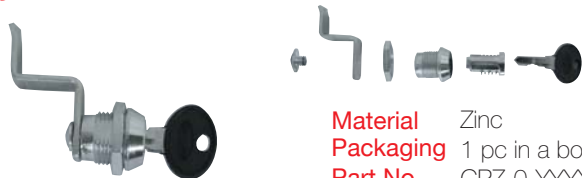

Material Zinc
Packaging 1 pc in a box
Part No CPZ-0-YYYY0-1002

Castor Set

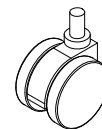
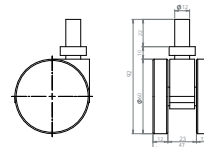

Material Steel and Plastic ABS **Finish** Zinc Plated
Packaging 2 pcs with stopper and 2 pcs without Stopper in a box

Maximum Static Load	Set Weight kg	Part No
250 kg / piece	0.77	CCA-0-7015

Single Point Lock



Material Polyamide
Packaging 1 pc in a box
Part No CPZ-0-YYYY0-1003

Cylindrical Lock for Side Panel

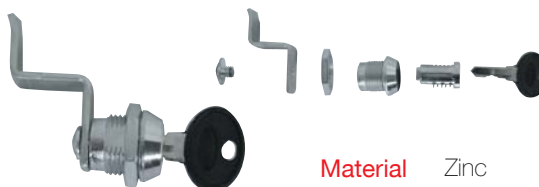

Material Zinc
Packaging 1 pc in a box
Part No CPZ-0-YYYY0-1001