

Specifications

Model	VLED23T7G
Pick-up Device	1/3" Sony Super HAD CCD
Effective Pixels (H×V)	NTSC:510×492, PAL:500×582
Sensing Area	4.9mm×3.7mm
Horizontal Resolution	480 TV Lines
Minimum Illumination	0.1 Lux, 0 Lux at IR on
S/N Ratio	More than 48dB
Scanning System	2:1 Interlace
Synchronous System	Internal
Electronic Shutter	1/50s(1/60s) 1/100,000s
IR Distance	65'
IR Leds	24 pcs Φ5 infrared LED
IR status	IR on: under 10Lux, by CDS auto control
Water Resistance	IP66
Gama Characteristic	0.45
Auto Gain Control	Auto
White Balance	Auto
Video Output	1.0Vp-p composite video, 75Ω
Lens	3.6mm
Power/Current	12VDC/ IR on: 300mA, IR off: 100mA
Operating Temperature	14F 122F
Storage Temperature	-4F 140F



VLED23T7G Series Color Camera

2.5" IR Turret Camera



Note:Before applying power to the camera, please read this UserGuide in detail.



* Sensor (CCD)

SONY 1/3" High Resolution CCD sensor.

* Auto Gain Control (AGC)

Built-in auto gain control (AGC) circuit. The color camera can get a high definition picture in low Lux condition.

* Auto Electronic Shutter (AES)

Built-in auto electronic shutter function. The AES speed can reach **1/100,000s**.

* Gamma Characteristic

Camera Gama characteristic is **0.45**.

* Night-time Vision

0 Lux with IR LED ON.

- The power supply must be regulated 12V supply.
- The operating temperature must be within camera's specifications.
- For better image quality, the cable length for power and video output should not be excessively long.

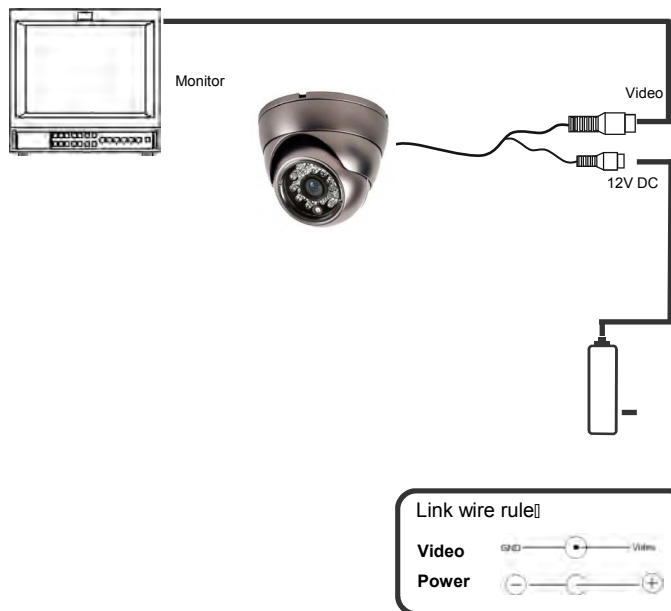

■ TROUBLESHOOTING

1. No picture after providing power

- . Check the power supply voltage, it may be outside specification.
- . Please check the connecting cables and monitors to determine if the camera is connected correctly or not.

2. The picture has flowing interference ripples

- . Check the ground of the monitor and other peripheral equipment that are being used is the same ground as the camera.

3. The background color continuously changes

- . A fluorescent bulb's electromagnetic field can cause a color roll. This is a proper phenomenon of the camera.
- . To improve the image, try to increase the distance between the camera and the bulb, or change the angle such that it doesn't face the florescent bulb.

■ INTRODUCTION

Congratulations on your purchase of this Speco product. This camera utilized the latest in SONY sensors and drivers. The most appealing characteristics of this camera are weather-resistance, day & night feature, and indoor & outdoor applications. This product is a great addition to your CCTV system.

Please read this manual carefully to ensure proper use of the product.



The symbol is intended to alert the user to the presence of important operating and maintenance (servicing) Instructions in the literature accompanying the appliance.



The symbol is intended to alert the user to the presence of uninsulated 'dangerous voltage' within the product's enclosure that may be of sufficient magnitude to constitute a risk of electric shock to persons.

	CAUTION: DO NOT OPEN	
CAUTION: TO REDUCE THE RISK OF ELECTRIC SHOCK		
DO NOT REMOVE COVER. NO USER SERVICEABLE PARTS INSIDE. REFER SERVICING		
CAUTION: To prevent electric shock and risk of fire hazards, do NOT use anything other than the specified power		

Installation Precautions:

- Do not install the camera to extreme temperature conditions. Only use the camera under conditions where temperature is between 14f and 122f.
- Never keep the camera pointed directly at the sun or a bright object.
- Do not mount the camera near a radiator or heater.