

# Installation Guide

## CM00TB / CM00TW

**speco technologies®**  
200 New Highway, Amityville NY 11701  
800.645.5516 / [www.specotech.com](http://www.specotech.com)

### Clip Mount Bracket

#### Compatible Models

- CVC61HRB, CVC61HRW
- CVC62HRB, CVC62HRW
- CVC71HRB, CVC71HRW
- CILT00T6B, CILT00T6W
- CVC61iLTB, CVC61iLTW
- CVC62iLTB, CVC62iLTW

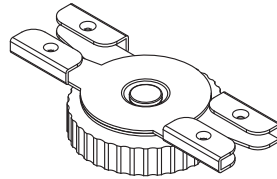

#### Package Contents

The following items are included in this package.

- CM00TB / CM00TW
- 3 Machine Screws M3 x 6

#### Dimensions

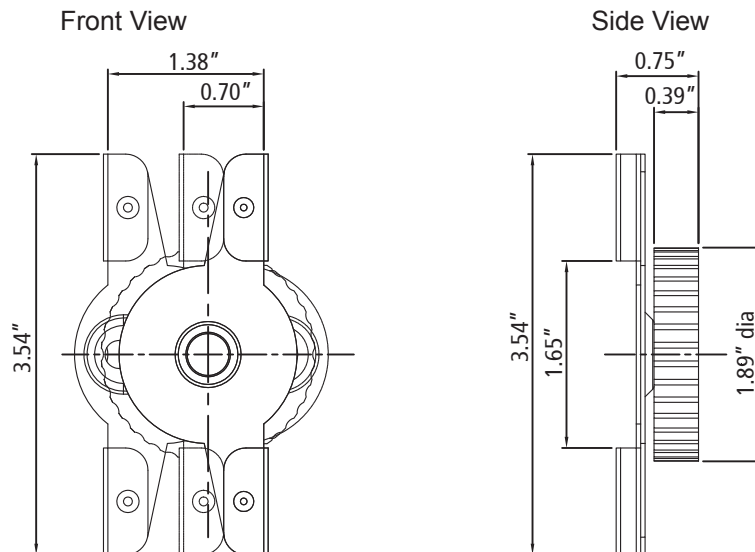

#### Installation Instruction Diagram

1. Loosen the bracket by turning the base of the bracket anti-clockwise.
2. Install bracket onto the ceiling tile and turn base of the bracket clockwise to tighten.

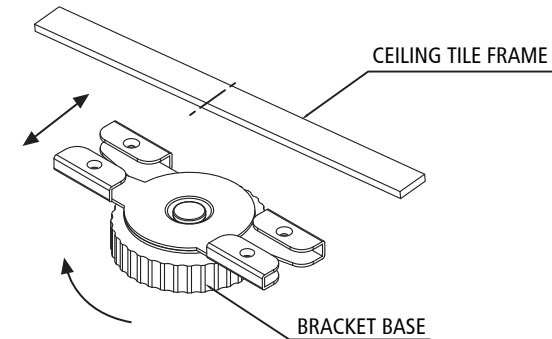

3. Arrange each piece as shown in the diagram below.
4. Fasten the camera onto the mount by using the screws provided.

