

Model 1075-CCOAP

Suspended Ceiling Tile Insert Enclosure for WAPs

The Model 1075-CCOAP wireless LAN access point mounting solution is a locking ceiling tile insert designed specifically to secure Cisco wireless access points while satisfying UL criteria for heat and visible smoke release in air-handling spaces. This aesthetic, white powder-coated all steel enclosure has a bracket in the door to which the access point is attached. When the door is closed, the access point is locked in place and the enclosure preserves the UL criteria. Installation requires a square opening to be cut into the ceiling tile or hard ceiling. The enclosure is supported by two backside tile bridges, and hanger wires attached to the building ceiling structural support. The door is interchangeable for new doors specific to different manufacturers' access points and antennas.



Model 1075-CCOAP shown with Cisco 3500i wireless access point (not included)

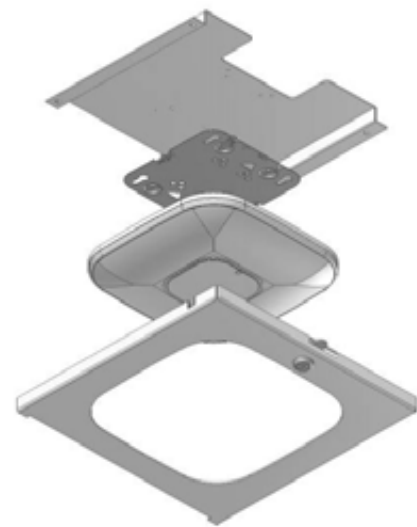

Features

- Locking ceiling tile insert telecommunications enclosure designed specifically to secure for Cisco wireless access points and other wireless components from most vendors. 15" x 15" bezel
- UL Listed and designed to meet NEC300-22 and 300-23 for plenum installations
- Fully hinged locking door, keyed alike
- Shallow back box (3") simplifies installation in walls and ceilings
- Interchangeable doors permit simple migration to new access points and antennas
- Enclosure back box is effective dust barrier to simplify ICRA compliance in hospitals
- Maximum weight to be installed in the unit is 25 lbs.



Specifications

- Use Cisco AIR-AP-BRACKET-1 for Cisco 1140/3500 series APs. Use Cisco AIR-AP-BRACKET-2 and included mounting plate standoffs for Cisco 3600/3700 series APs
- Back-box is 16 ga. aluminum; door and flange are textured, white powder-coated steel. RoHS compliant
- Size: Bezel is 15" x 15", back-box is 12 3/4" x 12 3/4" x 3" deep
- Knockouts for AC receptacle, (2) keystone jacks, (2) 3/4" trade conduit connector
- Maximum weight to be installed inside the unit is 25 lbs.
- De-rate upper operating temperature limit from +50°C to +40°C when AP in the enclosure
- Enclosure must be supported by the tile bridges. When installed in the ceiling, enclosure must be supported by the building structure, independent of the suspended ceiling

Includes

- (1) Unit Per Carton
- (2) Tile Bridge
- (1) Cable Egress Fire Stop Kit (1/2" trade size conduit connector, and fire block foam insert)
- (4) Access Point Mounting Screw
- (1) Access Point Mounting Plate
- (4) 1/2" Standoff
- (4) Hanger Wire
- (2) Key For Lock
- Installation Instructions
- Shipping weight: 13 lbs.

Model 1075 Configurations

Interchangeable doors allow the 107X Series ceiling enclosure to be customized to different vendor's product.

MODEL NUMBER	DESIGNED FOR	DESCRIPTION
1075-CP	Apple TV, other digital gateways, or wireless APs	Clear polycarbonate dome in door passes wireless and IR signal, digital gateway inside
1075-WA	Wireless APs	Opaque White ABS dome in door passes wireless signal, AP inside
1075-CCOAP	Cisco Access Points	Cisco AP is locked into door, fully exposing front of AP
1075-AN-AP135	Aruba Networks AP	Aruba Networks AP-135 is locked into door, exposing front of AP
1075-00	External antennas	External antennas mount on door, AP inside. MUST use Oberon 35-BLKHD-KIT, 34-ZDUAL antennas, or ceiling mount antennas

Accessories

- P/N 35-CBXJ2WH-A surface mount modular receptacle to terminate horizontal cable in the enclosure

Customer Print and Installation Instructions

Visit www.oberonwireless.com

Rev. 01/30/2014