

Wall/Ceiling Mount Bracket User's Manual

Usage Cautions and Warnings

Thank you for purchasing our product. Please read through the User Manual prior to use.

- Please read through the safety-related contents and usage instructions before use.
- Abide strictly by the warnings and usage instructions that require user caution, and always follow the operation methods and instructions.
- Installation must be performed by a trained specialist.
- The mounting has to be installed onto a firm and stable location where all the parts may be completely secured.
- The installation needs to be performed by a trained and experienced professional.
- Do not use the product for other purposes.

Product Characteristics

This product has been designed to be used in the installation of vandal dome cameras. The product is strong and corrosion-free since it is fabricated using aluminum alloy material. Various installation environments are supported for dynamic use.

Prior To Use

Avoid installing the mounting onto an unstable structure such as a gypsum wall panel. Install the mounting onto a strong structure such as a concrete wall, steel beam, etc. Use concrete screws with plugs or other installation tools when installing the mounting onto a concrete structure. Make sure that all the screw parts are metallic. (Avoid screwing too close to the edge of a piece of wood when screwing into a wooden structure)

02DWM1 | Installation Method

- ① Insert the cable onto the mount and attach it on the wall.

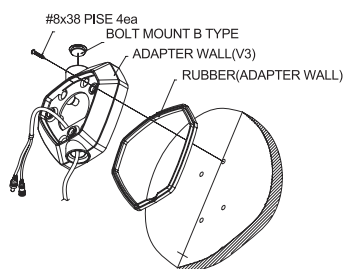

- ② Assemble the dome-camera installation mount and insert the cable into the mount

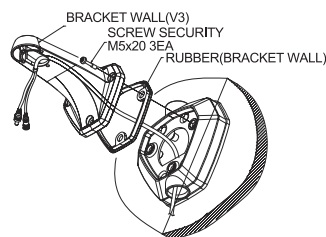

- ③ Insert the cable into the assembled mount, arrange the cable properly, fix it with screws and attach the mount onto the wall.

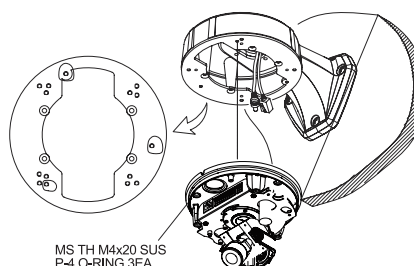
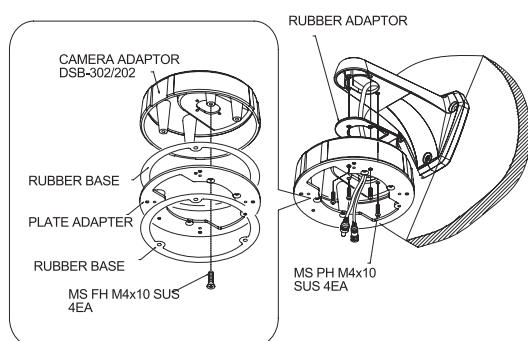

- ④ Connect the vandal dome camera.
(Connect the cable in the Vandal dome camera and assemble the camera base with the camera adaptor as above picture.)

02DWM1 | Installation Method

