

MNTZ36PP Parapet Mount Bracket User's Manual

Compatible with Digimerge Camera Models: DPZ36W023 / DPZ36W030

Usage Cautions and Warnings

Please read through the User Manual and all safety instructions prior to use.

- All the safety and operating instructions should be read before installing. Follow all operating instructions.
- Installation must be performed by a trained professional.
- Do not use the product with cameras other than the recommended models.
- The mounting has to be installed onto a firm and stable location that can support the weight of the camera and mount. Ensure all parts are completely secured.
- Do not use the product for other purposes.

Product Characteristics

This product has been designed to be used in the installation of speed dome cameras. This product has been fabricated using strong, corrosion-free aluminum alloy material.

Prior To Installation

Avoid installing the mounting onto an unstable structure such as a gypsum wall panel. Install the mounting onto a strong structure such as a concrete wall, steel beam, etc. Use concrete screws with plugs or other installation tools when installing the mount onto a concrete structure. Make sure that all the screw parts are metallic.

Avoid screwing too close to the edge of a piece of wood when screwing into a wooden structure.

Installation

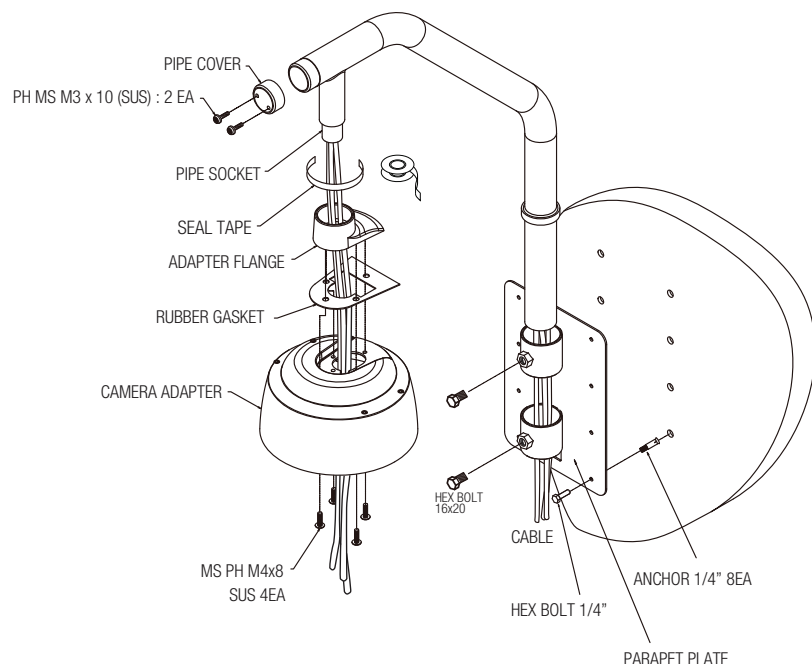

- ① Drill a hole in the surface for the cables and run the cables through the cable hole.
- ② Drill 8 anchor holes in the surface according to the hole pattern in the parapet plate.
- ③ Insert the anchors (8ea). Run the cable through the parapet plate and use the 1/4" hex bolts (8ea) to fasten the parapet plate to the surface.
- ④ Feed the cable through the pipe and set the pipe on the parapet plate using the 16x20 hex bolts (2ea).
- ⑤ Feed the cable down through the pipe socket. Wrap seal tape around the pipe socket.
- ⑥ Attach the pipe cover to the pipe using the PH M3x10 screws (2ea).
- ⑦ Insert the rubber gasket between the camera adapter and the adapter flange and connect the adapter flange to the camera adapter using the PH M4x8 screws (4ea). Run the cables through the camera adapter assembly, and screw the camera adapter assembly onto the pipe socket.
- ⑧ Install the camera into the camera adapter (see instructions on back of sheet).

NOTE: Camera installation requires the M4x12 mounting screws supplied with the camera. Make sure the o-rings are attached to the mounting screws and dome cover torx screws to prevent water ingress.

Description

- Aluminum & Steel body
- Unit : 5.8Kg
- Maximum load : 20Kg

Dimensions

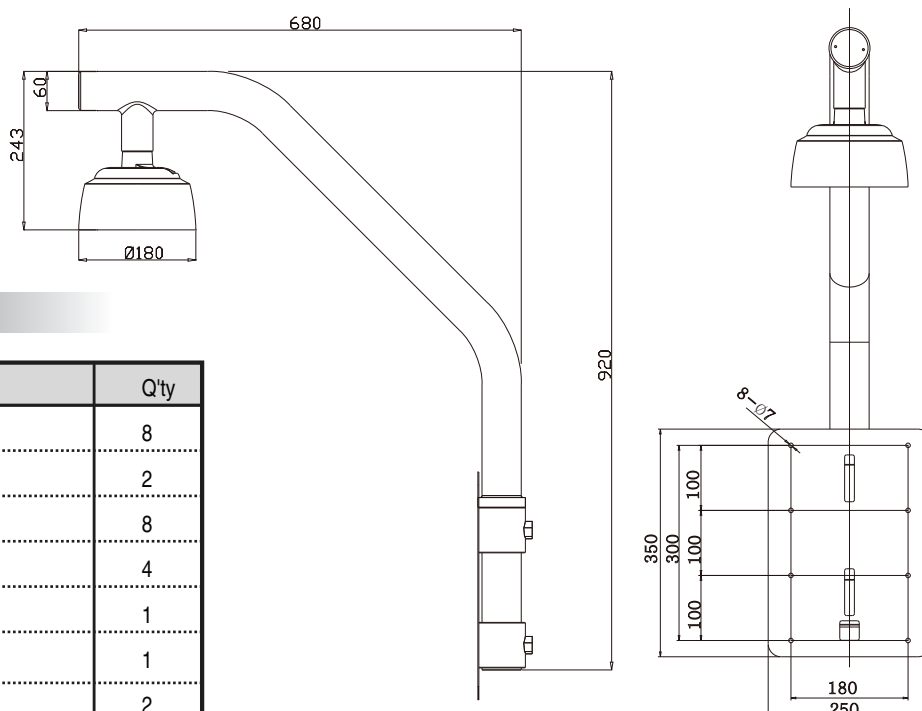

Accessories

No	Part Name	Q'ty
1	HEX BOLT 1/4" (PARAPET)	8
2	HEX BOLT 16x20 (SUS)	2
3	ANCHOR 1/4" (SUS)	8
4	SCREW PH M4x8 (SUS)	4
5	RUBBER GASKET (SILICON)	1
6	SEAL TAPE (12mm)	1
7	PH MS M3x10(SUS)	2

MNTZ36PP Parapet Mount Bracket User's Manual

ATTENTION: Make sure the o-rings are attached to the mounting screws and dome cover torx screws to prevent water ingress.

Installing the camera into the camera adapter:

- ① Connect the cables inside the camera adapter.
- ② Loosen the dome cover torx screws (3ea) and remove the dome cover from the camera base.
- ③ Mount the camera base to the #1 holes in the camera adapter using the M4x12 screws (4ea) supplied with the camera with o-rings attached.
- ④ Attach the dome cover to the camera base using the dome cover torx screws (3ea) with o-rings attached.

