

## QuickPort® Compression F-Connector

### APPLICATION

Leviton's Compression F-Connector is used in video applications such as CATV and satellite. Its radial compression design provides a more secure termination on Series 6 Quad Shield Cable than the traditional hex crimp design. Terminate using Leviton's installer-friendly Master Compression Tool.

### STANDARDS COMPLIANCE

Meets or exceeds all applicable standards: UL listed components; ACA/A-Tick Approved.

### PHYSICAL SPECIFICATIONS

<b>Materials:</b>	
QuickPort Body:	White
Connector:	Brass and Nickel Finish
<b>Mechanical Requirements:</b>	<b>Limits:</b>
Corrosion Resistant	Conforming Materials
Cable Application	<20 lbs max insertion
Equipment Interface	>10 matings without damage
Pull Force	>40 lbs
<b>Electrical Requirements:</b>	<b>Limits:</b>
Insulation Resistance	>5000 M @ 100VDC
Dielectric Strength	<1 KVAC for 1 minute
Return Loss	>30 dB to 1GHz
Shielding Effectiveness	>70 dB to 1 GHz

### DESIGN CONSIDERATIONS

- Use Leviton's Master Compression Tool to terminate Series 6 Quad Shield Cable.
- Designed to fit any QuickPort Housing.

See ELECTRONIC FILES for CAD files (.DXF, .DWG, MS-DOS.EPS) on disk



### WARRANTY INFORMATION

For a copy of Leviton product warranties, log on to [www.levitonvoicedata.com/warranty](http://www.levitonvoicedata.com/warranty).

For ELECTRONIC Typical Specs see (.TXT) file on disk.

### TYPICAL SPECIFICATION

The QuickPort Compression F-Connector shall be constructed with brass and a nickel finish. It shall feature a radial compression design, providing 360° electrical continuity. The connector shall be able to withstand greater than 40 lbs pull force. Its return loss shall be greater than 30dB to 1GHz. The QuickPort Compression F-Connector shall have a shielding effectiveness greater than 95dB to 300MHz and 70dB to 1GHz.

QuickPort® Compression F-Connector



For Technical Support Call 1-425-485-4288; in USA call 1-800-824-3005.  
Spec sheets and updates are also available at [www.levitonvoicedata.com](http://www.levitonvoicedata.com).

2222 - 222nd St. SE • Bothell, WA 98021 USA  
Tel: 1-800-722-2082 / 1-425-485-4288 • Fax: 1-425-483-5270 • Int'l Fax: 1-425-485-9170 • GSA Schedule Available.



# QuickPort® Compression F-Connector

**Part Number**  
**40782-CPF**

.....

## DIMENSIONAL LINE ART

See ELECTRONIC FILES for CAD images  
(.DXF, .DWG, MS-DOS.EPS)

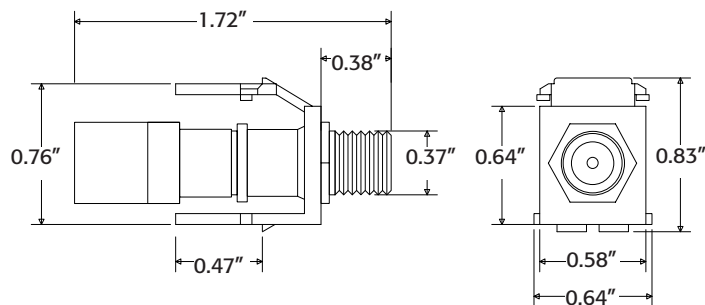

Side View

Front View

## PART NUMBERS

<i><b>Description</b></i>	<i><b>Part No.</b></i>
QuickPort Compression F-Connector	40782-CPF



For Technical Support Call 1-425-485-4288; in USA call 1-800-824-3005.  
Spec sheets and updates are also available at [www.levitonvoicedata.com](http://www.levitonvoicedata.com).



2222 - 222nd St. SE • Bothell, WA 98021 USA • Tel: 1-800-722-2082 / 1-425-485-4288 • Fax: 1-425-483-5270 • Int'l Fax: 1-425-485-9170 • GSA Schedule Available.