

## GigaMax® CAT 5e Connector

### APPLICATION

Modular connector for Category 5e UTP structured cabling systems. Uses include high megabit applications such as Gigabit Ethernet.



### SPECIFICATION

The modular connector shall meet or exceed the requirements for Category 5e described in the ANSI/TIA-568-C.2 specifications. The connectors shall also be in compliance with all National Electrical Codes; compliant with TIA-1096; UL listed; and independently UL Certified. In addition to Category 5e compliance, the connector shall have the ability to support high megabit and shared-sheath applications. All plastics used in construction of the connector bodies shall be fire-retardant with a UL flammability rating of 94V-0. Termination of all connectors shall be 110-type IDC with solder-plated phosphor bronze contacts. The connector shall provide a ledge directly adjacent to the 110-style termination against which the wires can be directly terminated and cut in one action by the installer. Connector wiring label shall provide installation color codes for both T568A and T568B wiring schemes. The modular hardware shall fit all other installed telecommunications wallplates, outlets and field-configurable patch panels and patch blocks.

### FEATURES

- Available in 13 different colors
- Dual wiring code label allows connector to be wired to either T568A or T568B
- Individual port configurability allows specification flexibility
- Robust one-piece lead-frame design
- Narrow connector allows high port density in a small area
- Performance supports high megabit and shared-sheath applications
- Available individually and in bulk packages of 25

### DESIGN CONSIDERATIONS

- Use in any QuickPort® housing to support GigaMax (Category 5e) UTP connectivity in surface mount, flush-mount, or modular furniture outlets, or patch panels and patch blocks
- Can be used in conjunction with other QuickPort snap-in modules for voice/data and video applications over UTP, coax and fiber
- To ID ports, use different colored modules for each application

### STANDARDS COMPLIANCE

- ANSI/TIA-568-C.2
- cULus listed
- TIA-1096-A

### PHYSICAL SPECIFICATIONS

Dimensions: See page 2  
Materials: Connector body is high-impact, fire-retardant plastic rated UL 94V-0.

### COUNTRY OF ORIGIN

United States of America

### WARRANTY INFORMATION

For a copy of Leviton product warranties, visit [www.leviton.com/warranty](http://www.leviton.com/warranty).

**ELECTRONIC FILES**

For CAD files, typical specs, or technical drawings (.DXF, .DWG), visit [www.leviton.com](http://www.leviton.com).

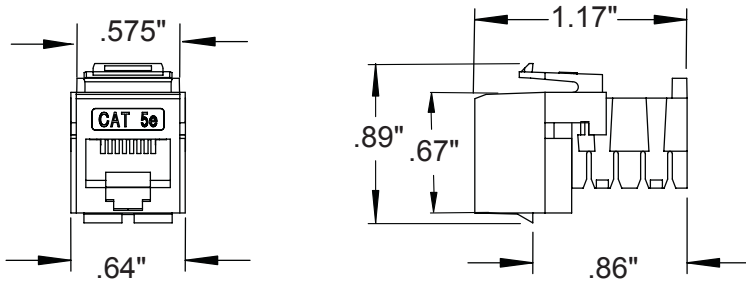

**5G108-XX5**

**PART NUMBERS**

Description	Part No.
GigaMax® 5e Connector, Ivory	5G108-RI5
GigaMax 5e Connector, White	5G108-RW5
GigaMax 5e Connector, Grey	5G108-RG5
GigaMax 5e Connector, Black	5G108-RE5
GigaMax 5e Connector, Orange	5G108-RO5
GigaMax 5e Connector, Blue	5G108-RL5
GigaMax 5e Connector, Crimson Red	5G108-RC5
GigaMax 5e Connector, Yellow	5G108-RY5
GigaMax 5e Connector, Green	5G108-RV5
GigaMax 5e Connector, Purple	5G108-RP5
GigaMax 5e Connector, Light Almond	5G108-RT5
GigaMax 5e Connector, Brown	5G108-RB5
GigaMax 5e Connector, Dark Red	5G108-RR5
GigaMax 5e Connector, Bulk Package of 25	5G108-B*5

\* = Color Choices: Ivory (I), White (W), Grey (G), Black (E), Orange (O), Blue (L), Crimson Red (C), Yellow (Y), Green (V), Purple (P), Light Almond (A), Brown (B), Dark Red (R).



<b>Leviton Network Solutions</b> 2222 - 222nd St. SE Bothell, WA 98021-4416  tel 1-800-824-3005 tel +1-425-486-2222 <a href="mailto:appeng@leviton.com">appeng@leviton.com</a> <a href="http://www.leviton.com">www.leviton.com</a>	<b>Asia / Pacific</b> T +1.631.812.6228 E <a href="mailto:infoasean@leviton.com">infoasean@leviton.com</a>	<b>Canada</b> T +1.514.954.1840 E <a href="mailto:pcservice@leviton.com">pcservice@leviton.com</a>	<b>Caribbean</b> T +1.954.593.1896 E <a href="mailto:infocaribbean@leviton.com">infocaribbean@leviton.com</a>	<b>China</b> T +852.2774.9876 E <a href="mailto:infochina@leviton.com">infochina@leviton.com</a>	<b>Colombia</b> T +57.1.743.6045 E <a href="mailto:infocolombia@leviton.com">infocolombia@leviton.com</a>
	<b>Europe</b> T +33.6.8869.1380 E <a href="mailto:infoeurope@leviton.com">infoeurope@leviton.com</a>	<b>India / SAARC</b> T +91.80.4322.5678 E <a href="mailto:infoindia@leviton.com">infoindia@leviton.com</a>	<b>Mexico</b> T +52.55.5082.1040 E <a href="mailto:Isamarketing@leviton.com">Isamarketing@leviton.com</a>	<b>Middle East &amp; Africa</b> T +971.4.886.4722 E <a href="mailto:lmeinfo@leviton.com">lmeinfo@leviton.com</a>	<b>South Korea</b> T +82.2.3273.9963 E <a href="mailto:infokorea@leviton.com">infokorea@leviton.com</a>