

110-Style Crossconnect Products Wall Rack-Mount Horizontal Cord Managers

APPLICATION

Place in between wall-mount 110 wiring bases or rack-mount wiring panels for routing, organizing and managing patch cords.

STANDARDS COMPLIANCE

Complies with TIA/EIA-568-B and TIA/EIA-606. UL listed.

PHYSICAL SPECIFICATIONS

Dimensions: Without legs: 1.73"H x 8.46"W x 2.52"D
With legs: 1.8"H x 10.72"W x 4.37"D
Rack-Mount: 1.73"H x 19"W x 2.87"D
Material: Made of fire-retardant plastic rated UL 94V-0.
Panel backs plates are made of black painted 16 gauge steel.

DESIGN CONSIDERATIONS

- Use where space limitations and low cost are a concern.
- Available with or without standoff legs.
- Mount directly on wall or backboard, or onto 300 pair mounting-frame basic or extension units.
- Position cord managers between 110 wiring bases.
- Mount on 19" distribution frame on hinged wall-mount bracket.

WARRANTY INFORMATION

For a copy of Leviton product warranties, log on to www.levitonvoicedata.com/warranty.

See ELECTRONIC FILES for CAD files (.DXF, .DWG, MS-DOS.EPS) on disk

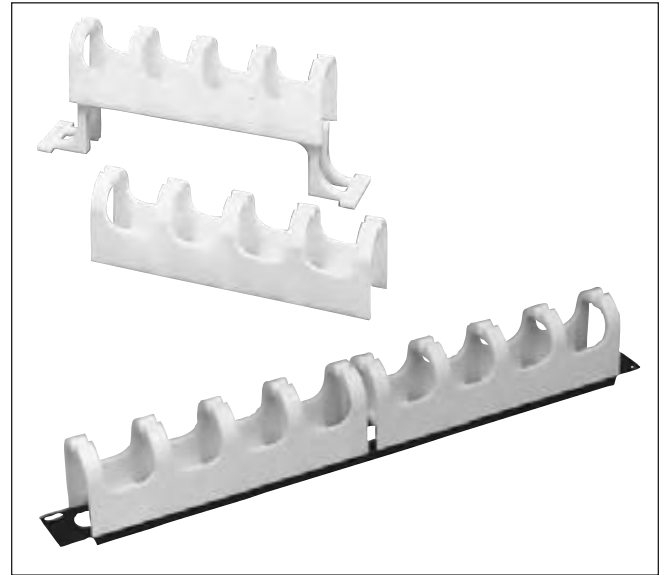

For ELECTRONIC Typical Specs see (.TXT) file on disk.

TYPICAL SPECIFICATION

The horizontal 110 cord managers shall mount to a wall or backboard, or onto 300 pair mounting-frame basic or extension units, providing the capability to organize and contain patch cords. The cord managers shall comply with TIA/EIA-568-B and TIA/EIA-606 requirements, be UL listed, and be made of fire-retardant plastic rated UL 94V-0.



For Technical Support Call 1-425-485-4288; in USA call 1-800-824-3005.
Spec sheets and updates are also available at www.levitonvoicedata.com.

2222 - 222nd St. SE • Bothell, WA 98021 USA
Tel: 1-800-722-2082 / 1-425-485-4288 • Fax: 1-425-483-5270 • Int'l Fax: 1-425-485-9170 • GSA Schedule Available



110 Style Crossconnect Products

Part Numbers
41D10-HCM 41D1R-HCM
41A10-HCM

DIMENSIONAL LINE ART

See ELECTRONIC FILES for CAD files
 (.DXF, .DWG, MS-DOS.EPS) on disk

Horizontal Cord Manager with legs 41A10-HCM

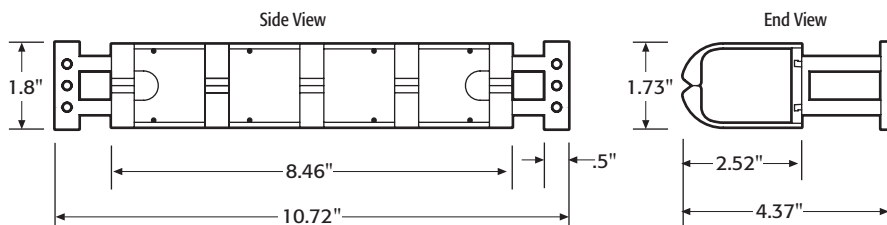

Horizontal Cord Manager without legs 41D10-HCM

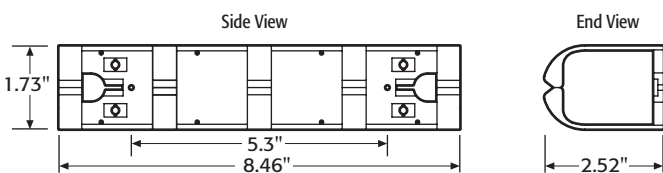

Rack-Mount Horizontal Manager 41D1R-HCM

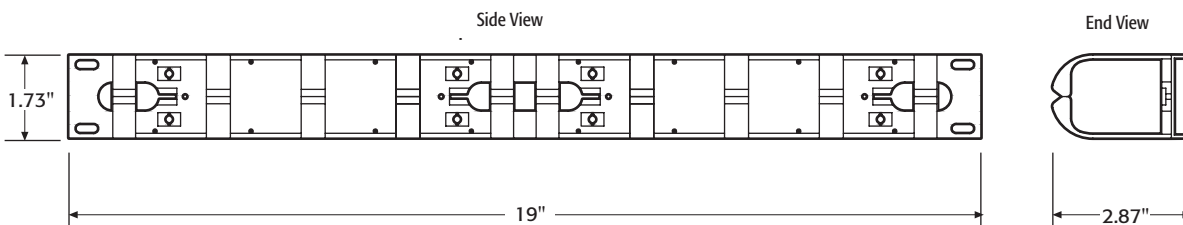

PART NUMBERS

| Description | Part Number |
|--------------------------------------|-------------|
| Horizontal Cord Manager without legs | 41D10-HCM |
| Horizontal Cord Manager with legs | 41A10-HCM |
| Rack Mount Horizontal Manager | 41D1R-HCM |



For Technical Support Call 1-425-485-4288; in USA call 1-800-824-3005.
 Spec sheets and updates are also available at www.levitonvoicedata.com.



2222 - 222nd St. SE • Bothell, WA 98021 USA • Tel: 1-800-722-2082 / 1-425-485-4288 • Fax: 1-425-483-5270 • Int'l Fax: 1-425-485-9170 • GSA Schedule Available