

RCA 110-Type QuickPort® Connector

APPLICATION

Leviton's RCA 110-Type QuickPort® Connector is designed to locally distribute baseband audio/video signals at distances of 10 to 40 feet over UTP cabling. Featuring standard IDC slots for quick and easy terminations, these connectors are compatible with a variety of patch panels, QuickPort and MOS wallplates, including flush and surface-mount styles.

FEATURES

- Connectors fit all QuickPort wallplate housings, patch panels and patch blocks
- 110 punchdown tool for use with category rated UTP cable
- Oversize connector diameter and depth readily accommodate larger "high-end" audio/video plugs (male)
- Gold-plated/wash connector for increased durability
- Connector supports connectivity for up to two pairs - use both pairs to reduce wire losses in longer cable runs
- The body is available in five colors; the insert is available in four colors for application identification

STANDARDS COMPLIANCE

Meets or exceeds all applicable standards: cULus Listed.

PHYSICAL SPECIFICATIONS

Dimensions: See page 2
Materials: Snap-in connector bodies are high-impact, fire-retardant plastic rated UL 94V-0
Body Colors: Ivory, white, almond, grey, and black
Barrel Colors: Orange, red, white, yellow, blue, and green

DESIGN CONSIDERATIONS

- RCA QuickPort Connectors snap into any housing with the QuickPort name, including: flush and surface mount outlets, Multimedia Outlet System, patch panels, and patch blocks
- Secure connectors to cable prior to snapping into faceplate or surface mount housing
- Use separate cables for analog and digital signals
- Use with Category 5e or better cabling
- Check clearance behind proposed location of module, to ensure space for proper bend-radius of cabling media
- RCA connector inserts are available in orange (PCM Audio), red (Right Audio), white (Left Audio) and yellow (Video)
- Use red, blue, and green connectors for component video applications
- The connector housing is available in ivory, white, almond, grey and black, to match housing or wallplates



WARRANTY INFORMATION

For a copy of Leviton product warranties, log on to www.leviton.com.

TYPICAL SPECIFICATION

Connectors shall snap into any housing with the QuickPort name, including: flush and surface mount outlets, Multimedia Outlet System, patch panels and patch blocks. Connector shall have oversized diameter and depth to accommodate larger, "high-end" audio/video male plugs. The connector housing shall be available in ivory, white, almond, grey and black. The insert shall be available in orange, red, white, yellow, blue, and green. Connectors shall be UL listed. All plastics used in construction of the module bodies shall be fire-retardant with a UL flammability rating of 94V-0.

RCA 110-Type QuickPort Connector



For Technical Support Call 1-425-485-4288; in USA call 1-800-824-3005.
Spec sheets and updates are also available at www.leviton.com.

2222 - 222nd St. SE • Bothell, WA 98021 USA
Tel: 1-800-722-2082 / 1-425-485-4288 • Fax: 1-425-483-5270 • Int'l Fax: 1-425-485-9170 • GSA Schedule Available.



RCA 110-Type QuickPort® Connector

Part Number
40735-Rxx

.....

DIMENSIONAL LINE ART

See ELECTRONIC FILES for CAD images
(.DXF, .DWG, MS-DOS.EPS)

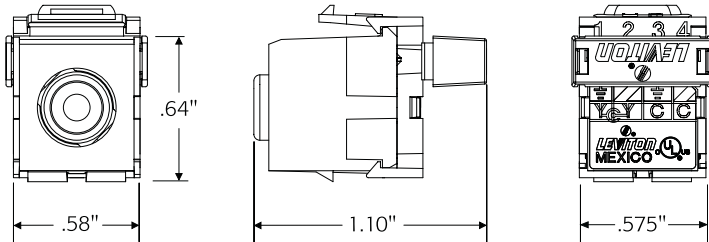

PART NUMBERS

Description	Part No.
RCA 110-Type QuickPort Connector	40735-R*†

*= Insert Color Choices: Orange (O), Red (R), White (W), Yellow (Y), Blue (L), Green (V)

†= Housing Color Choices: Ivory (I), White (W), Almond (A), Grey (G), Black (E)

NOTE: Inserts of Green and Blue are available with housings of White and Ivory

For Technical Support Call 1-425-485-4288; in USA call 1-800-824-3005.
Spec sheets and updates are also available at www.leviton.com.



2222 – 222nd St. SE • Bothell, WA 98021 USA • Tel: 1-800-722-2082 / 1-425-485-4288 • Fax: 1-425-483-5270 • Int'l Fax: 1-425-485-9170 • GSA Schedule Available.

