

MNTV2XB - Junction Box Mount

(See step 4 on reverse for compatibility with Digimerge cameras and accessories)

CONTENTS

- 1 x Junction Box (IP66)
- 1 x Mounting Template
- 4 x Junction Box Mounting Screws (PWA4x30)
- 4 x Rubber Mounting Screw O-Rings
- 5 x Cover Screws (Silver PM4x8)
- 4 x Short Camera/Accessory Mounting Screws (PM4x8)
- 4 x Long Camera/Accessory Mounting Screws (PM4x14)
- 1 x Conduit Key
- 2 x Cable Holders

DIMENSIONS

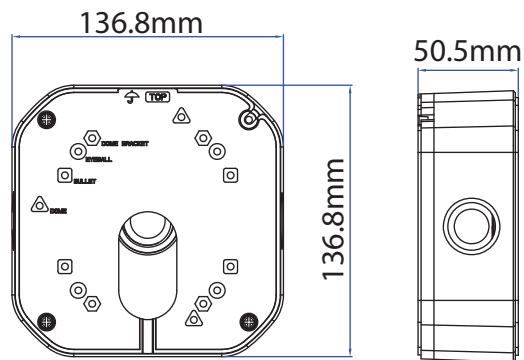

Weight: 0.8kg / 1.76lb

PARTS OVERVIEW

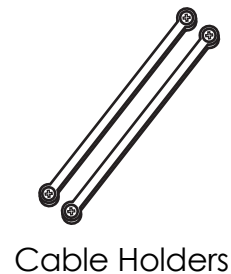
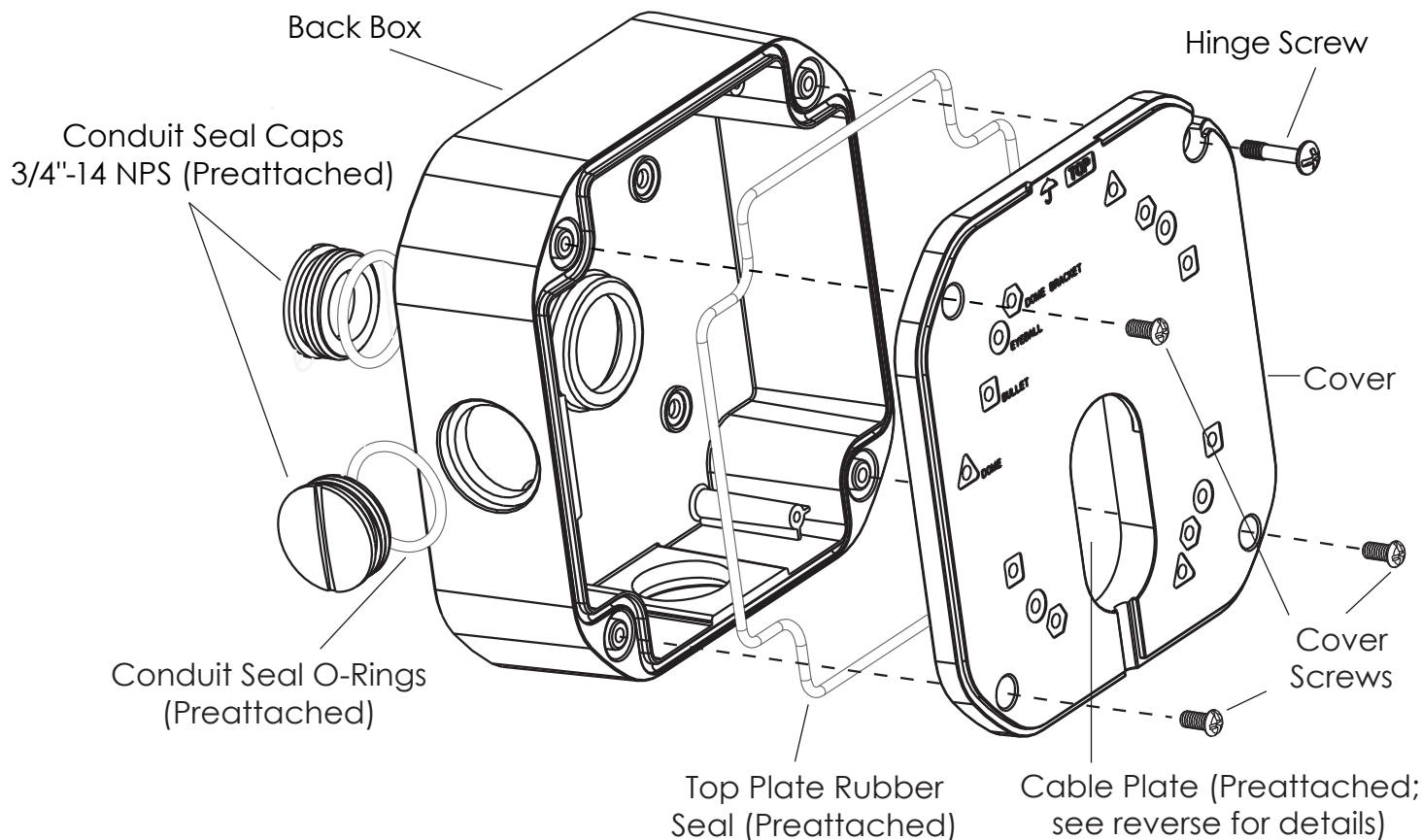

INSTALLATION



WARNING -

Make sure to install in a location that can support the weight of the junction box, camera, and accessories.

To ensure a waterproof seal, make sure the TOP marking on junction box points up from the ground when installed and that o-rings/rubber seals are attached properly to mounting screws, conduit caps, and junction box.

1

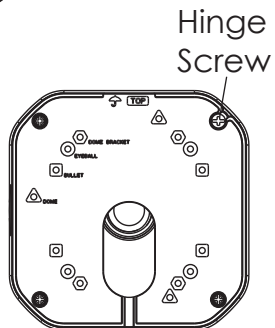

2



1. Remove the hinge screw (1x) and remove the cover from the back box. If running cables through the side conduit holes, ensure a conduit cap and o-ring is fitted to the rear of the junction box.

2. Use the included mounting template to drill holes. Attach junction box to surface using the junction box mounting screws (4x) with o-rings attached.

3. Turn cover over and remove the cable plate screws (4x) to remove the cable plate. This opens up the cable gap in the cover. Run the cables through the cable gap and camera housing/mounting bracket (depending on model).

4. Install the camera or mounting bracket to the cover using the camera mounting screws (PM4x8 or PM4x14). See the table below for a list of compatible Digimerge products.

3

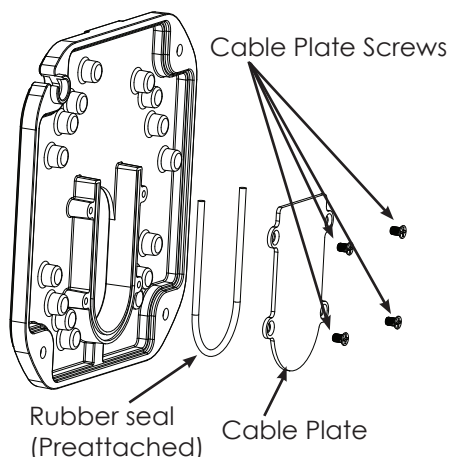

4

Mounting Holes	Symbol	Compatible Digimerge Products
Dome		DPV34D, DPV24D, DPV24DL, DPV24TLX, DNV14TL2, DPD23D, DPD24D, DPD24DL, DPD34D
Bullet		DNB14TL2, DPB34TLX
Dome Bracket		MNTV2XW, MNTV2XC

6

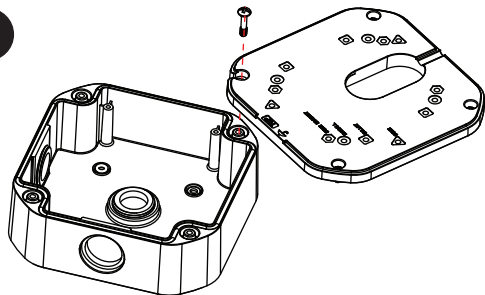

5. Reattach the cable plate to the cover, ensuring that the rubber seal is in the correct position.

6. Attach the cover to the back box using the hinge screw (1x). Make sure that the TOP marking on the cover is pointing up from the ground when installed. The camera can now swing to the side of the junction box.

7

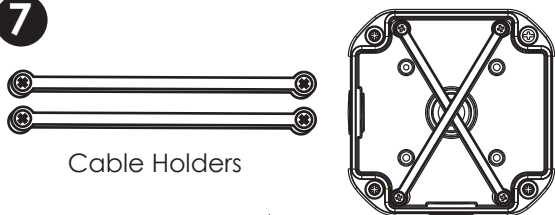

7. Connect the cables inside the junction box. Use the cable holders to hold the cables in place during a ceiling installation.

8

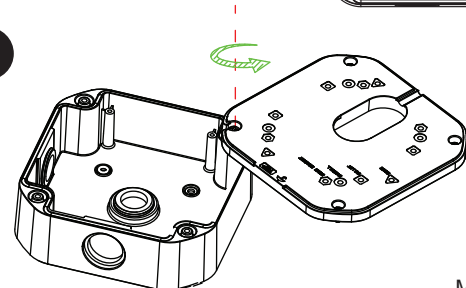

8. Slide the cover into place over the junction box, ensuring that the rubber seal is correctly in place. Insert the cover screws (3x) to attach cover to junction box.