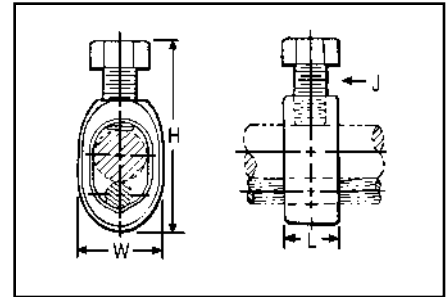

TYPE GRC**HIGH STRENGTH
GROUND ROD CLAMP**

For Copper Cable to Rod

High copper alloy ground connector for joining a range of cable to copper clad, galvanized steel, and stainless steel ground rods. Slips over end of rod, one-wrench installation. UL467 Listed for direct burial in earth and concrete.

**REA LISTED**

Catalog Number	Drive Rod	Conductor Range		H	W	L	J
		Min.	Max.				
GRC12	1/2	10 Sol.	2 Str.	2.00	.89	.63	3/8
GRC58	5/8		1 Str.	2.19	.95	.63	
GRC34	3/4	8 Sol.	1/0 Str.	2.47	1.09	.65	

E-45

**TYPE GCRT1/0
GROUND
CONNECTORS****GROUND CLAMP
RANGE TAKING, UP TO 1/0**

The GCRT1/0 is a range taking ground rod clamp offering another choice from the BURNDY® family of connectors. The GCRT1/0 works on 1/2", 5/8" and 3/4" ground rods with a wire range of #8 through 1/0! The clamp is UL467 Listed for direct burial in earth and concrete. Catalog number **GCRT1/0**.

**Features and Benefits**

- Range taking design helps reduce inventory.
- UL Listed and CSA Certified.
- UL467 Listed for direct burial in earth and concrete.

**TYPE GRL****LIGHT DUTY
ECONOMICAL GROUND ROD
CLAMP**

UL467 Listed. Acceptable for direct burial.



Catalog Number	Rod Size	Conductor Range	
		Minimum	Maximum
GRL3*	3/8	10 AWG	4 AWG
GRL4	1/2	10 AWG	2 AWG
GRL5	5/8	10 AWG	2 AWG
GRL6	3/4	10 AWG	2 AWG

* GRL3 not UL Listed.

Blue highlighted items are industry standard and most frequently ordered.