

**ONE HOLE HYLUG™
FLEX CONDUCTOR
LONG BARREL WITH
INSPECTION WINDOW**
(Continued)

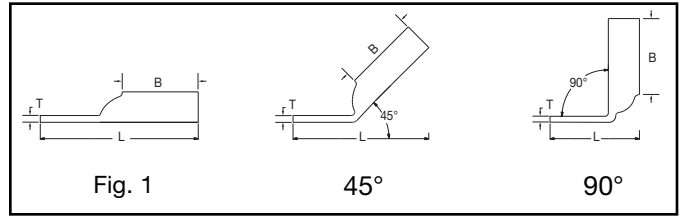

UL Listed 90° C,
600 Volts to 35 kV ◆

45° and 90° angles are available.
Please contact Customer Service to order:
1-800-346-4175



Catalog Number	Fig #	Conductor		Stud Hole Size	Tongue Width	Figure Dimensions			▲ Installation Tooling						Wire Strip Length		
		AWG	MM ²			(B)	(T)	(L)	Dieless (# of crimps)	Mechanical MD6, OUR840, MD7-34R	Hydraulic BCT500HS, Y500CTHS		Y35, Y39, Y750, Y46*, PAT750	Color Code		Die Index	
YAZV1CTC516FX	1	225/24 #1 Weld	—	5/16"	.75"	1.38"	.12"	2.47"	Y644HS (1) Y81KFT (1) Y81KFTMBH (1) PAT81KFT-18V (1)	W1CRT-1 (2)	W1CRT-1 (2)	U1CRT-1 (2)	Green	11	1-7/16"		
YAZV1CTC38FX	1	1/0 AWG		3/8"	.75"	1.38"	.12"	2.60"		W1CVT (2)	W1CVT (2)					X1CRT-1 (2)	X1CRT-1 (2)
YAZV25TC14FX	1	275/24	50	1/4"	.83"	1.50"	.12"	2.58"	MY29-11 (2)	W25VT (4)	W25VT (4)	U25RT (2)	Pink	12	1-9/16"		
YAZV25TC38FX	1	1/0 Weld		3/8"	.83"	1.50"	.12"	2.76"		W25RT (4)	W25RT (4)					X25RT (4)	X25RT (4)
YAZV25TC12FX	1	1/0 AWG	70	1/2"	.83"	1.50"	.12"	3.20"	MY29-11 (2)	W26VT (4)	W26VT (4)	U26RT (2)	Black	13	1-9/16"		
YAZV26TC14FX	1	325/24		1/4"	.93"	1.50"	.13"	2.58"		W26RT (4)	W26RT (4)					X26RT (4)	X26RT (4)
YAZV26TC38FX	1	2/0 Weld	70	3/8"	.93"	1.50"	.13"	2.76"	MY29-11 (2)	W26RT (4)	W26RT (4)	U26RT (2)	Black	13	1-9/16"		
YAZV26TC12FX	1	2/0 AWG		1/2"	.93"	1.50"	.13"	3.20"		X26RT (4)	X26RT (4)					X26RT (4)	X26RT (4)
YAZV27TC38FX	1	450/24 3/0 Weld 3/0 AWG	95	3/8"	1.03"	1.50"	.14"	2.80"	Y644HS (1) Y81KFT (2) Y81KFTMBH (2) PAT81KFT-18V (2)	W27RT (4)	W27RT (4)	U27RT (2)	Orange	14	1-9/16"		
YAZV28NT38FX	1	550/24 4/0 Weld	120	3/8"	.94"	1.62"	.14"	2.96"	W27VT (4)	W27VT (4)	X27RT (4)					X27RT (4)	
YAZV28TC38FX	1	4/0 Weld		120	3/8"	1.14"	1.62"	.14"	2.96"	PAT81KFT-18V (2)	W28VT (4)	W28VT (4)	U28RT (2)	Purple	15	1-11/16"	
YAZV28TC12FX	1	4/0 AWG	1/2"		1.14"	1.62"	.14"	3.18"	W28RT (4)		W28RT (4)	X28RT (6)					X28RT (6)
YAZV29NT516FX	1	550/24 4/0 Weld	—	5/16"	.96"	2.00"	.16"	2.87"	Y644HS (1) Y81KFT (2) Y81KFTMBH (2) PAT81KFT-18V (2)	W29VT (4)	W29RT (4)	U29RT (2)	Yellow	16	2-1/16"		
YAZ30TC38FX	1	250 Flex CLASS G 259 Str. CLASS H 427 Str	—	3/8"	1.20"	2.00"	.16"	3.42"		W29VT (4)	W29VT (4)					X29RT (8)	X29RT (8)
YAZ31TC38FX	1	262.2 Flex 637/24 CLASS I, K, M	150	3/8"	1.28"	2.00"	.18"	3.45"	Y644HS (1) Y81KFT (2) Y81KFTMBH (2) PAT81KFT-18V (2)	W30VT (4)	W30VT (4)	U30RT (4)	White	17	2-1/16"		
YAZ32TC38FX	1	775/24 313.1 kcmil 300 Flex	185	3/8"	1.55"	2.12"	.19"	3.62"		W31VT (4)	W31VT (4)					W31RT (4)	W31RT (4)
YAZ34NT38FX	1	925/24	240	3/8"	.96"	2.25"	.23"	3.85"	Y644HS (1) Y81KFT (2) Y81KFTMBH (2) PAT81KFT-18V (2)	W32VT (4)	W32VT (4)	U32RT (4)	Blue	19	2-5/16"		
YAZ34TC38FX	1	373.3 kcmil		3/8"	1.52"	2.25"	.23"	3.85"		W32RT (4)	W32RT (4)					W32RT (4)	W32RT (4)
YAZ34TC12FX	1	350 Flex	240	1/2"	1.52"	2.25"	.23"	4.29"	Y644HS (1) Y81KFT (2) Y81KFTMBH (2) PAT81KFT-18V (2)	—	—	U34RT (4)	Brown	20	2-3/4"		
YAZ36TC38FX	1	1100/24 444.4 kcmil 450 Flex		—	3/8"	1.72"	2.69"	.26"		4.55"	—					—	U34RT (4)
YAZ38NT38FX	1	1325/24	300	3/8"	1.63"	2.81"	.27"	4.72"	Y644HS (1) Y81KFT (2) Y81KFTMBH (2) PAT81KFT-18V (2)	—	—	U38XRT (4)	Pink	L99	2-7/8"		
YAZ38TC38FX	1	535.3 kcmil		3/8"	1.81"	2.81"	.27"	4.72"		—	—					U38XRT (4)	U38XRT (4)
YAZ38NT12FX	1	500 Flex		1/2"	1.63"	2.81"	.27"	4.97"		—	—					U38XRT (4)	U38XRT (4)
YAZ38TC12FX	1	500 Flex		1/2"	1.81"	2.81"	.27"	4.97"		—	—					U38XRT (4)	U38XRT (4)

* Use PUADP-1 adapter with U dies in Y46 HYPRESS™
 ** The 120 MM² referenced here is for both Class 2 and Class 5 conductor.
 *** The MM² conductor sizes listed are the recommendations for Class 5 conductor.

▲ See tooling section of this catalog for complete tool and die listings. Use ONLY color-coded die recommendations for -FX connectors. For nest/indentor system contact factory.

◆ For applications greater than 2000 Volts consult cable manufacturer for voltage stress relief instructions.
 Note: All dimensions shown are for reference only.

Blue highlighted items are industry standard and most frequently ordered.