

1. CARTON CONTENTS

- Pretium EDGE solution module

2. TOOLS AND MATERIALS

- Phillips- head screwdriver (number 3)
- LC Connector / adapter Cleaning Tool (p/n CLEANER-PORT-LC)
- MTP® Connector Cleaner Cassette (p/n CLEANER-UNIVERSE-CASS)
- MTP Adapter Cleaning Tool (p/n 2104466-01)
- (4) screws, Thread cut, 12-24 x 0.5-inch, pan-head phillips

3. PRECAUTIONS



WARNING: Isopropyl alcohol is flammable with a flashpoint at 54°F. It can cause irritation to eyes on contact. In case of contact, flush eyes with water for at least 15 minutes. Inhalation of vapors irritates the respiratory tract. Exposure to high concentrations has a narcotic effect, producing symptoms of dizziness, drowsiness, headache, staggering, unconsciousness and possibly death.

4. INSTALLATION

4.1. Mounting Pretium EDGE Module Housing into an Enhanced Management Frame (EMF)

- Step 1:** Mount empty housings starting at bottom of frame to the left or right of the hub, as appropriate for your housing.
- Step 2:** Secure housing to frame with the screws provided.
- Step 3:** Snap fiber guides onto inner side of the housing.

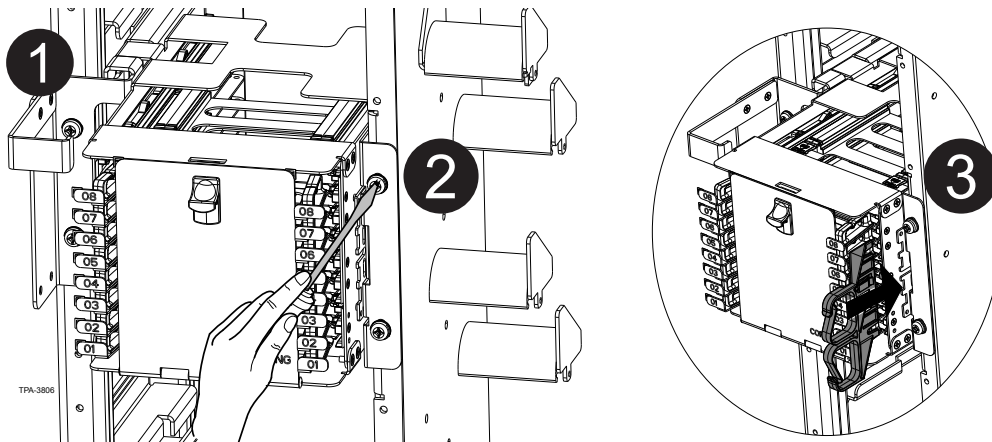

4.2. Installing Pretium EDGE™ Modules

- Step 1:** Open housing front door and pull tray forward.
- Step 2:** Insert module into the number 1 position until it latches.
- Step 3:** Repeat for all modules, loading from number 1 to number 8 position, bottom to top in the housing.
- Step 4:** Slide tray back into housing. Close and latch front door.

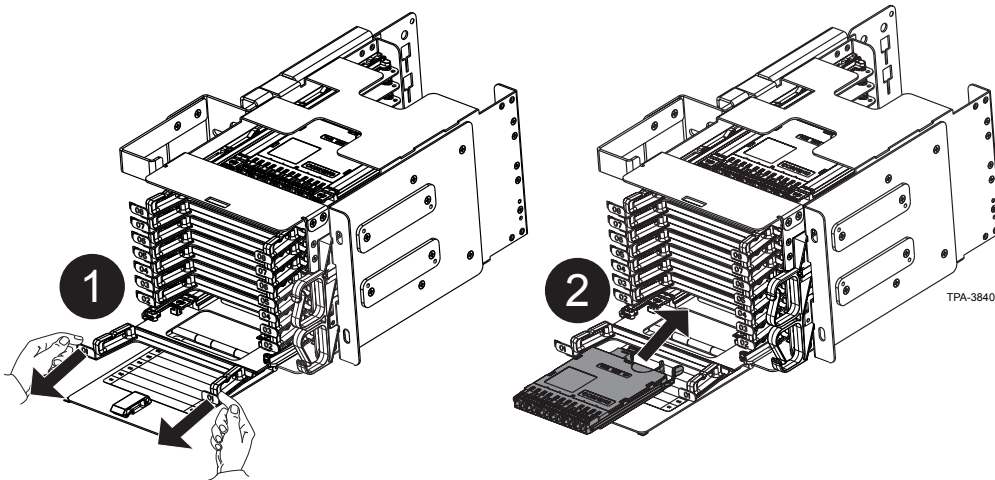

4.3. Connecting Trunk Furcation Body

The trunk cable may enter the rear of the housing from the top or bottom, and from either the left or right sides of the housing. The Trunk Furcation Mounting Bracket has been factory-installed for cable entering the housing from the bottom.

- Step 1:** If the cable will enter from the top, remove the mounting bracket, turn it over, and reattach it to the housing with the same screws before attempting to mount the furcation bodies.

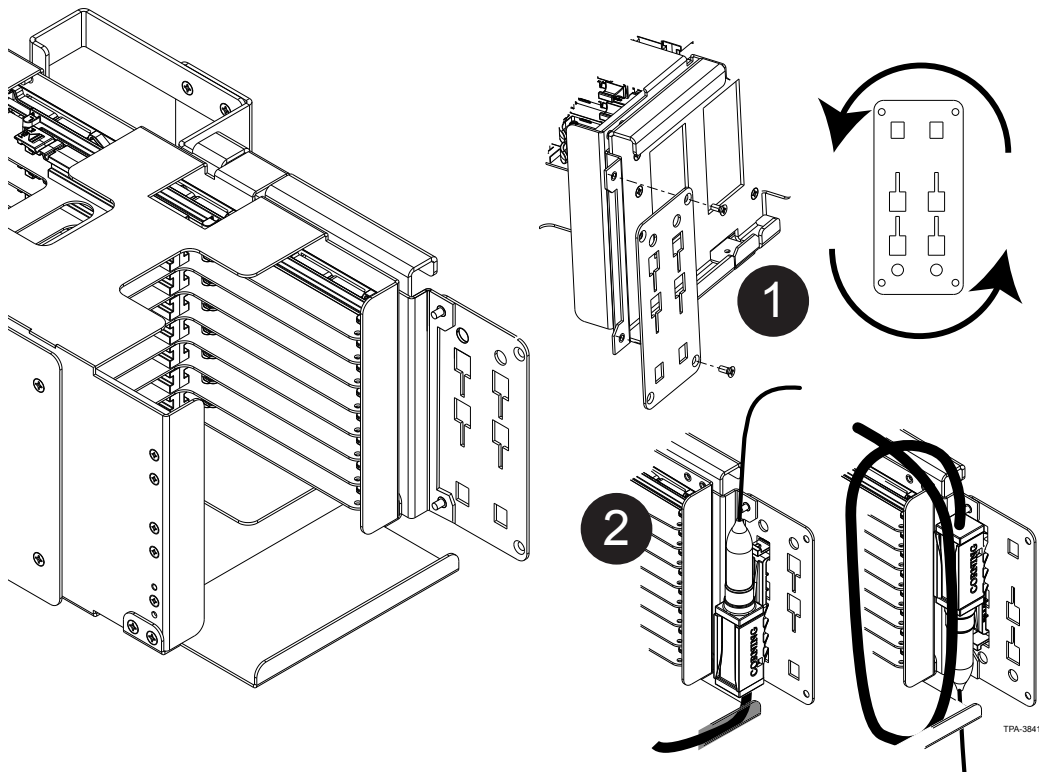

Step 2: Mount furcation body onto the mounting bracket on back of the housing using the Pretium EDGE™ furcation cradle.

NOTE: There are two version of the furcation cradle. Determine which type you have before attempting to mount it onto the bracket.

Step 3: Form a loop in the fibers approximately 4 inches in diameter.

- The coil direction depends on the entry point of the trunk cable.
- Form the loop with the coil and connectors closest to the housing.
- Secure the loop with a tie or hook-and-loop strap about 8 inches from the connectors.

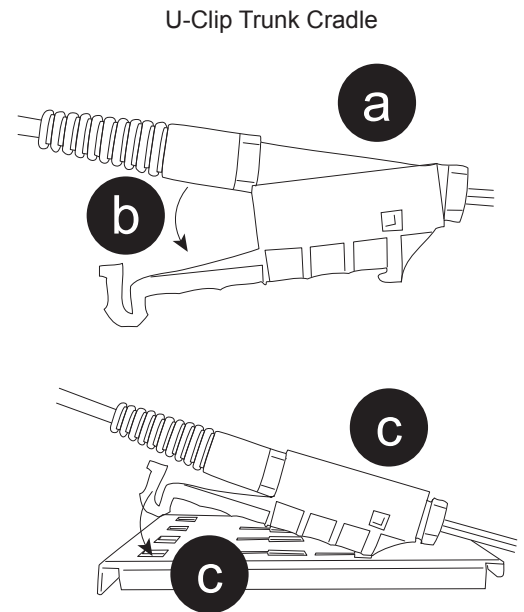
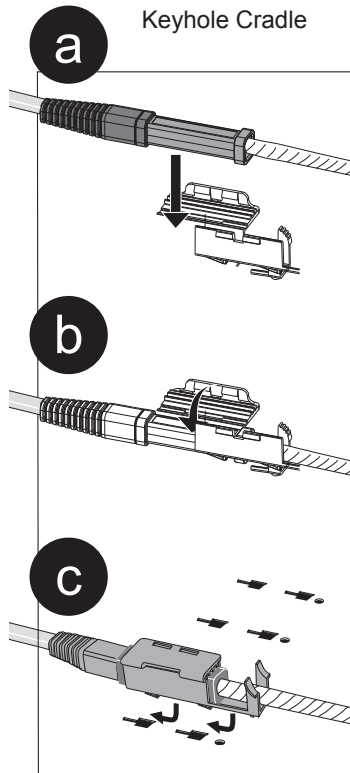

Step 4: Clean the MTP® connectors and adapters per the instructions provided with the cleaning tools, then mate the MTP connectors into the rear of the module.

NOTE: Ensure that there is enough slack on the connector side of the coiled slack loop to allow the trays to be pulled forward from the front (approximately 4 inches).

Step 5: Place slack coil in the tray provided in the back of the housing.

Step 6: If necessary, pull the slack coil out of the tray to access the MTP connections again.

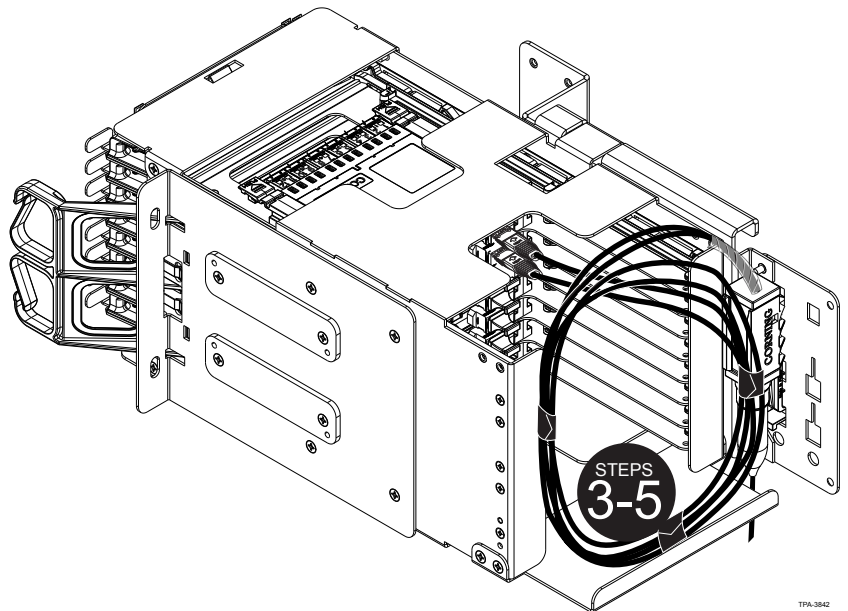

4.4. Connecting Jumpers

- Step 1:** Open front door and pull tray forward, being sure not to pull on the trunk cable in the rear.
- Step 2:** Clean the connectors and adapters per the instructions provided with the cleaning tools.
- Step 3:** Route jumpers out of the tray and through the fiber management fingers on the inner side of the housing next to the hub.
- Step 4:** Route and manage the remaining jumper slack storage as described in the installation instruction 003-599, Section 3, for the EMF.

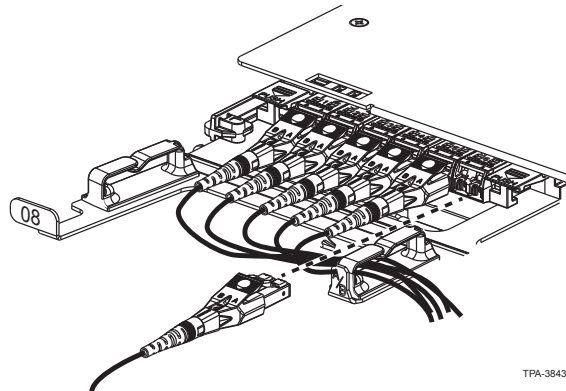

TPA-3843