

## Product information

### GO 610 FA M schwarz/black

Industrial Connecting Solutions: Rectangular Connectors: DIN VDE 0627 / IEC 61984 Connectors (G serie): Cable plug: GO 610 FA M schwarz/black

<http://www.e-catalog.beldensolutions.com/link/57078-24228-256261-24347-24349-37031/en/conf/ui/state>

Name	GO 610 FA M schwarz/black
	
	Surface mounted connector with flange with solder contacts
<b>Delivery informations</b>	
Availability	available
<b>Product description</b>	
Description	Surface mounted connector with flange with solder contacts
Type	GO 610 FA M schwarz/black
Order No.	932 478-100
Type of contact	male
Number of contacts	6 + PE
Standard	DIN VDE 0627 / IEC 61984
Housing Color	black
<b>Technical data</b>	
Pin dimensions	1,6 mm (diameter)
Rated voltage	AC/DC 250 V
Rated current	DC 6 A / AC 10 A
Contact resistance	<= 4 mOhm
Type of termination	solder
Mounting	screws
<b>Material</b>	
Contact surface material	Sn
Contact bearer material	PA
Housing material	PA
<b>Environmental conditions</b>	
Protection class (IEC 60529)	IP 65
Pollution severity	3
Temperature range	-40 °C to +90 °C
<b>Inflammability class</b>	
Housing	94 V-1
Contact bearer	94 V-1
<b>Packing unit</b>	
Packaging unit	100 pieces
<b>Scope of delivery and accessories</b>	
Scope of delivery	1 surface mounted connector, 1 flat gasket
Accessories to order separately	can be plugged into GO 610 WF schwarz/black

Industrial Connecting Solutions: Rectangular Connectors: DIN VDE 0627 / IEC 61984 Connectors (G serie): Cable plug: GO 610 FA M schwarz/black  
<http://www.e-catalog.beldensolutions.com/link/57078-24228-256261-24347-24349-37031/en/conf/ui/state>

Picture

Drawing

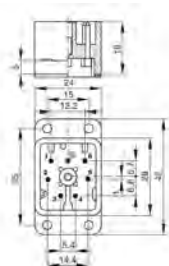

**Belden Deutschland GmbH**

Im Gewerbepark 2  
58579 Schalksmühle  
Germany  
Phone: +49 7127/14-1806  
E-Mail: [icos-sales@belden.com](mailto:icos-sales@belden.com)

The information published in the websites has been compiled as carefully as possible. It is subject to alteration without notice in technical as well as in price-related/commercial respect. The complete information and data were available on user documentation. Mandatory information can only be obtained by a concrete query.