

7/8" Mini-Receptacle Connectors, Front Mount, US Color Code

RSF 20...60A | RKF 201...601A



Male, 2-, 3-, 4-, 5, and 6-Pole

Receptacle connector, 7/8"-A body, male
2-, 3-, 4-, 5, and 6-pole for front mounting,
assembled stranded wire, potted with epoxy,
chassis side thread 1/2" NPT, screw connection.

– US Color Code –

RSF 20...60A

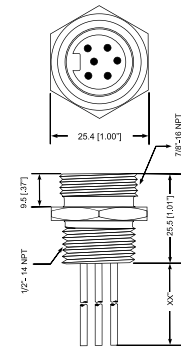

Female, 2-, 3-, 4-, 5, and 6-Pole

Receptacle connector, 7/8"-A body, female
2-, 3-, 4-, 5, and 6-pole for front mounting,
assembled stranded wire, potted with epoxy,
chassis side thread 1/2" NPT, screw connection.

– US Color Code –

RKF 201...601A

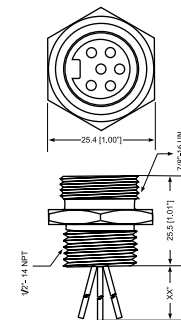

Pin Assignments

Face Views, 7/8"-Male / Female

2 pole

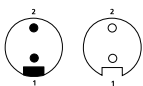

1 = white
2 = black

3 pole

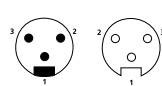

1 = green
2 = black
3 = white

4 pole

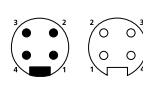

1 = black
2 = white
3 = red
4 = green

5 pole

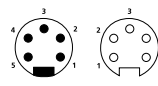

1 = white
2 = red
3 = green
4 = orange
5 = black

6 pole

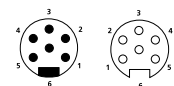

1 = white
2 = red
3 = green
4 = orange
5 = black
6 = blue



Be Certain with Belden

7/8" Mini-Receptacle Connectors, Front Mount, US Color Code
 RSF 20...60A | RKF 201...601A

Technical Data

Environmental

Degree of protection IP 68 / NEMA 6P
 Operating temperature range -40°C (-40°F) / +90°C (+194°F)

Mechanical

Insert TPU, yellow
 Contacts CuZn, gold plated
 Receptacle shell Zinc die cast (e-coated black)
 Locknut Steel, zinc plated
 O-ring Viton

Electrical

Current rating 2 pole: 12 A
 3-5 pole: 8 A
 6 pole: 5 A
 Voltage rating 2-5 pole: 600 V
 6 pole: 300 V

Part Number	Pins	Gauge	Characteristics
RSF 20-678/1F RKF 201-678/1F	2	16	
RSF 30-638/1F RKF 301-638/1F	3	16	
RSF 40-639/1F RKF 401-639/1F	4	16	
RSF 50-677/1F RKF 501-677/1F	5	16	
RSF 60A-697/1F RKF 601A-697/1F	6	18	