

RJ45 acc. to IEC 60 603 – Technical characteristics see page 03.26

Circular Connectors

**Han® M12 panel feed-through**  
Male, D-coded,  
50 cm conductors, AWG 22, 4-poles



**21 03 371 1403**

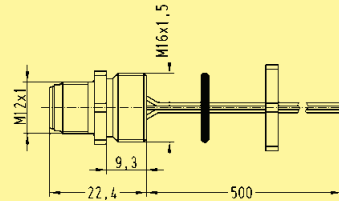

**Han® M12 panel feed-through**  
Female, D-coded,  
50 cm conductors, AWG 22, 4-poles



**21 03 371 2403**

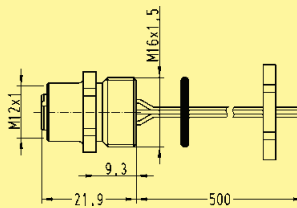

**Han® M12 female-RJ45 panel feed-through**

4-poles,  
D-coded,  
angled



**21 03 381 4400**

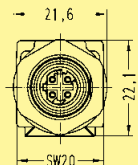
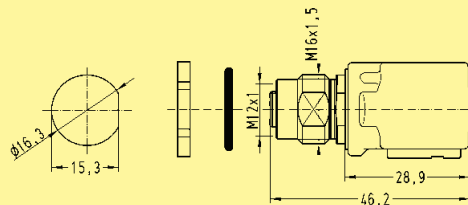

**Han® M12 female-RJ45 panel feed-through**

4-poles,  
D-coded,  
straight



**21 03 381 2400**

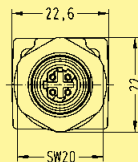
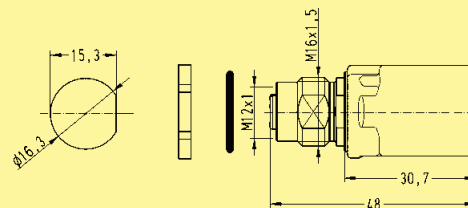

**Han® M12 male-RJ45 adapter**

4-poles,  
D-coded,  
straight



**21 03 371 1420**

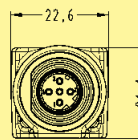
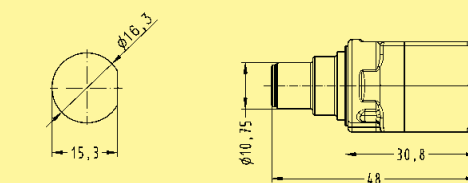

**Han® M12 Gender Changer**

4-poles, D-coded



**21 03 381 6405**

