



### Han® 3 A RJ45-panel feed-throughs and couplings Cat. 5

Identification	Part No.	Drawing	Dimensions in mm
----------------	----------	---------	------------------

#### Panel feed-through set, 8-poles

Plastic version, black	straight	09 45 225 1100
	angled	09 45 225 1108
Metal version Standard, grey	straight	09 45 215 1100
	straight, inner vertical jack	09 45 215 1101
	angled	09 45 215 1108
Metal version Standard, grey with self-closing protective cap	straight	09 45 215 1103
Metal version M, black	straight	09 45 215 1102
	angled	09 45 215 1109
Coding pin set for 4 different codings		09 45 820 0000

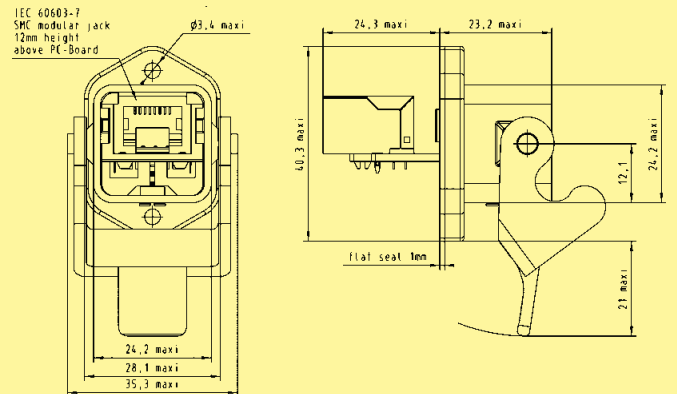

Dimensions valid for plastic version, straight

#### Double coupling, 8-poles incl. installation frame metal

Plastic version, black	09 45 225 1107
Metal version Standard, grey	09 45 215 1107
Metal version M, black	09 45 215 1110
Coding pin set for 4 different codings	09 45 820 0000

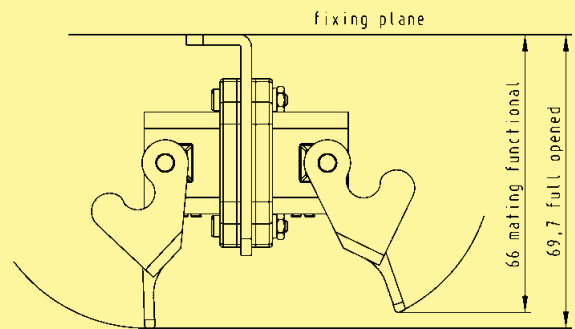

Dimensions valid for plastic version

#### Protection cover for panel feed-through IP 65 / IP 67 with seal

Plastic version, black	09 20 003 5449
Metal version Standard, grey	09 20 003 5425
Metal version M, black	09 37 003 5405

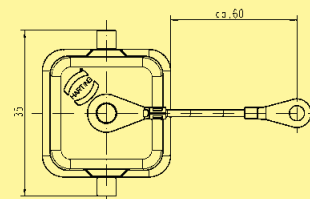

Dimensions valid for plastic version