

JB6 Jumper Bars

Terminal Blocks Accessories



RoHS
RoHS

6 mm 0.236 in spacing



Features and Benefits

Facilitate & secure your jumper bar assembly process:

- Screwless mounting,
- Pre-cut poles for various configurations,
- Insulated,
- Positive locking.

Ordering Details

Description	Color	Type	Order Code	Pack ^(ing) pieces	Weight (1 pce) g
6 mm 0.236 in spacing	Orange	JB6-2	1SNK 906 302 R0000	50	1.30
		JB6-3	1SNK 906 303 R0000	50	2.10
		JB6-4	1SNK 906 304 R0000	50	2.90
		JB6-5	1SNK 906 305 R0000	50	3.60
		JB6-10	1SNK 906 310 R0000	20	7.40
		JB6-50	1SNK 906 350 R0000	10	38.10

Main Technical Data

	Tool	Torque		
Screwless				
Material Specifications	Insulating material	Polyamide		
	Flammability	V0		
	NF F 16 101	I2F3		
Ambient temperature min/max	Service IEC 60068-2-1	-55 +110 °C -67 +230 F		
	Storage	-55 +110 °C -67 +230 F		
	Installing	-5 +40 °C -23 +104 F		
	IEC	cULus - CSA	Ex e	
Rated current	41 A	30 A		
Rated voltage	Standard use	1000 V	600 V	630 V
	Cut extremities	800 V	300 V	Not authorized
	Cut poles	400 V	300 V	Not authorized
Impulse withstand voltage	8000 V			
Protection	IP20	NEMA 1		

Accessories

Description	Color	Type	Order Code	Pack ^(ing) pieces	Weight (1 pce) g
Circuit Separators	Dark Grey	CS	1SNK 900 101 R0000	20	0.20

Some accessories may modify the terminal block's ratings. See complete information in "Technical Datasheet".

Mounting Instructions

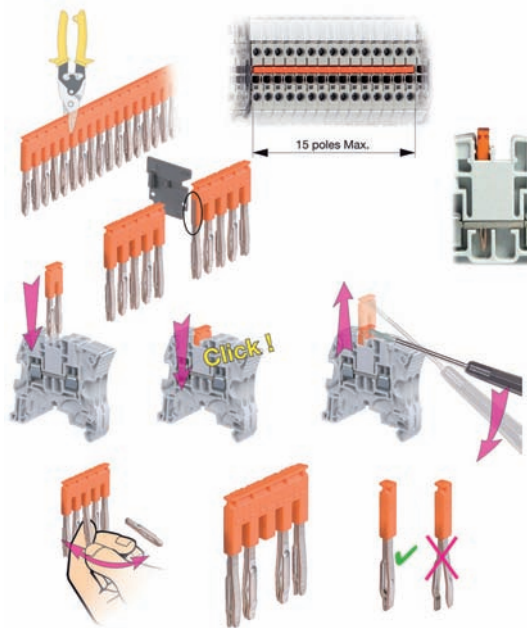

- Caution: the use of jumper bars with cut extremities is forbidden in Explosive atmospheres;

- For jumper bar with cut extremities, additional accessories must be installed on the cut side:

circuit separator CS when mounted on feed-through or ground terminal blocks,

circuit separator CS-R1 when mounted on disconnect terminal blocks,

end section ES4-D2 when mounted on double deck terminal blocks;

- Jumper bar with cut poles: for alternated jumpering between terminal blocks.