



# OUTDOOR HOUSING MOUNTING BRACKET

**Installation and Operation Instructions for the following models:**

UNI-RMB1, SNCWM30G

(1) Supplied Parts

- (1) Bracket top
- (1) Bracket base
- (2) Phillips screws
- (2) Lockwashers
- (2) Flat washers

(1) Operation Instruction Manual

## INSTALLING THE HOUSING ASSEMBLY

### GENERAL INSTRUCTIONS:

Tools Required: .100" Flat Head Screwdriver  
Phillips Head Screwdriver

- 1 Choose an appropriate location and mount the bracket base (hardware not included). It may be mounted on the inside or outside of a parapet, in either a left or right hand configuration (Figure 1).

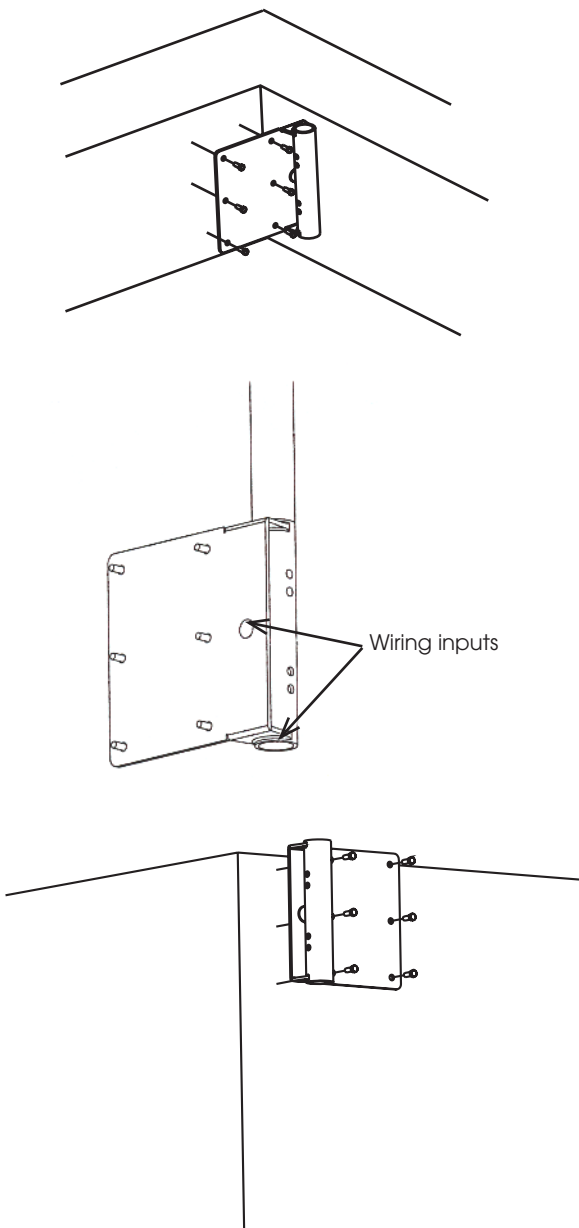

Figure 1

- 2 Place the bracket top into the top hole of the bracket base and secure with the (2) screws, (2) lock washers, and (2) flat washers provided (Figure 2) (Figure 2).

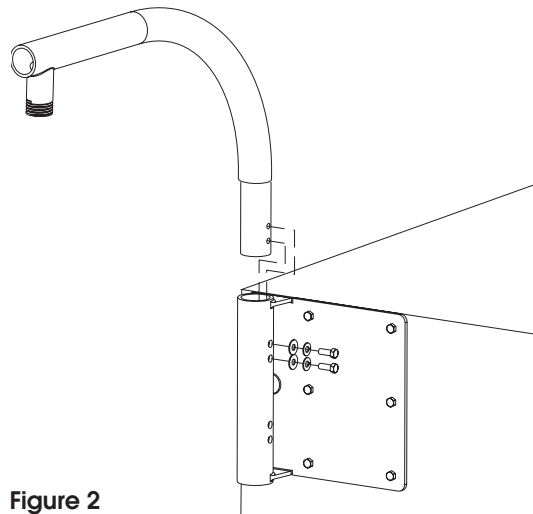

Figure 2

- 3 Run electrical and video wiring through the inside of the bracket and out through the dome attachment arm (Figure 3).

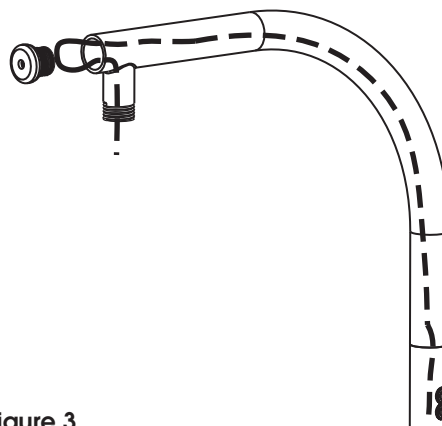

Figure 3

- 4 Attach the dome to the bracket, making wiring connections per the dome's instructions (Figure 4).

**NOTE:** If wiring connections are made outside the housing, make the connections before attaching the housing to the bracket.

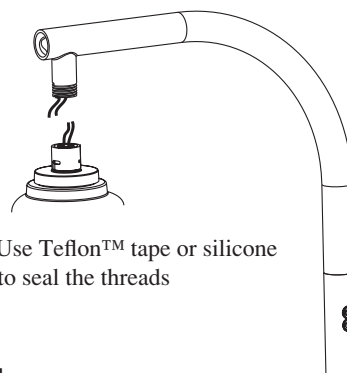

Figure 4

- 5 Remove the end cap from the parts bag and secure to the bracket end using an Allen head tool (Figures 5 and 6).

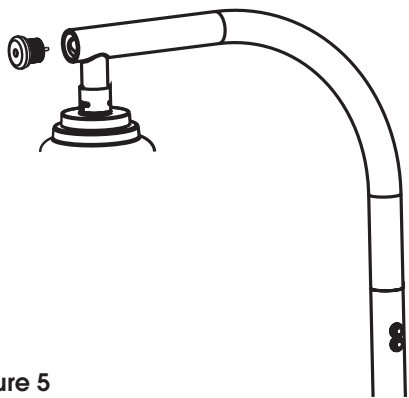

Figure 5

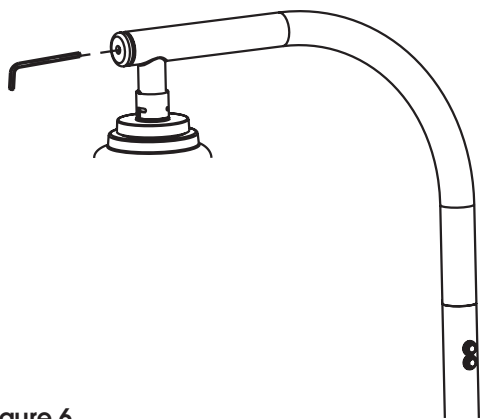
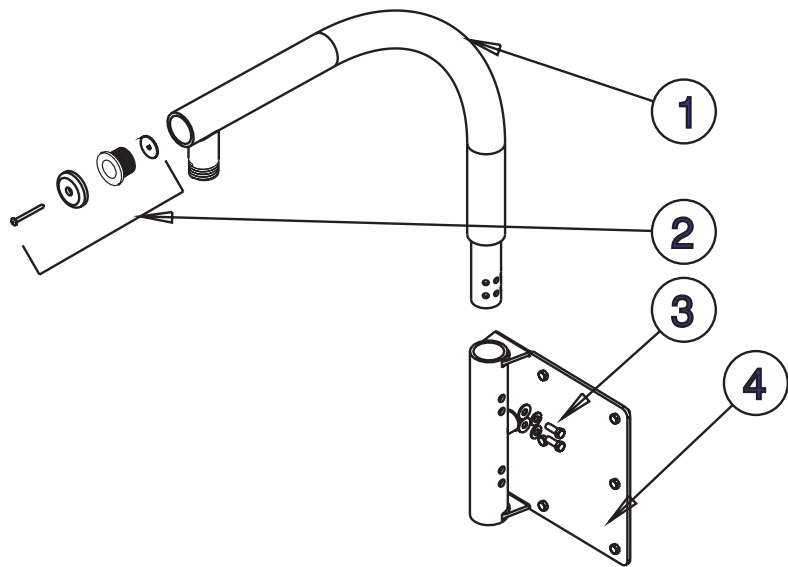

Figure 6

EXPLODED VIEWS OF BRACKET



Parts List

	Description	Qty.
1	Bracket top	1
2	End Cap Assembly	1
3	Phillips screws	2
	Lockwashers	2
	Flat washers	2
4	Bracket base	1

## IMPORTANT SAFEGUARDS

- 1 Read Instructions - All the safety and operating instructions should be read before the unit is operated.
- 2 Retain Instructions - The safety and operating instructions should be retained for future reference.
- 3 Heed Warnings - All warnings on the unit and in the operating instructions should be adhered to.
- 4 Follow Instructions - All operating and user instructions should be followed.
- 5 Electrical Connections - Only a qualified electrician should make electrical connections..
- 6 Attachments - Do not use attachments not recommended by the product manufacturer as they may cause hazards.
- 7 Cable Runs - All cable runs must be within permissible distance
- 8 Mounting - This unit must be properly and securely mounted to a supporting structure capable of sustaining the weight of the unit. Accordingly:
  - a. The installation should be made by a qualified installer.
  - b. The installation should be in compliance with local codes.
  - c. Care should be exercised to select suitable hardware to install the unit, taking into account both the composition of the mounting surface and the weight of the unit. Be sure to periodically examine the unit and the supporting structure to make sure that the integrity of the installation is intact. Failure to comply with the foregoing could result in the unit separating from the support structure and falling, with resultant damages or injury to anyone or anything struck by the falling unit.

## SAFETY PRECAUTIONS

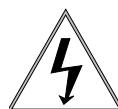

The lightning flash with an arrowhead symbol, within an equilateral triangle, is intended to alert the user to the presence of non-insulated “dangerous voltage” within the product’s enclosure that may be of sufficient magnitude to constitute a risk of electric shock to persons.



The exclamation point within an equilateral triangle is intended to alert the user to presence of important operating and maintenance (servicing) instructions in the literature accompanying the appliance.

## UNPACKING

Unpack carefully. Electronic components can be damaged if improperly handled or dropped. If an item appears to have been damaged in shipment, replace it properly in its carton and notify the shipper.

Be sure to save:

- 1 The shipping carton and packaging material. They are the safest material in which to make future shipments of the equipment.
- 2 These Installation and Operating Instructions.

## SERVICE

If technical support or service is needed, contact Sony at the following number:

**TECHNICAL SUPPORT**  
**8:15AM to 7:30PM (Eastern Time)**  
**1-800-883-6817**

**CAUTION**

This unit must be properly and securely mounted to a supporting structure capable of sustaining the weight of the bracket and camera assembly. Accordingly,

1. The installation should be made by a qualified installer.
2. The installation should be in compliance with local codes.
3. Care should be exercised to select suitable hardware to install the unit, taking into account both the composition of the mounting surface and the weight the hardware will be required to sustain.

Be sure to periodically examine the unit and the supporting structure to make sure that the integrity of the installation is intact.

Failure to comply with the foregoing could result in the unit coming loose from the support structure and falling, with resultant damages or injury to anyone or anything struck by the falling unit.