

## MOUNT THE HOUSING AND CONNECT THE CABLES

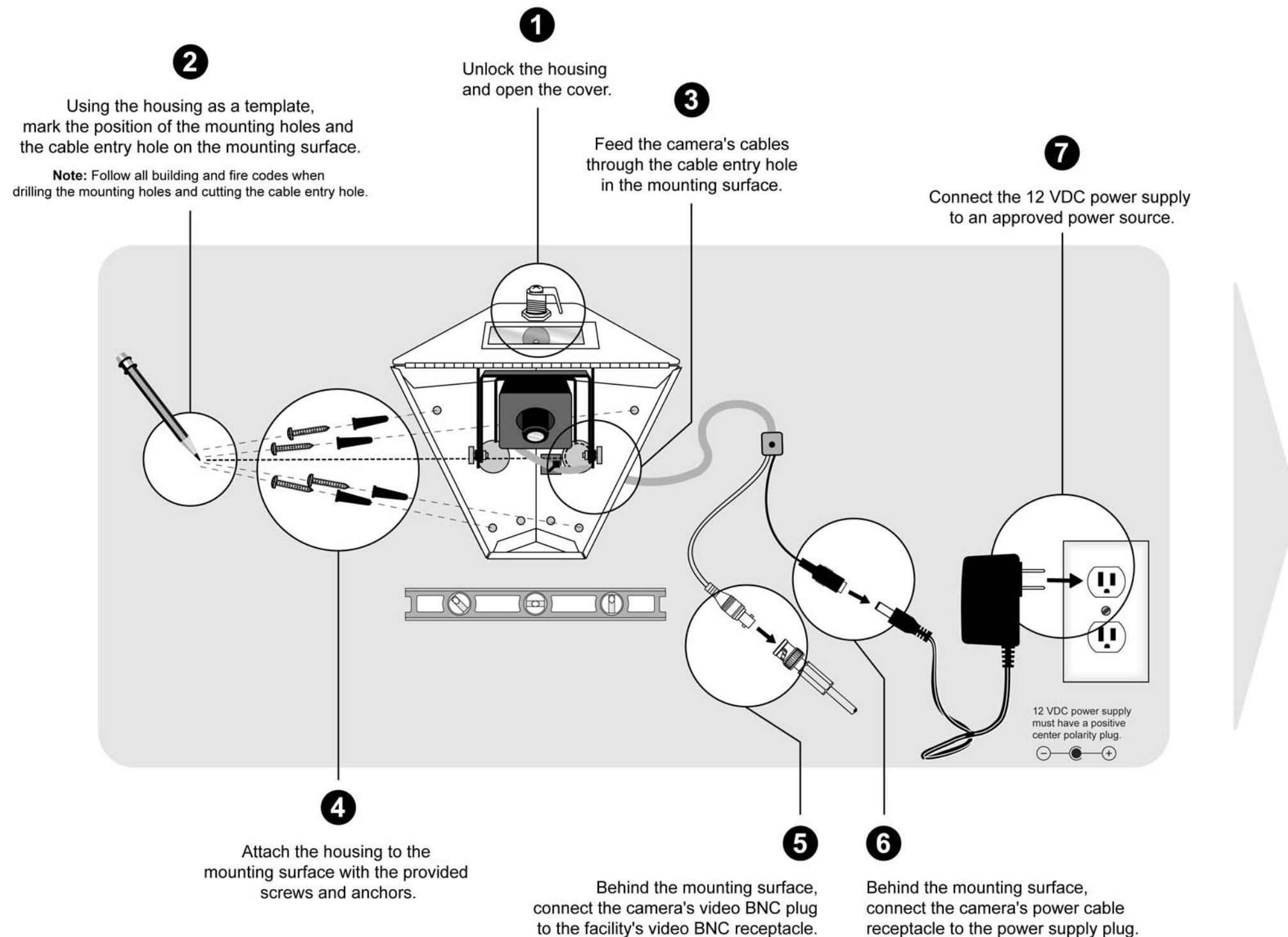

Your easy-to-install corner-mount camera comes with the following:

- Housing (with camera and clear window installed)
- Extra window (tinted window for obscured view of camera, if desired)
- Mounting hardware (screws and screw anchors; four each)
- Keys (2)

This equipment has been tested and found to comply with the limits for a Class A digital device, pursuant to part 15 of the FCC Rules. These limits are designed to provide reasonable protection against harmful interference when the equipment is operated in a commercial environment. This equipment generates, uses, and can radiate radio frequency energy and, if not installed and used in accordance with the instruction manual, may cause harmful interference to radio communications. You are cautioned that any changes or modifications not expressly approved by the party responsible for compliance could void the user's authority to operate the equipment.

## ADJUST THE CAMERA

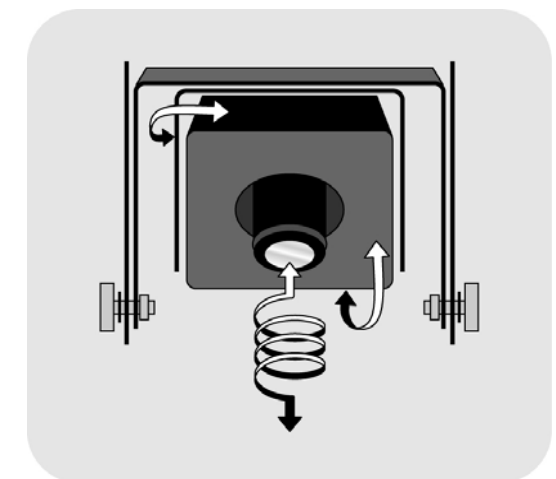

- 1) If needed, swivel the bracket horizontally and/or tilt the camera vertically to position the camera toward the viewpoint.
- 2) If needed, turn the lens to change the camera's focus.
- 3) Close the cover, lock the housing, and store the key in a secure location.