

THIS DRAWING IS UNPUBLISHED. RELEASED FOR PUBLICATION, 19 .
 © COPYRIGHT 19 BY AMP INCORPORATED. ALL INTERNATIONAL RIGHTS RESERVED.

LOC	DIST	P	F	ZONE	LTR	REVISIONS	DATE	APPD
AA	28							
					F	OBS: -4; EC 0502-0803-97	22MAY98	GG

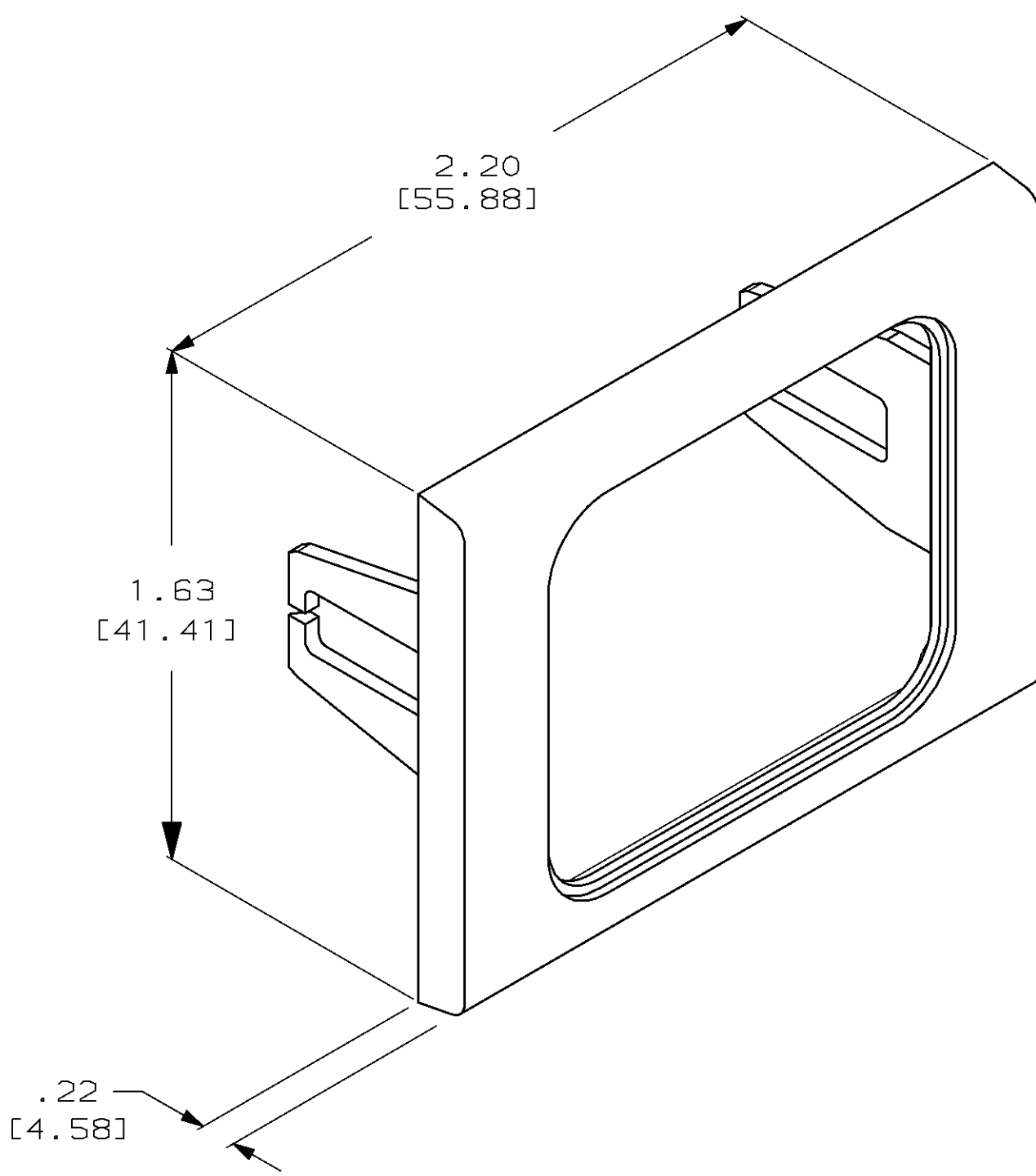

- ALL DIMENSIONS SHOWN ARE MAXIMUM UNLESS OTHERWISE SPECIFIED.
- MATERIAL: ABS MOLDING COMPOUND. SEE TABLE FOR COLOR.
- ALL DIMENSIONS SHOWN IN BRACKETS [] ARE IN MILLIMETERS.
- APPLICATION:
 THIS FACEPLATE SNAPS ONTO A SINGLE WALL BOX WHICH HAS BEEN INSTALLED DIRECTLY INTO A PANEL CUTOUT. THIS FACEPLATE ACCOMMODATES A RANGE OF PANEL THICKNESSES DEPENDING ON THE METHOD OF SECURING THE WALLBOX TO THE PANEL AS FOLLOWS:
 - WALLBOX IS SNAPPED IN THE PANEL: FACEPLATE WILL ACCOMMODATE .040-.090 [1.02-2.29] THICK PANEL, .060-.090 [1.52-2.29] IS RECOMMENDED.
 - WALLBOX SECURED TO PANEL USING SELF TAPPING SCREWS AND INTERNAL TOOTH LOCK WASHER RECOMMENDED FOR BEST GROUND OF WALLBOX TO PANEL: FACEPLATE WILL ACCOMMODATE .040-.080 [1.02-2.03] THICK PANEL.

COLOR	PART NO
WHITE	556680-5
BLACK	556680-3
LT ALMOND	556680-1

DO NOT SCALE PRINT. UNLESS SPECIFIED DIMENSIONS IN INCHES [mm] TOLERANCES ON: 2 PLC DEC ± 3 PLC DEC ± ANGLES ±	DR <i>Bel Woster</i> 4/24/90	AMP INCORPORATED Harrisburg, Pa. 17105	
MATERIAL 	CHK B. FOX 6-14-90		
FINISH	APPD DAVID WOLLA 6-14-90	NAME FACEPLATE, PANEL MOUNT, AMP COMMUNICATION OUTLET	
	APPD N. SIGMON 6-14-90	SIZE C 00779	DRAWING NO 556680
	PRODUCT SPEC	SCALE 2:1	SHEET 1 OF 1
	APPLICATION SPEC		
	WEIGHT		

CAD DRAWINGS
 THIS DRAWING WAS CREATED ON A COMPUTER AIDED DESIGN (CAD) SYSTEM. TO INSURE THE INTEGRITY OF THE DATA BASE ALL CHANGES/ REVISIONS MUST BE MADE ON THE CAD SYSTEM.