

LOC	DIST	REVISIONS			
HM	00	REV	DATE	BY	APPD
		A	09FEB2010	GG	RA

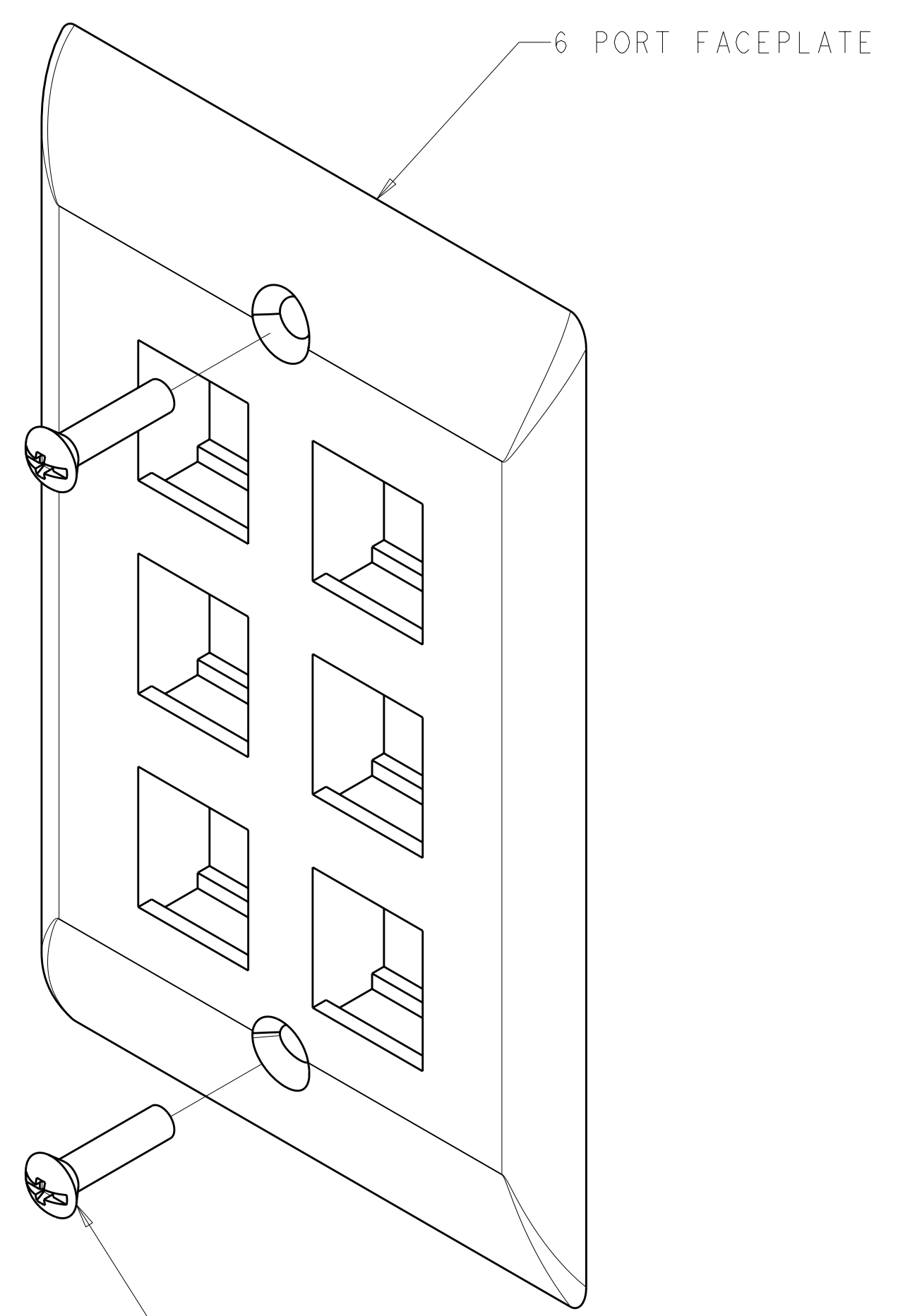

6-32X.88 OVAL HEAD SCREW
 QUANTITY 2

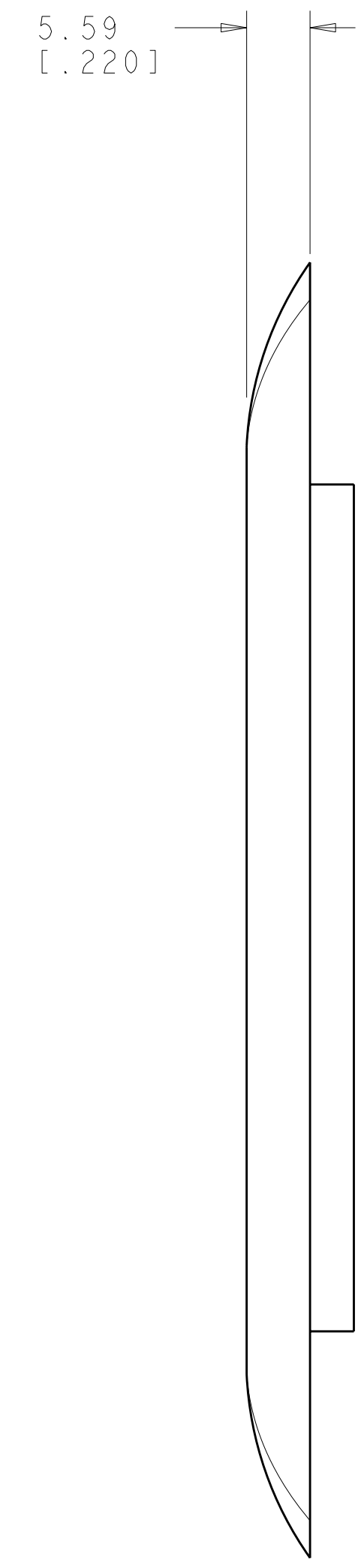
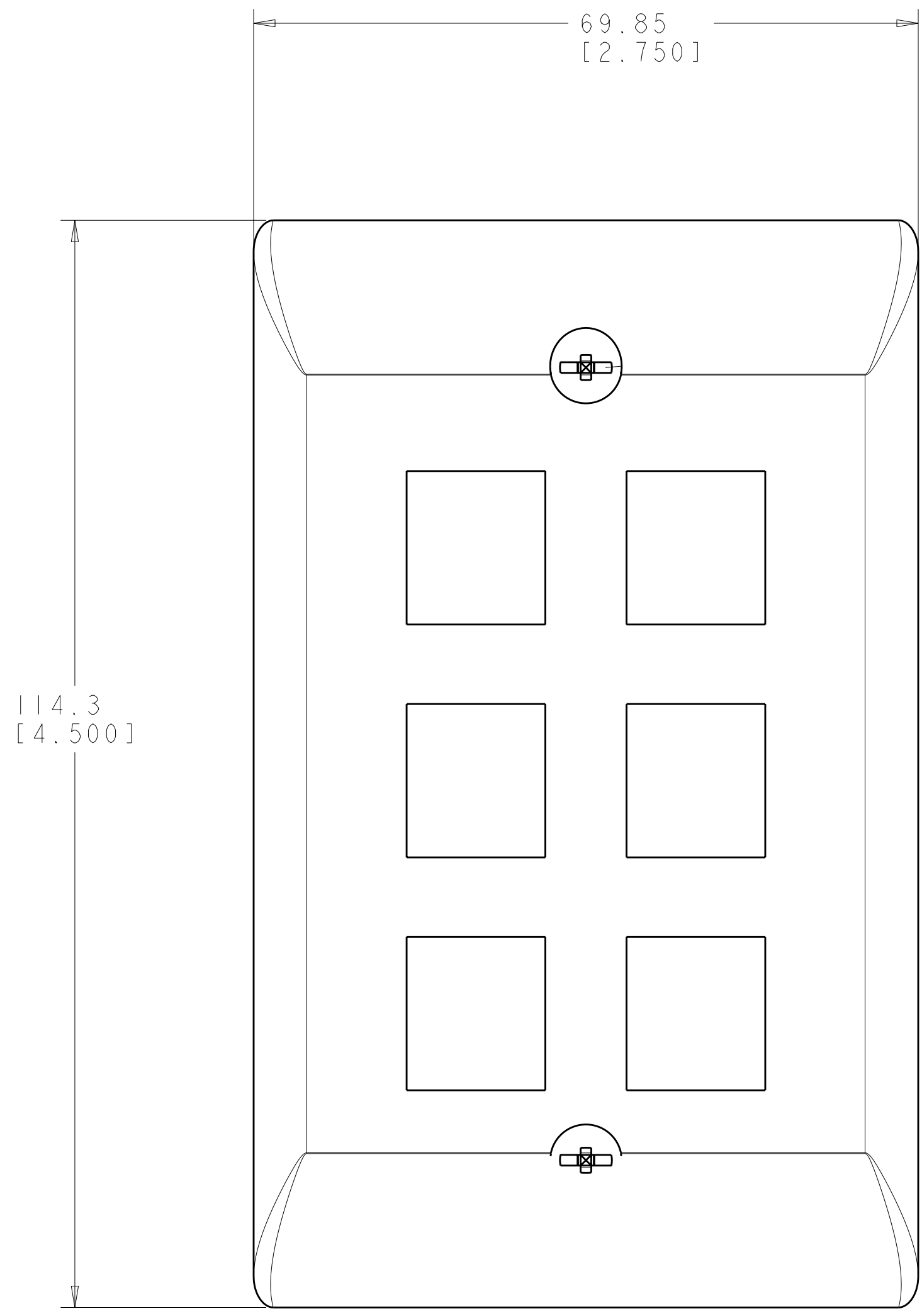

- △ DIMENSIONS ARE NOMINAL UNLESS OTHERWISE SPECIFIED.
 - △ MATERIAL:
 FACEPLATE - POLYCARBONATE MOLDING COMPOUND.
 SEE TABLE FOR COLORS.
 SCREWS - ZINC PLATED CARBON STEEL.
3. THIS KIT SHIPPED NOT ASSEMBLED.

ALPINE WHITE	1-2111025-3
ELECTRIC IVORY	1-2111025-1
NEMA GRAY	2111025-4
WHITE	2111025-3
BLACK	2111025-2
LIGHT ALMOND	2111025-1
COLOR	PART NUMBER

DIMENSIONS: MME [INCHES]		TOLERANCES UNLESS OTHERWISE SPECIFIED: 0 PLC ± 1 PLC ± 2 PLC ± 3 PLC ± 4 PLC ± ANGLES ±		DWN: S. GARRETT 31MAR2009 CHK: R. ASHRY 31MAR2009 APVD: R. ASHRY 31MAR2009		Tyco Electronics Harrisburg, PA 17105-3608	
MATERIAL: △		FINISH: △		NAME: KIT, FACEPLATE, RESIDENTIAL, SINGLE GANG, 6 PORT		SIZE: A 00779 C=2111025	
CUSTOMER DRAWING				WEIGHT: -		RESTRICTED TO: -	
				SCALE: 2:1		SHEET: 1 OF 1	
				REV: A			