

LOC		DIST		REVISIONS			
CE	16	F	LYR	DESCRIPTION	DATE	DWN	APVD
		E		REV: ECO-08-000155	07JAN2008	GG	DC

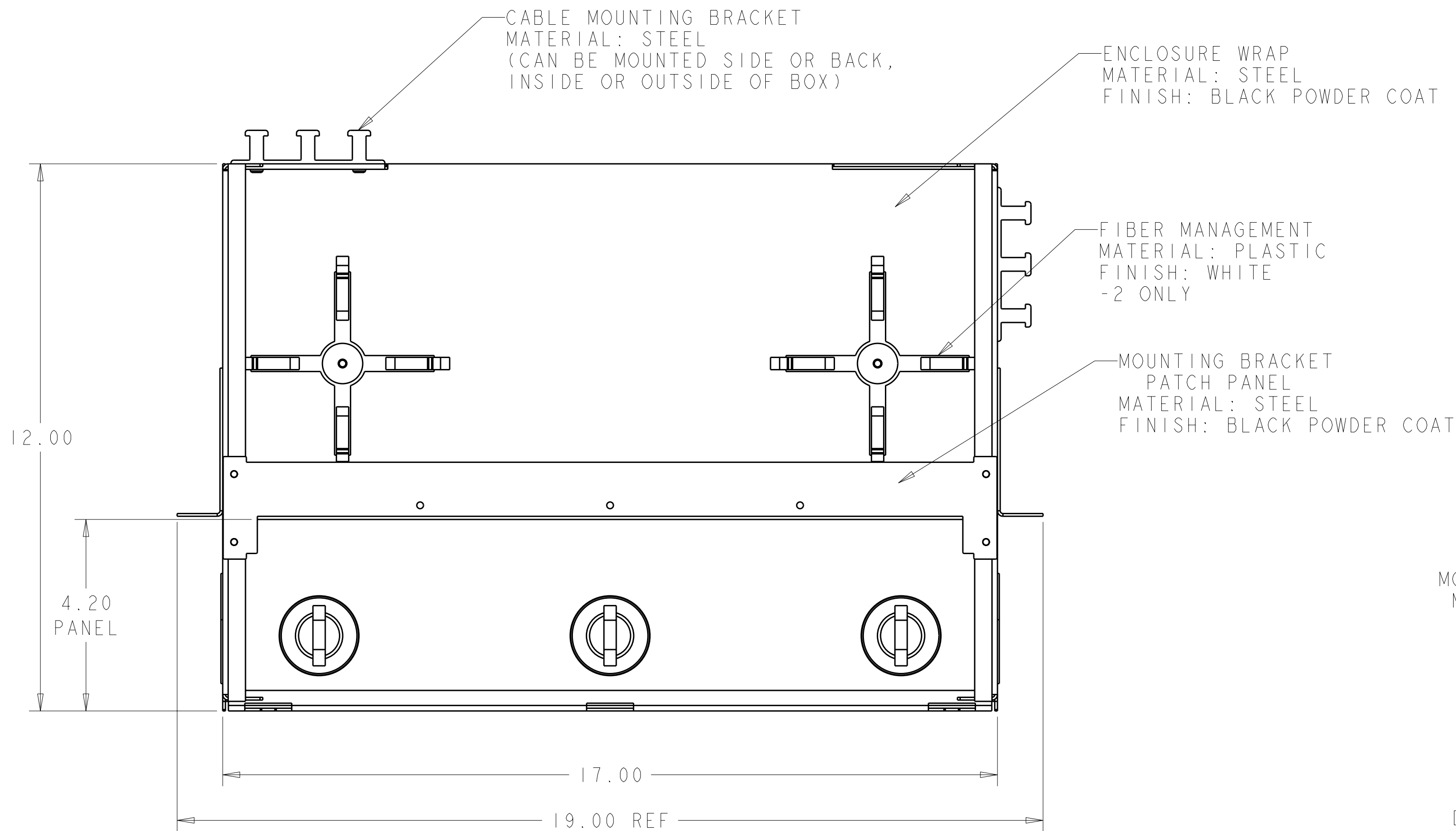

1. THE FOLLOWING ITEMS ARE BAGGED AND PLACED IN THE ENCLOSURE.
- [4] HANDLE, 1/4-TURN FASTENER
 - [2] KIT, CABLE CLAMP BRACKET
 - [4] #12-24x.50 SCREW
 - [1] LABEL, "D-A"
 - [2] LABEL, "DANGER"
2. ENCLOSURE IS PROVIDED FOR 19" RACK MOUNTING. REPOSITIONING BRACKETS WILL ALLOW FOR MOUNTING INTO A 23" RACK.

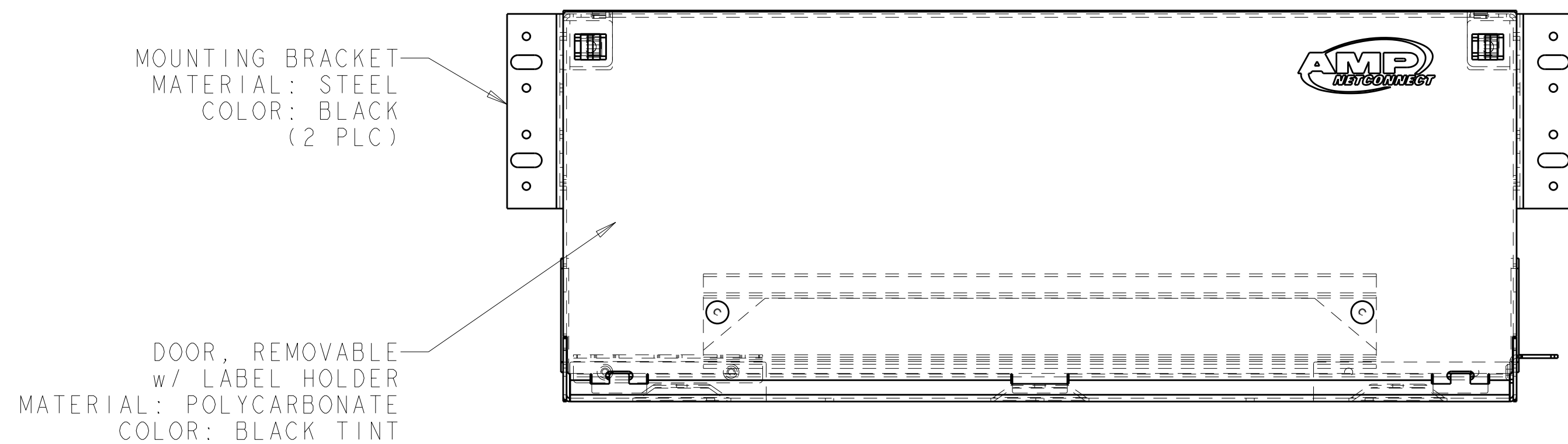

FRONT VIEW

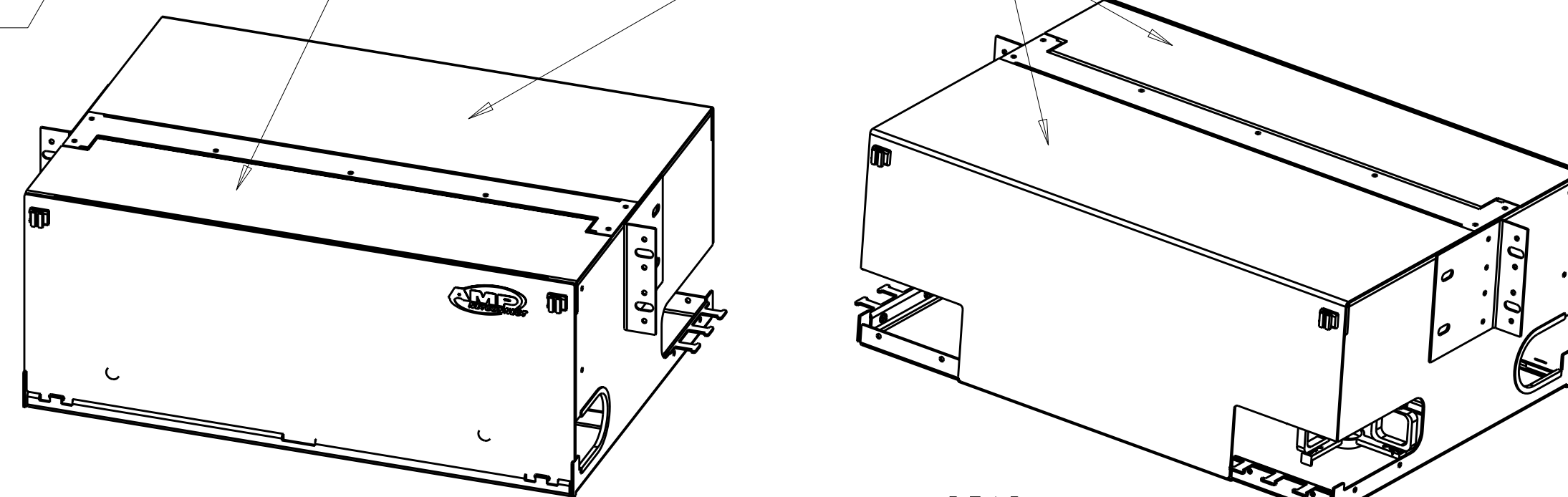
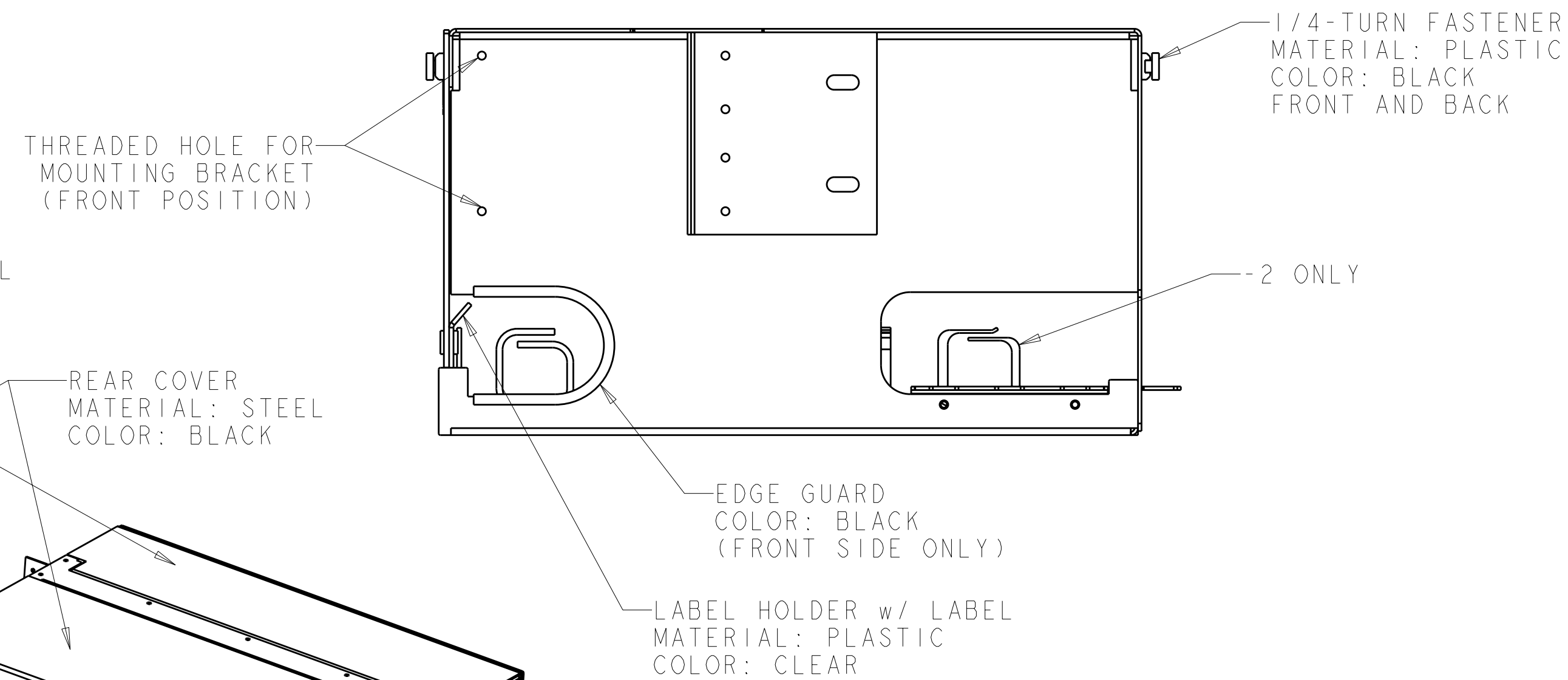
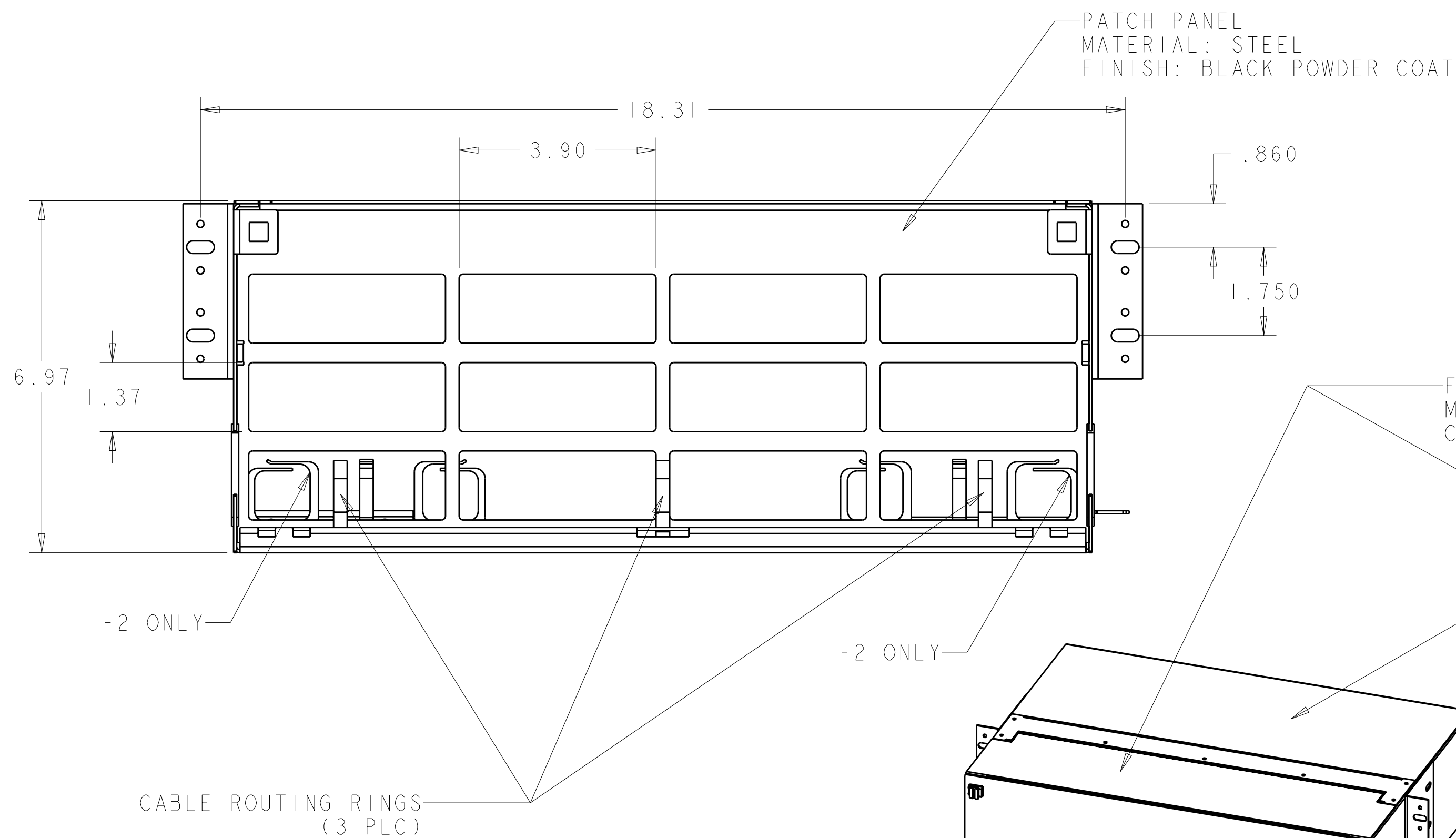

BLACK	1435593-2
BLACK	1435593-1
COLOR	PART No.

THIS DRAWING IS A CONTROLLED DOCUMENT FOR TYCO ELECTRONICS CORPORATION IT IS SUBJECT TO THE SAME CONTROL AS THE ORGANIZATION IT SHOULD BE CONTACTED FOR THE LATEST REVISION.		DWN W.J. SOURBEER 21NOV2002	Tyco Electronics Harrisburg, PA 17105-3608	
DIMENSIONS: INCHES		CHK J. HOFFER 21NOV2002	NAME ENCLOSURE, MTRJ/LC DUPLEX CASSETTE, 4U RACK MOUNT, AMPTRAC	
TOLERANCES UNLESS OTHERWISE SPECIFIED:		APVD B. BARRY 21NOV2002	PRODUCT SPEC	
0 PLC ±.1		APPLICATION SPEC		RESTRICTED TO
1 PLC ±0.1		WEIGHT		
2 PLC ±0.01		MATERIAL		SCALE
3 PLC ±0.001		FINISH		
4 PLC ±0.0001		FINISH		REV
ANGLES ±.0001		CUSTOMER DRAWING		
MATERIAL 16 GA STEEL		BLACK POWDER COAT		
		A1 00779 C=1435593		