

LOC	DIST	REVISIONS					
		P	LTR	DESCRIPTION	DATE	DWN	APVD
HM	00		B	REV; EC 0B40-0332-02	10JAN03	GG	GB

1. WILL MOUNT INTO OPENINGS DESIGNED FOR WIREMOLD 5507 SERIES FACEPLATES.
2. DIMENSIONS ARE SHOWN FOR REFERENCE ONLY.
- 3 MATERIAL: FACEPLATE – ABS MOLDING COMPOUND, 94V-0 RATED, LIGHT ALMOND.
LABEL COVER – POLYCARBONATE MOLDING COMPOUND, CLEAR.
LABEL – WHITE INDEX PAPER.
- 4 OPENINGS WILL ACCEPT AMP 110CONNECT, TOOLLESS, MT-RJ JACKS AND 110 CONNECT SL SERIES MULTIMEDIA INSERTS.
- 5 MOLD OVER SLOTS WILL ACCEPT AMP COLOR CODED ICONS.
6. THIS KIT SHIPPED NOT ASSEMBLED.
- 7 GRAY COLOR MATCHES WIREMOLD GRAY STEEL RACEWAYS.

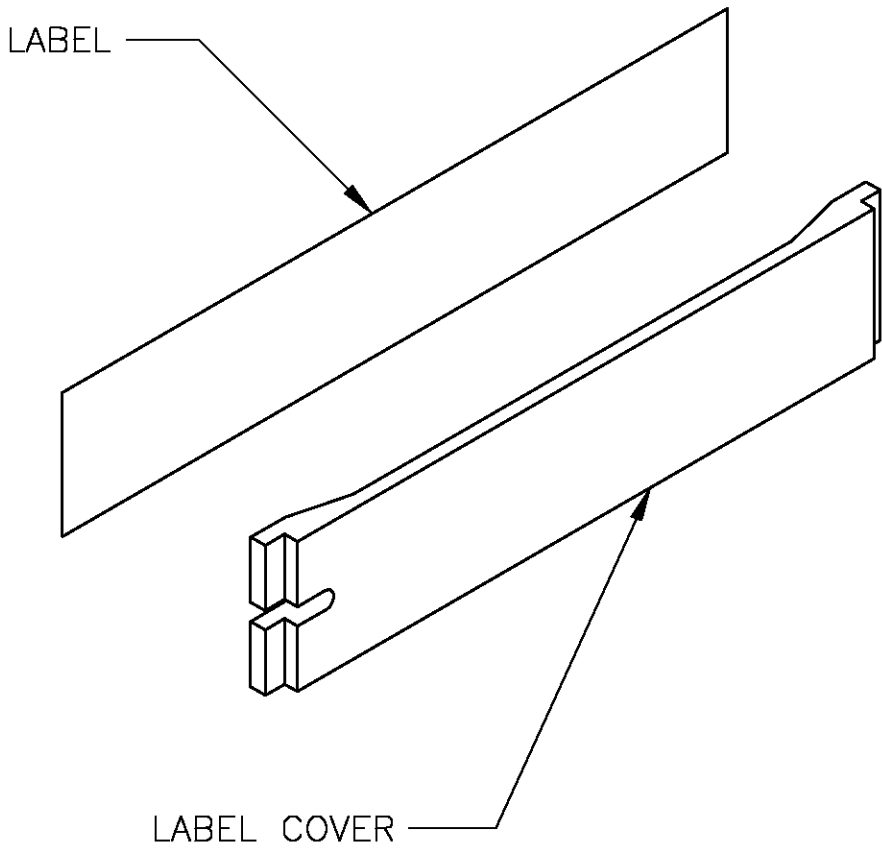
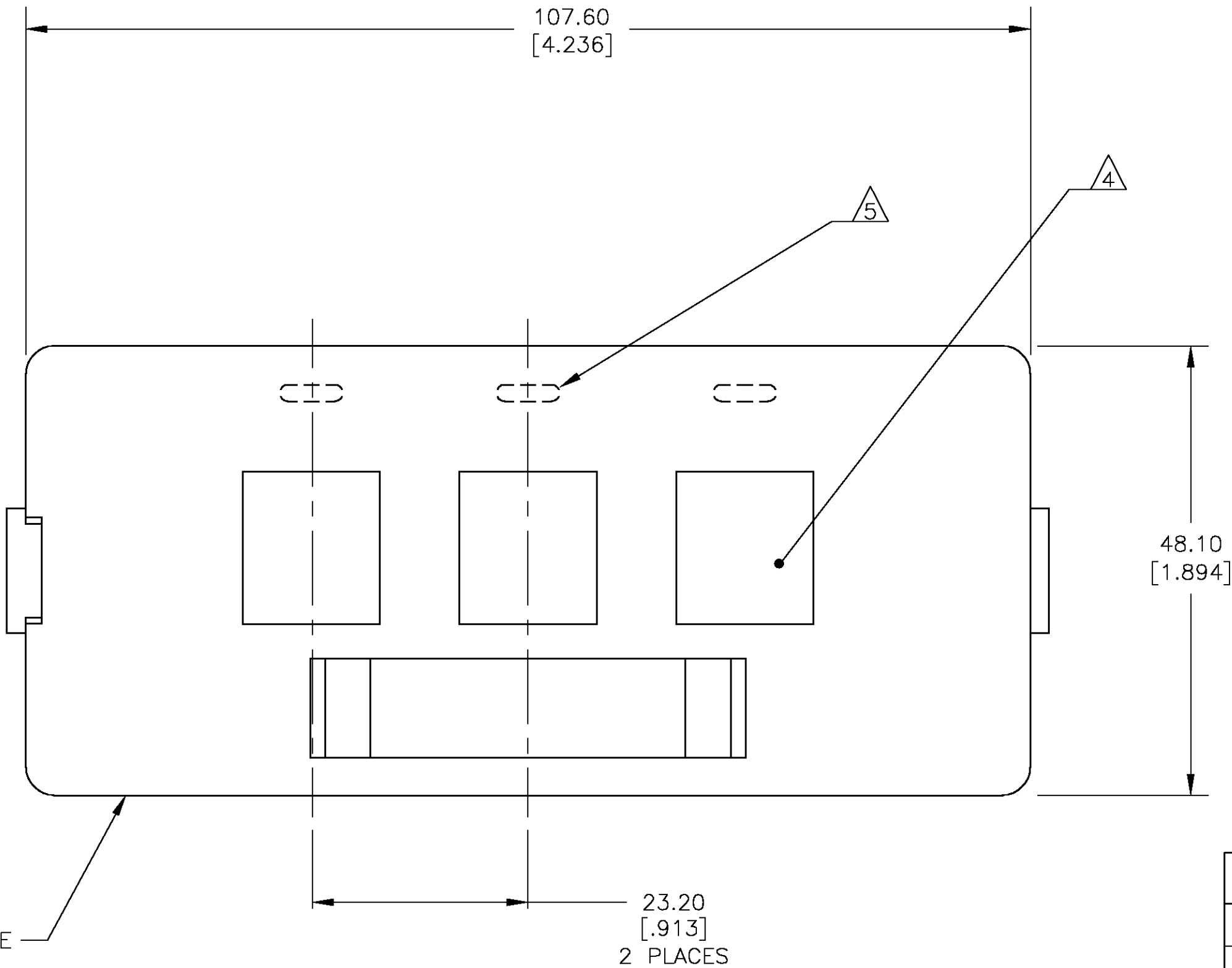
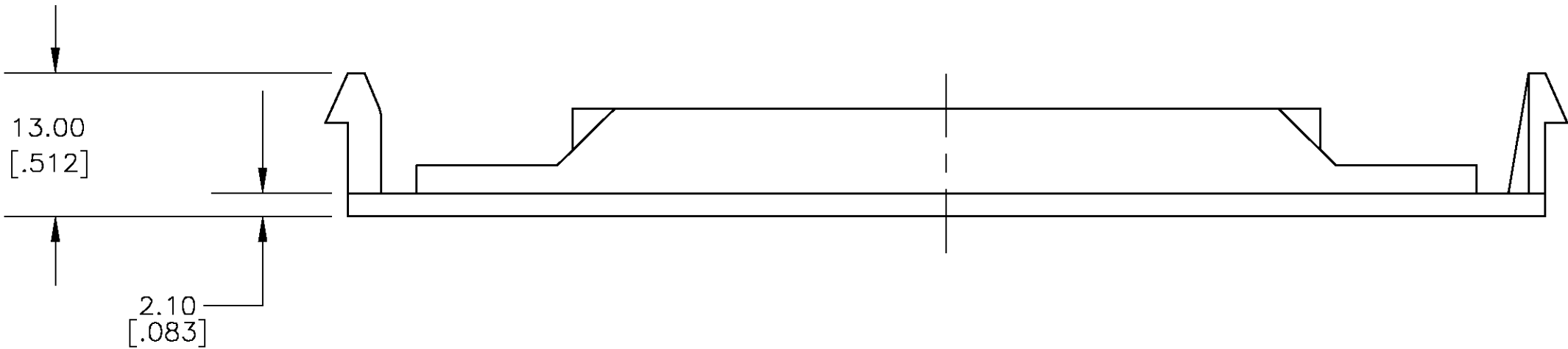

7 GRAY	1375050-4
LIGHT ALMOND	1375050-1
COLOR	PART NUMBER

THIS DRAWING IS A CONTROLLED DOCUMENT.		DWN G. GARRETT	08MAY00	AMP -			
DIMENSIONS: MM [INCHES]		CHK G. BOWMAN	10JAN00				
		APVD G. BOWMAN	10JAN00	NAME			
		PRODUCT SPEC		KIT, FACEPLATE, 3 PORT, SURFACE RACEWAY			
MATERIAL		APPLICATION SPEC		SIZE	CAGE CODE	DRAWING NO	RESTRICTED TO
		WEIGHT		A2	00779	C=1375050	-
FINISH		CUSTOMER DRAWING		SCALE	2:1	SHEET	1 OF 1
3						REV	B

D

C

B

A