

NOTE

All numerical values are in metric units [with U.S. customary units in brackets]. Dimensions are in millimeters [and inches]. Unless otherwise specified, dimensions have a tolerance of ± 0.13 [$\pm .005$] and angles have a tolerance of $\pm 2^\circ$. Figures and illustrations are for identification only and are not drawn to scale.

1. INTRODUCTION

This specification covers the requirements for application of the Access Floor Workstation Modules. The system provides an access point through raised access floors for power and data communication products. The workstation module can be used with either a modular wiring system like the AMPINNERGY* System, or through conventional building wiring methods as approved by the National Electric Code or approved local requirements.

Basic terms and features of components are provided in Figure 1.

NOTE

Separator plate shipped packaged with box kit but not shown.

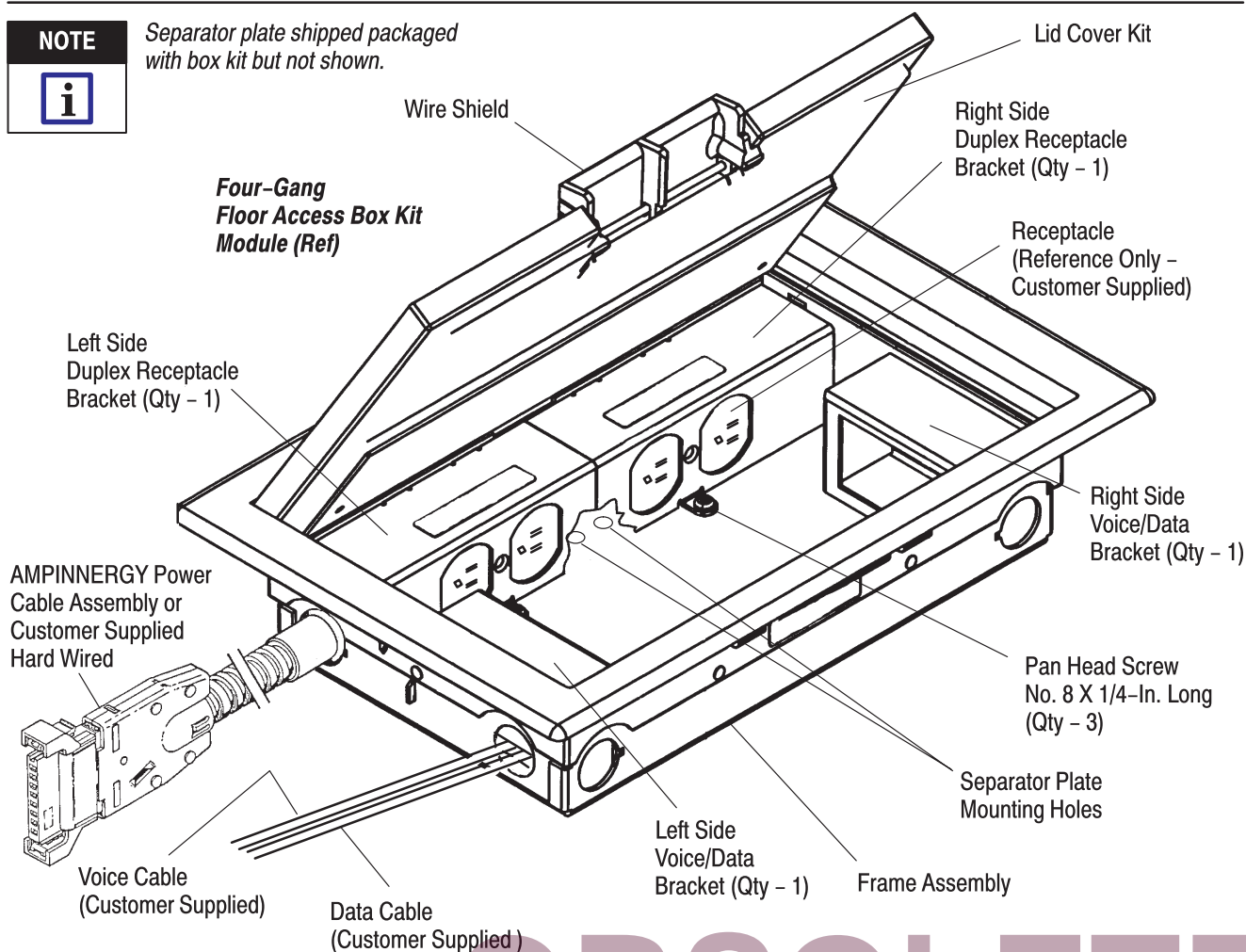

Figure 1

2. REFERENCE MATERIAL

2.1. Revision Summary

- Updated document to corporate requirements

- Added new document to Paragraph 2.4
- Added new information to Section 4, QUALIFICATIONS
- Changed all references from “2.5 in. Gang” to “Four-Gang”
- Added new text in Section 6, VISUAL AID

2.2. Customer Assistance

Reference Part Number 557601 and Product Code 0626 are representative numbers of Access Floor Workstation Modules. Use of these numbers will identify the product line and expedite your inquiries through a service network established to help you obtain product and tooling information. Such information can be obtained through a local Tyco Electronics Representative or, after purchase, by calling the Tooling Assistance Center or Product Information number at the bottom of page 1.

2.3. Drawings

Customer Drawings for specific products are available from the service network. The information contained in Customer Drawings takes priority if there is a conflict with this specification or with any other technical documentation supplied by Tyco Electronics.

2.4. Reference Information

The following list of instruction sheets (408-series) provide installation procedures for the workstation modules.

<u>Document Number</u>	<u>Document Title</u>
408-3287	Installation Procedures for Access Floor Workstation Module 557601
408-3356	Access Floor Workstation 2- and 3-Gang Modules (558718 and 558716)
408-3397	Installation Procedures for Four-Gang Floor Access Box Kit Module 406376
408-8916	Installation Procedures for Access Floor Workstation Module (AFWM) 5-Gang Enclosure Kit 1479499-1

3. REQUIREMENTS

3.1. Wire

Wire size and conduit type are specified per applicable articles of the National Electric Code.

3.2. Cable

AMPINNERGY System cables are manufactured to specification and require no field termination of conductors, except on single-ended cables being wired into a breaker panel or duplex receptacles.

3.3. Workstation Modules (Figure 2)

The workstation modules are designed to be mounted onto access floor panels and to provide an interconnection point between access floor wiring systems and workstation equipment cables.

A. Five-Gang Module

The module consists of a flush-mounted, five-gang, metallic outlet box capable of accepting any combination of power, data, or communication services in a raised floor system of 140 mm [5.5 in.] minimum floor height.

B. Four-Gang Module

The module consists of a flush-mounted, four-gang, metallic outlet box capable of accepting any combination of power, data, or communication services in a raised floor system of 66 mm [2.6 in.] minimum floor height.

C. Three-Gang Module

The module consists of a flush-mounted, three-gang, metallic outlet box capable of accepting any combination of power, data, or communication services in a raised floor system of 140 mm [5.5 in.] minimum floor height.

D. Two-Gang Module

The module consists of a flush-mounted, two-gang, metallic outlet box capable of accepting any combination of power, data, or communication services in a raised floor system of 89 mm [3.5 in.] minimum floor height.

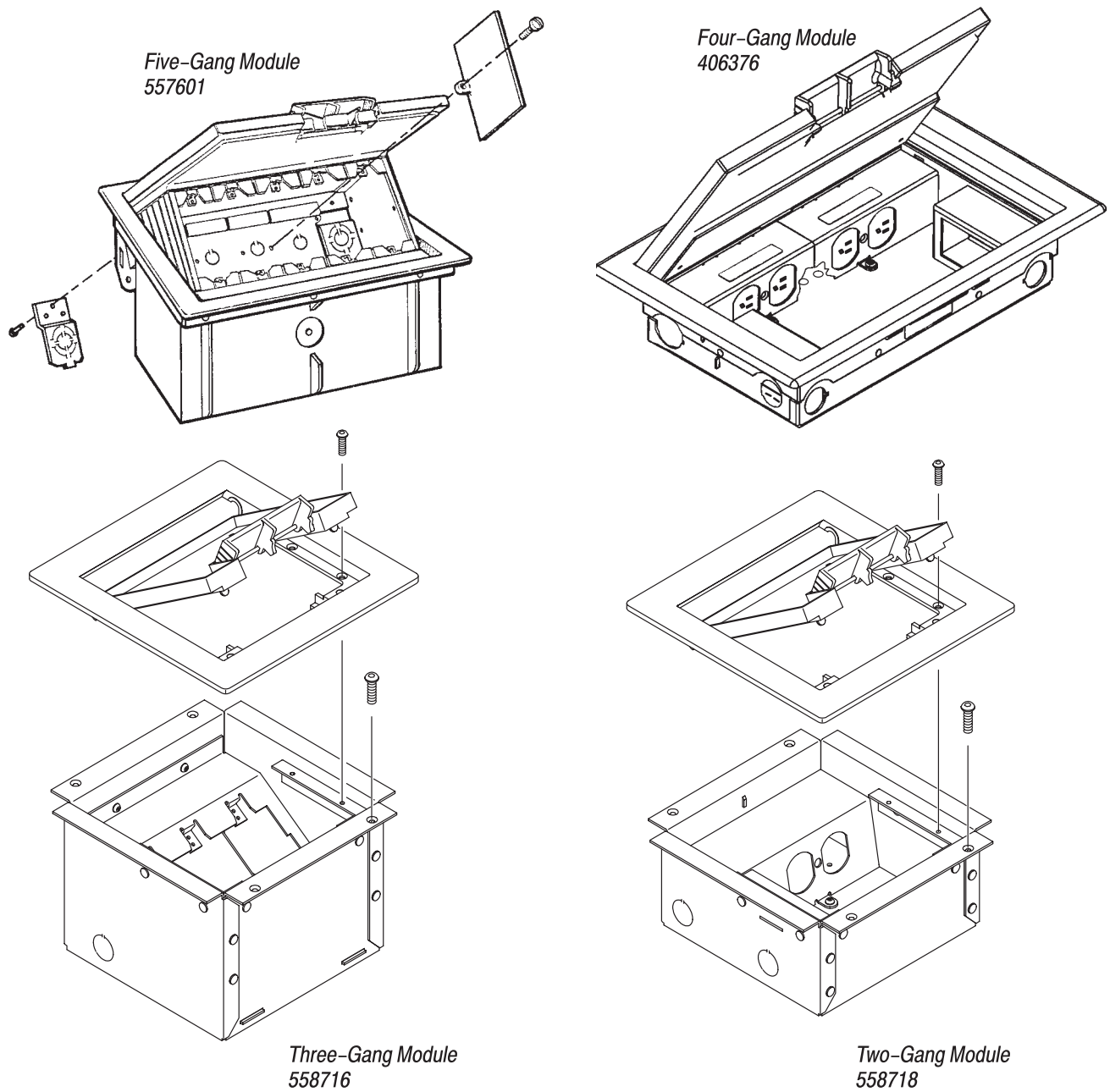

Figure 2

3.4. Floor Panel Cutouts

Cut an opening near one corner of the access floor panel, no less than 76.2 mm [3.00 in.] from the edge of the panel. See Figure 3.

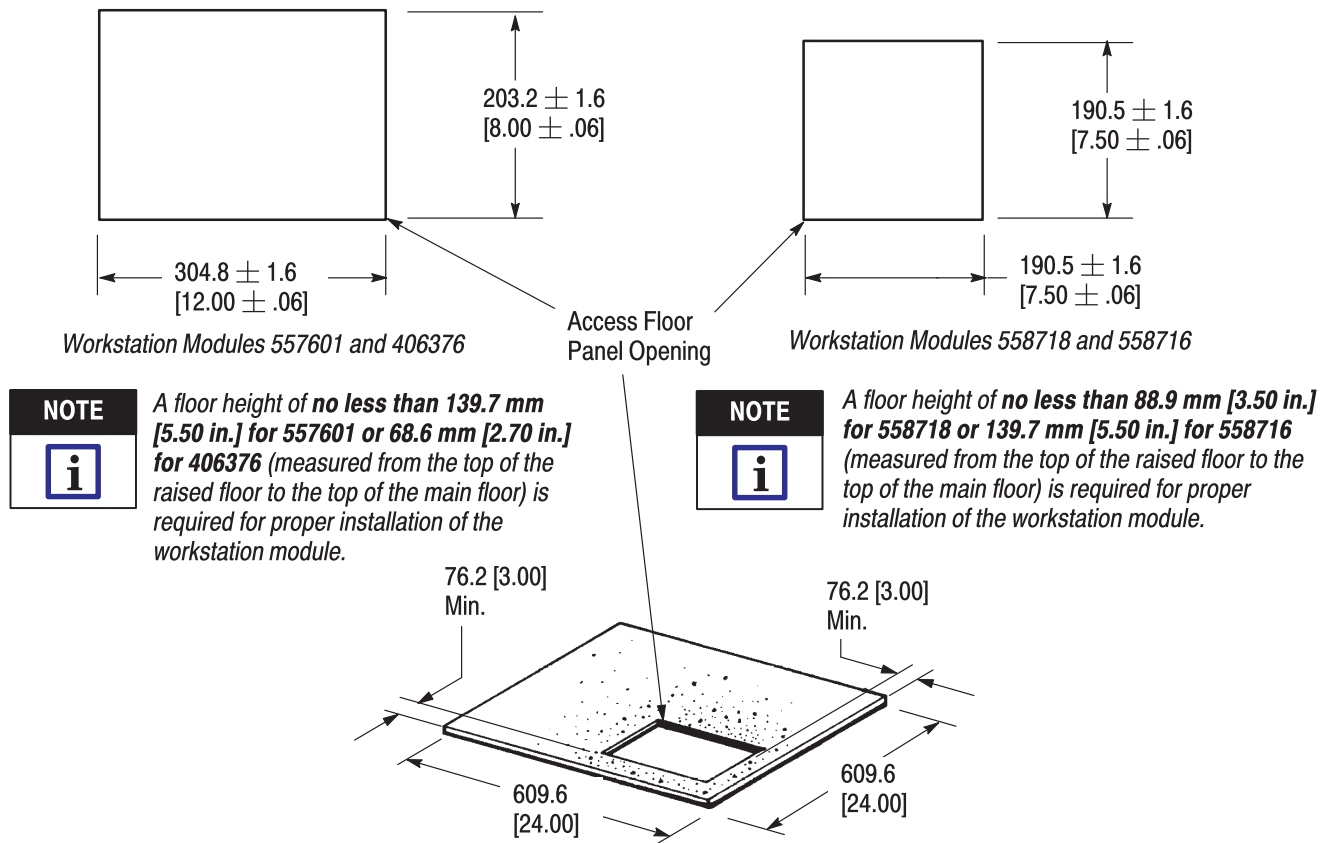

Figure 3

4. QUALIFICATIONS

Access floor workstation modules are Listed in Underwriters Laboratories Inc. (UL) File Number E130022 and E132626 for pre-wired, and are Certified in CSA International File Number LR7189 for installation into raised access flooring systems which are NOT rated as a plenum or environmental air space.

NOTE For two-gang, three-gang, and four-gang, environmental air space installations per NEC 300.22 (C) – Other spaces used for Environmental Air. The CSA certified does not. For five-gang with the addition of enclosure 1479499-1 (Instruction Sheet 408-8916), environmental air space installations per NEC 300.22 (C) – Other spaces used for Environmental Air. The CSA certification does not. Without the enclosure, the five-gang is not suitable for environmental air space.

5. TOOLING

A standard flat-bladed and Phillips head screwdriver will be required to install the box into the access flooring. Wire cutters, wire strippers, and a flat-bladed screwdriver will be required to install the duplex receptacle.

6. VISUAL AID

Figure 4 shows a typical application of an Access Floor Workstation Module. These illustrations should be used by production personnel to ensure a correctly applied product. Applications which DO NOT appear correct should be inspected using the information in the preceding pages of this specification and in the instructional material shipped with the product or tooling.

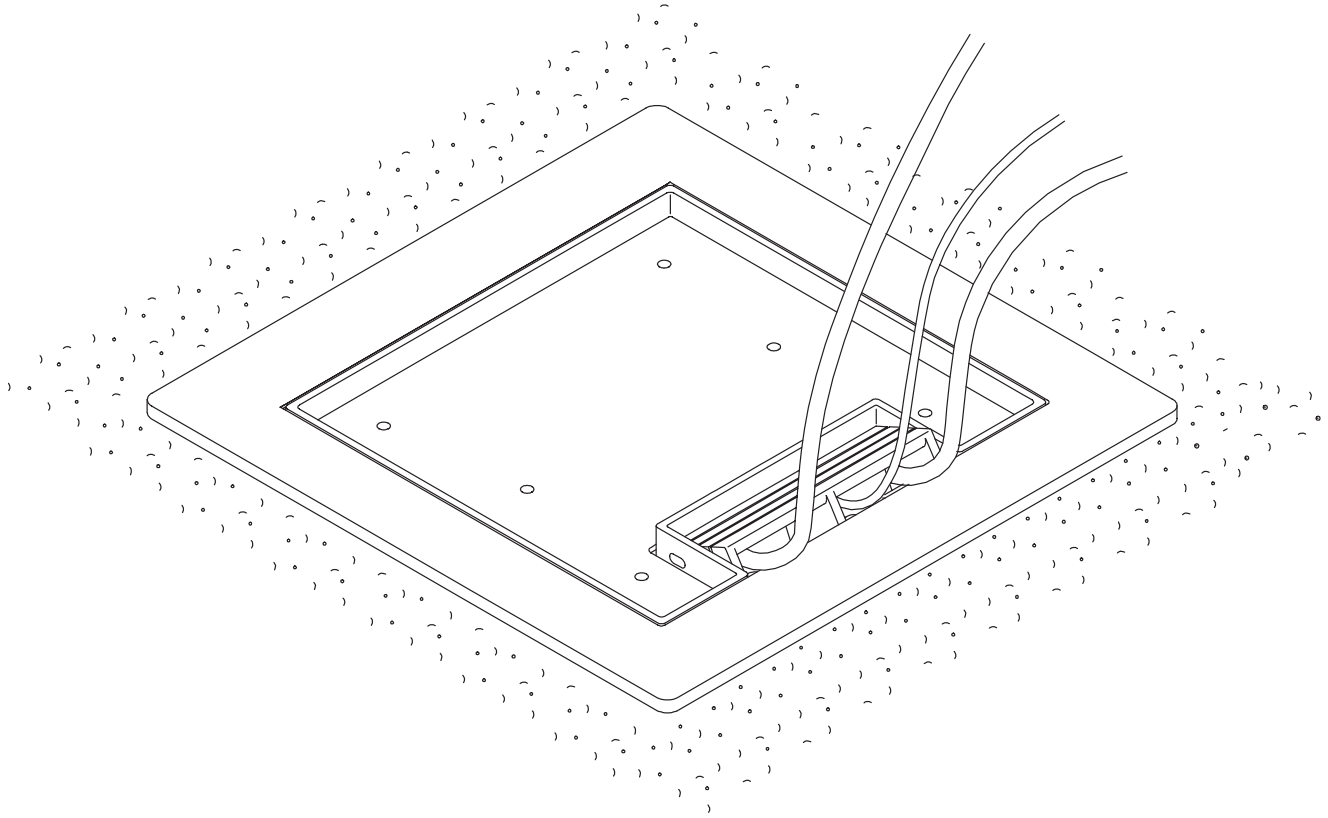

FIGURE 4. VISUAL AID