



FOR USE WITH PANDUIT SURFACE RACEWAY ROUTING SYSTEM

DROP CEILING / ENTRANCE END FITTING

Panduit Part Number: DCEFX

INSTALLATION INSTRUCTIONS

©Panduit Corp. 2005

Printed in U.S.A.

Low voltage or power applications up to 600 V

1/2", 3/4", & 1" breakouts

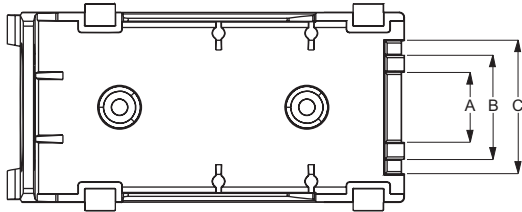
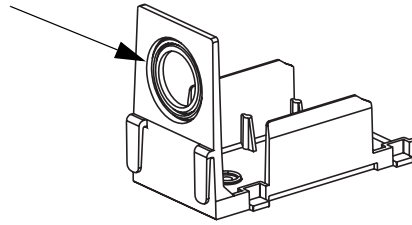
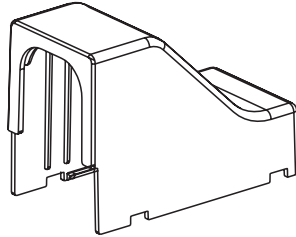

| Base Breakouts | Surface Raceway |
|----------------|------------------|
| A | LD3, LDPH3, LDS3 |
| B | LD5, LDPH5, LDS5 |
| C | LD10, LDPH10 |

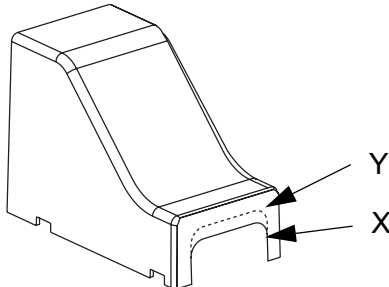

| Cover Breakouts | Surface Raceway | Adapters |
|-----------------|--------------------------------------|------------|
| X | LD3, LDS3, LDPH3 LD5, LDS5, LDPH5 | CA3 CA5 |
| Y | LD10, LDPH10 | N/A |

The mounting hardware used to secure the fitting shall be appropriate for the mounting surface.

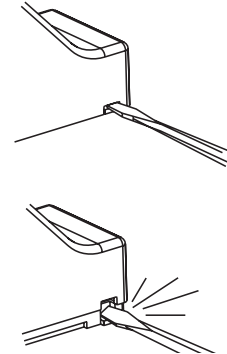
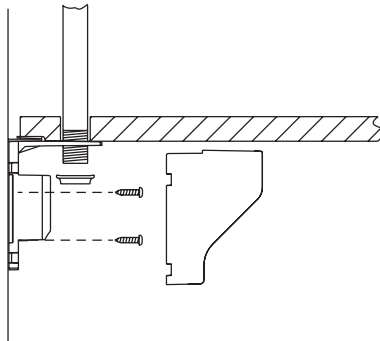
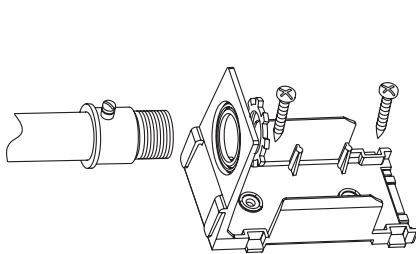

Instruction Sheet RW96

WORLDWIDE SUBSIDIARIES AND SALES OFFICES

17301 Ridgeland Avenue
Tinley Park, IL 60477-3091
Web Site: www.panduit.com



Technical Support: 866-405-6656
Fax: 866-449-1702
Email: netconnsupport@panduit.com