**PREP, PREP96**

(1) End Panel  
(6) Plastic Binding Screws  
and Barrels

**Assembly:****Step 1:**

Insert binding Screw Barrel  
into appropriate hole loca-  
tion

**Step2:**

Place End Panel Retention  
Hook over Door Bracket  
Lip.

**Step 3:**

Align barrel holes with End  
Panel mounting holes

**Step 4:**

Fasten Binding Screws

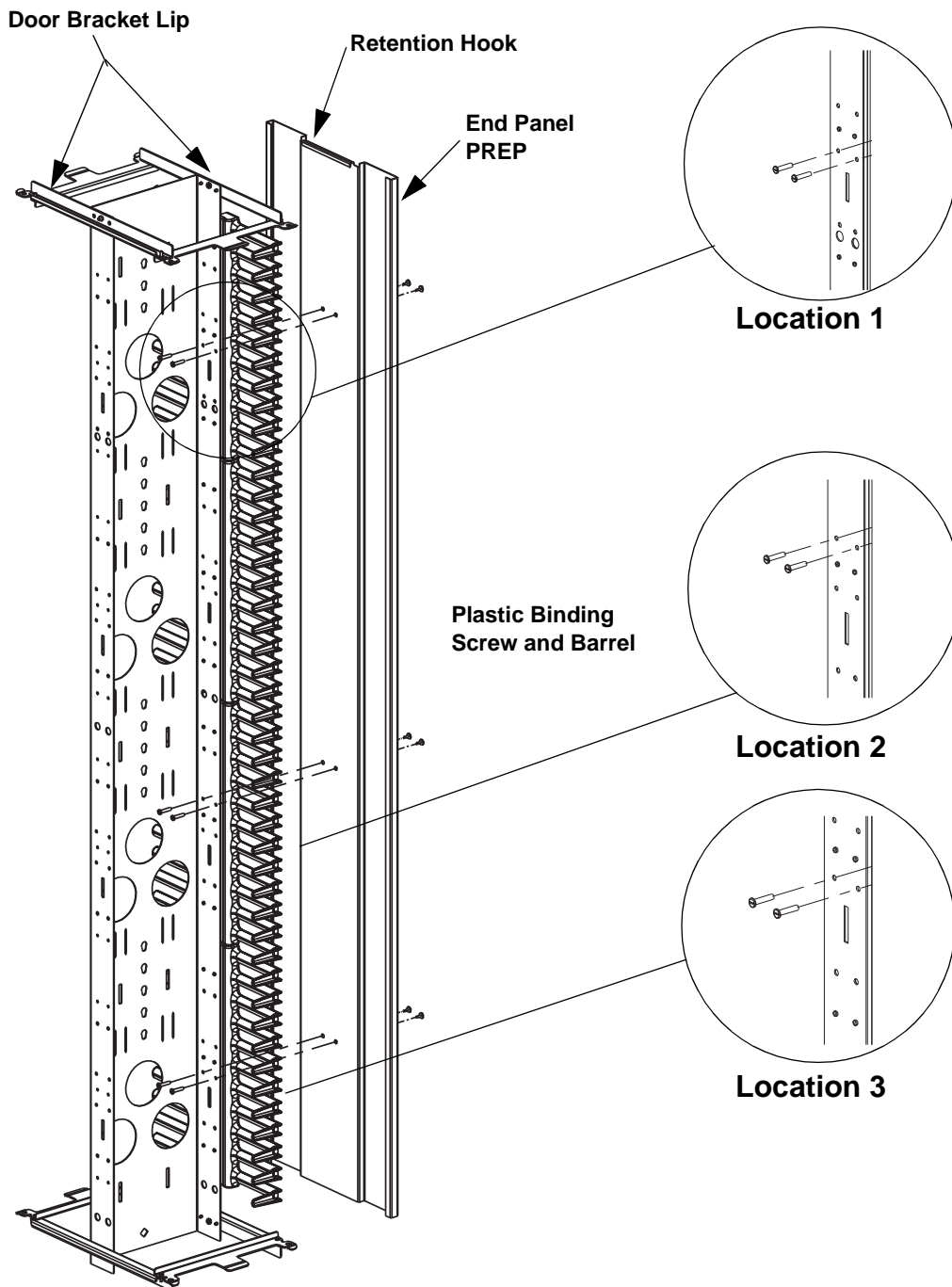
**PATCHRUNNER Installation Instructions**

Geometry modified for clarification: Not  
all molded fingers are shown

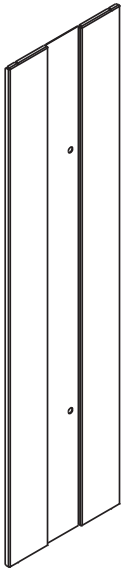
**WMPVHC45EP, WMPV45EP**

- (2) Endpanels
- (4).375-16 Acorn nuts
- (4).375 -16 Bolts

**Assembly:****Step 1:**

Insert bolt into mounting location one.

**Step 2:**

Place End Panel over the bolt and hand tighten nut.

**Step 3:**

Insert bolt into location two a secure with acorn nut. Tighten acorn nut in location one.

**Step 4:**

Repeat steps 1-3 for upper end panel

**NETRUNNER Installation Instructions**

**Note:** Install lower end panel first when using a stacked configuration.

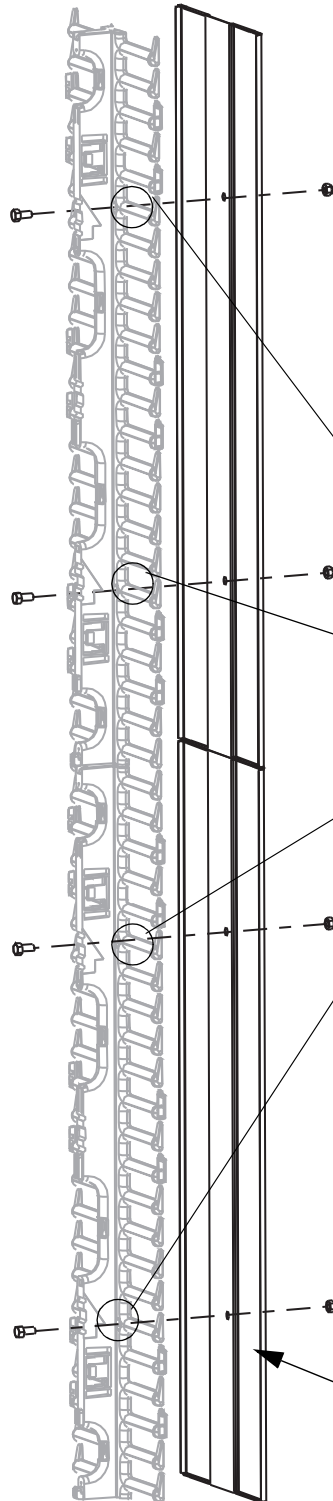
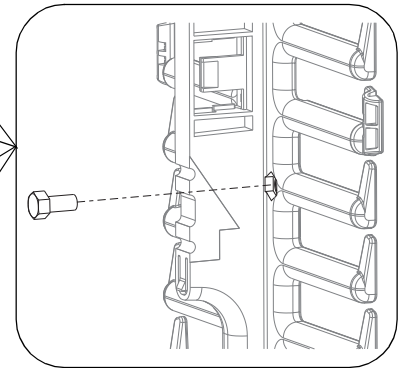
**Mounting Locations**

**End Panel**  
**WMPVHC45EP (Shown)**

Geometry modified for clarification: Not all molded fingers are shown

For instructions in Local Languages  
and Technical Support:

[www.panduit.com/resources/install\\_maintain.asp](http://www.panduit.com/resources/install_maintain.asp)



[www.panduit.com](http://www.panduit.com)

**E-mail:**  
cs@panduit.com  
**Fax:**  
(708)444-6448