

THIS COPY IS PROVIDED ON A RESTRICTED BASIS AND IS NOT TO BE USED IN ANY WAY DETRIMENTAL TO THE INTERESTS OF PANDUIT CORP.

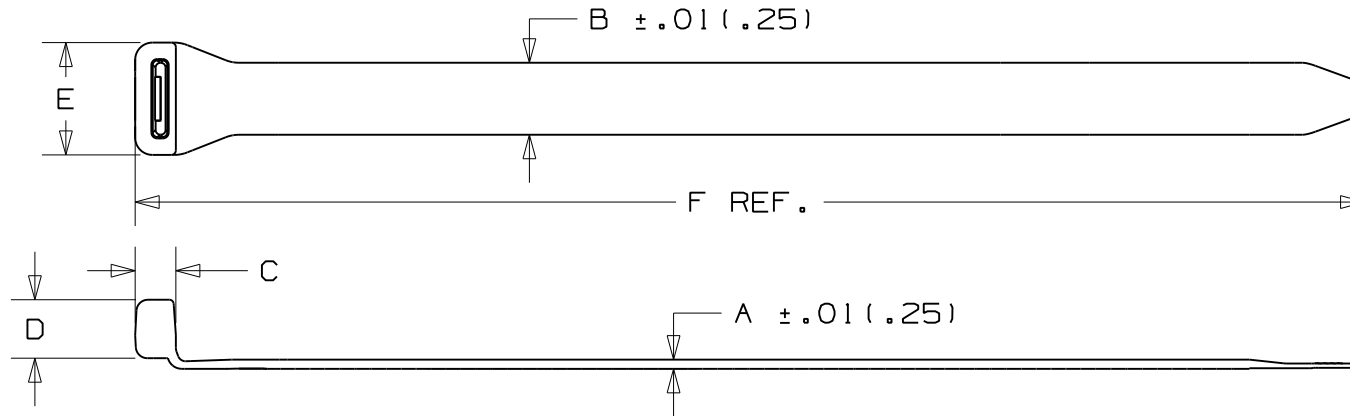

| PANDUIT PART NO. | BUNDLE DIA. | | A in (mm) | B in (mm) | C in (mm) | D in (mm) | E in (mm) | F in (mm) | MIN. LOOP TENSILE lbs (N) | WEIGHT lbs/100 pcs. (g) |
|------------------|-----------------|-----------------|-----------------|-----------------|-----------------|-----------------|-----------------|-----------------|------------------------------|-------------------------------|
| | MIN. in (mm) | MAX. in (mm) | | | | | | | | |
| ERT2M-CXX | .38 (9.7) | 2.35 (59.7) | .090 (2.29) | .500 (12.70) | .323 (8.20) | .406 (10.31) | .841 (21.36) | 8.5 (216) | 18 (80) | 1.39 (633) |
| ERT3M-CXX | .38 (9.7) | 3.0 (76.2) | .090 (2.29) | .500 (12.70) | .323 (8.20) | .406 (10.31) | .841 (21.36) | 11.0 (279) | 18 (80) | 1.71 (776.3) |
| ERT4.5M-CXX | .38 (9.7) | 4.5 (114) | .090 (2.29) | .500 (12.70) | .323 (8.20) | .406 (10.31) | .841 (21.36) | 16.0 (406) | 18 (80) | 2.41 (1093.1) |

* ERTXM-CXX

COLOR
QUANTITY IN PACKAGE
C = 100
PART NUMBER

| | |
|----|-------|
| XX | COLOR |
| 20 | BLACK |

NOTES:

1. SEE www.panduit.com FOR PART NUMBER SUFFIX DESIGNATION FOR PACKAGE SIZE AND PART COLOR.
2. MATERIAL FLAMMABILITY RATING: UL94V-0
3. HALOGEN FREE
4. PART IS RELEASABLE AND REUSABLE
5. PRODUCT IS RoHS COMPLIANT.
6. BLACK COLOR PROVIDES GREATER RESISTANCE TO DAMAGE CAUSED BY ULTRAVIOLET LIGHT - INDOOR OR OUTDOOR USE

| | |
|---|---|
| CAD FILENAME/LAYERS W10001CK/07 | |
| PANDUIT CORP. TINLEY PARK, ILLINOIS | |
| ELASTOMERIC CABLE TIES | |
| UNLESS OTHERWISE SPECIFIED, US NOMINAL DIMENSIONAL TOLERANCES ARE: (.X) ± .1(2.5) (.XXX) ± .02(0.51) (.XX) ± .02(0.5) ANGLES ± - - - | UNLESS OTHERWISE SPECIFIED, ALL DIMENSIONS ARE GIVEN IN INCHES, THIRD ANGLE PROJECTION. |
| DRAWN BY ERW | MAT'L; TPU |
| DATE 12/26/07 | SCALE NONE |
| CHK'D TGS | DRAWING NO. SS-27570 |
| REV | DWG A SIZE |

| REV | DATE | BY | CHK | DESCRIPTION | ECN | R | CUST | SUP |
|-----|---------|------|-----|--------------|----------|---|------|-----|
| 7 | 3/11/09 | MJVE | | ADDED NOTE 6 | SS-27570 | | 7 | |