

THIS COPY IS PROVIDED ON A RESTRICTED BASIS AND IS NOT TO BE USED IN ANY WAY DETRIMENTAL TO THE INTERESTS OF PANDUIT CORP.

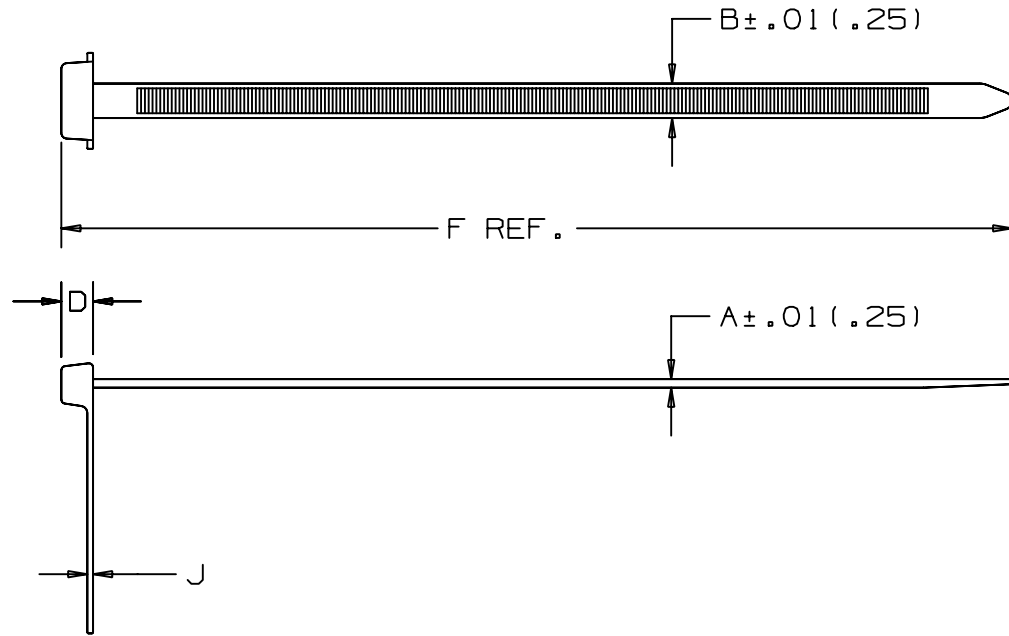
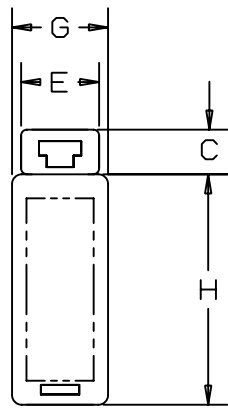

PANDUIT PART NO.*	BUNDLE DIA.		A	B	C	D	E	F	G	H	J	WRITE-ON AREA	MIN. LOOP TENSILE	CROSS- SECTION	WEIGHT lbs/100pcs. (g)
	MIN. in. (mm)	MAX. in. (mm)	in. (mm)	in. (mm)	in. (mm)	in. (mm)	in. (mm)	in. (mm)	in. (mm)	in. (mm)	in. (mm)	in. (mm)	lbs (N)		
SSM2S	.06 (1.5)	1.75 (45)	.045 (1.1)	.180 (4.6)	.230 (5.8)	.165 (4.2)	.410 (10.4)	6.7 (170)	.50 (12.7)	1.18 (30)	.030 (.8)	.44 × .96 (11.2 × 24.4)	50 (222)	STANDARD	.29 (132)
SSM4S	.06 (1.5)	4.00 (102)	.045 (1.1)	.180 (4.6)	.230 (5.8)	.165 (4.2)	.410 (10.4)	14.9 (378)	.50 (12.7)	1.18 (30)	.030 (.8)	.44 × .96 (11.2 × 24.4)	50 (222)	STANDARD	.55 (249)

NOTES:

- *1) SEE CURRENT PRICE SHEET FOR PART NUMBER SUFFIX DESIGNATION FOR PACKAGE SIZE AND PART COLOR.
- 2) RECOGNIZED UNDER THE COMPONENT PROGRAM OF UNDERWRITERS LABORATORIES INC.

DIMENSIONS IN PARENTHESES ARE IN METRIC UNITS.

PANDUIT CORP. TINLEY PARK, ILLINOIS

STA-STRAP MARKER TIE
SSM SERIES

UNLESS OTHERWISE SPECIFIED,
DIMENSIONAL TOLERANCES ARE:
(.X) ± .005 (.127)
(.XX) ± .01 (.25) ANGLES ± .005 (.127)

UNLESS OTHERWISE SPECIFIED,
ALL DIMENSIONS ARE GIVEN
IN INCHES, THIRD ANGLE PROJECTION.

DRAWN BY
RTF/AJC

MAT'L:

SCALE NONE

DATE
8-8-66

NYLON 6.6

DRAWING NO.

SS-630

DWG
A
SIZE

10	5/31/05	ERW		METRIC CONVERSION CORRECTIONS	630	10									
REV	DATE	BY	CHK	DESCRIPTION	ECN	R	CUST	SUP							