

THIS COPY IS PROVIDED ON A RESTRICTED BASIS AND IS NOT TO BE USED IN ANY WAY DETRIMENTAL TO THE INTERESTS OF PANDUIT CORP.

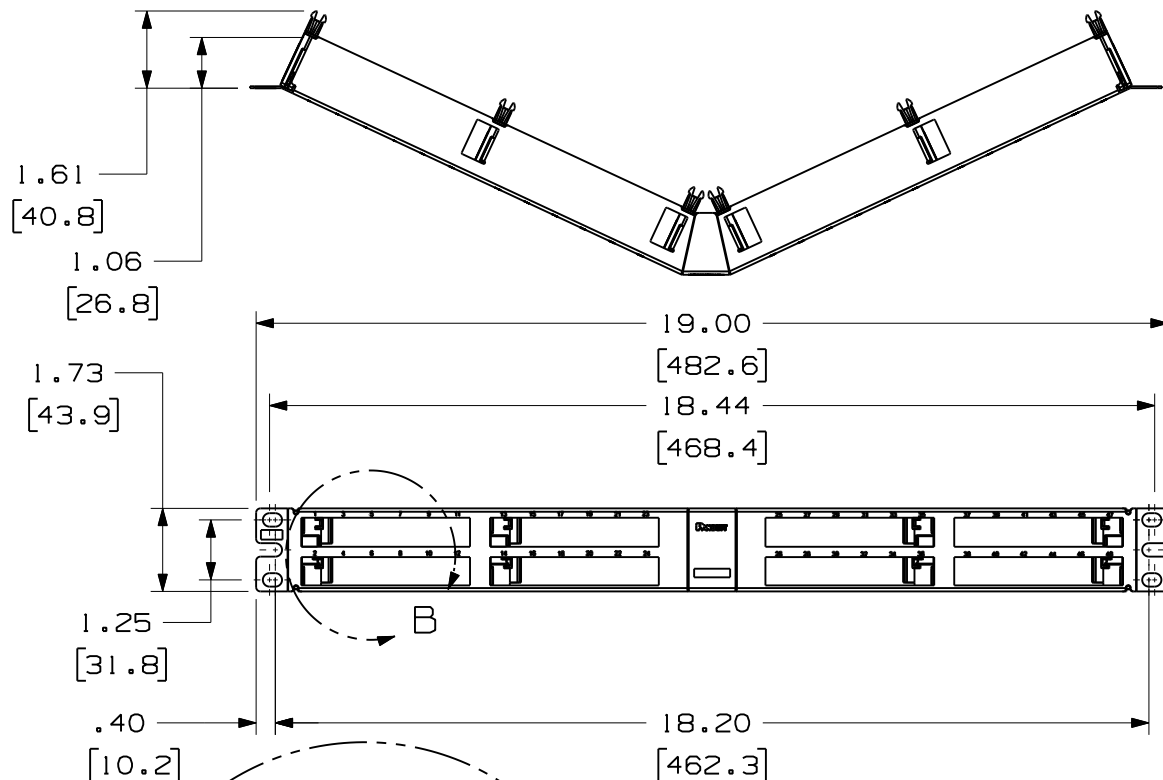

PANDUIT PART NO.	WEIGHT (APPOX.)
QAPP48HDVNSBL	0.65 lb (294.8 g)

NOTES:

1. SEE CURRENT CATALOG FOR VARIOUS APPLICATIONS.
2. THE PATCH PANEL HAS A VERTICAL NUMBERING SEQUENCE AND IS DESIGNED FOR MOUNTING TO 19" UNIVERSAL RACKS.
3. DIMENSIONS IN BRACKETS ARE IN METRIC.
4. PACKAGE CONTENTS:
  - 1- METAL STAMPING WITH SLIDE GUIDES
  - 1- SCREW KIT (INCLUDES FOUR #12-24 SCREWS)
  - 1- SCREW KIT (INCLUDES FOUR M6 SCREWS)

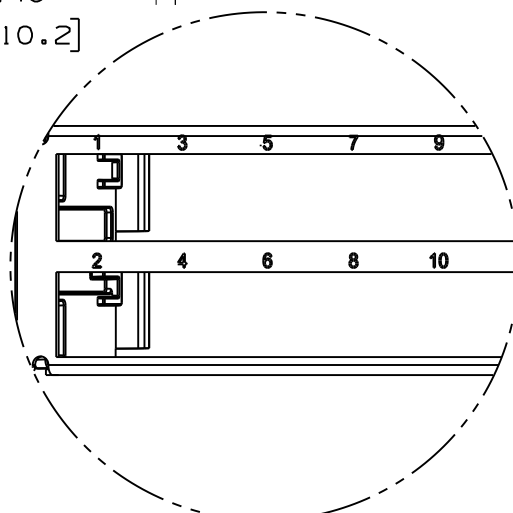
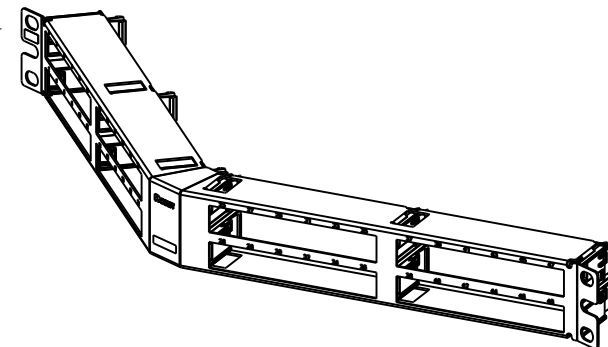

DETAIL B  
SCALE 0.750x

MODEL FILENAME M02582DJ_48PORT_1RU_ANG_CISCO_00	SIZE A
DRAWING FILENAME M02582DJ_DC64_00A.PRT	
TITLE QUICKNET 48 PORT ANGLED PATCH PANEL WITH VERTICAL NUMBERING SEQUENCE CUSTOMER DRAWING	
PANDUIT <sup>TM</sup> CORP. TINLEY PARK, ILL 60477	I.I. NUMBER
	PRODUCT SPEC
THIRD ANGLE PROJECTION	WORK INSTRUCTION
ALL DIMENSIONS ARE GIVEN IN INCHES, UNLESS OTHERWISE SPECIFIED. DIMENSIONAL TOLERANCES ARE: (.X) ±.03 (.XXX) ±.005 (.XX) ±.01 ANGLES ± 1°	SCALE .25 TO 1
DRAWN BY MDJr	MATERIAL: PANEL: CRS GUIDES: ABS
DATE 9-01-06	PART NO. QAPP48HDVNSBL
CHK'D WFM1	DRAWING NO. 02582-64

R	1-02-08	MDJr	WFM1	RELEASED TO PRODUCTION	02582-64	TRW			
REV	DATE	BY	CHK	DESCRIPTION	ECN	R	CUST	SUP	OTH