

THIS COPY IS PROVIDED ON A RESTRICTED BASIS AND IS NOT TO BE USED IN ANY WAY DETRIMENTAL TO THE INTERESTS OF PANDUIT CORP.

PANDUIT P/N	WEIGHT
KWP6PY	1.40 LB/10 PCS 1635.3 g/10 PCS

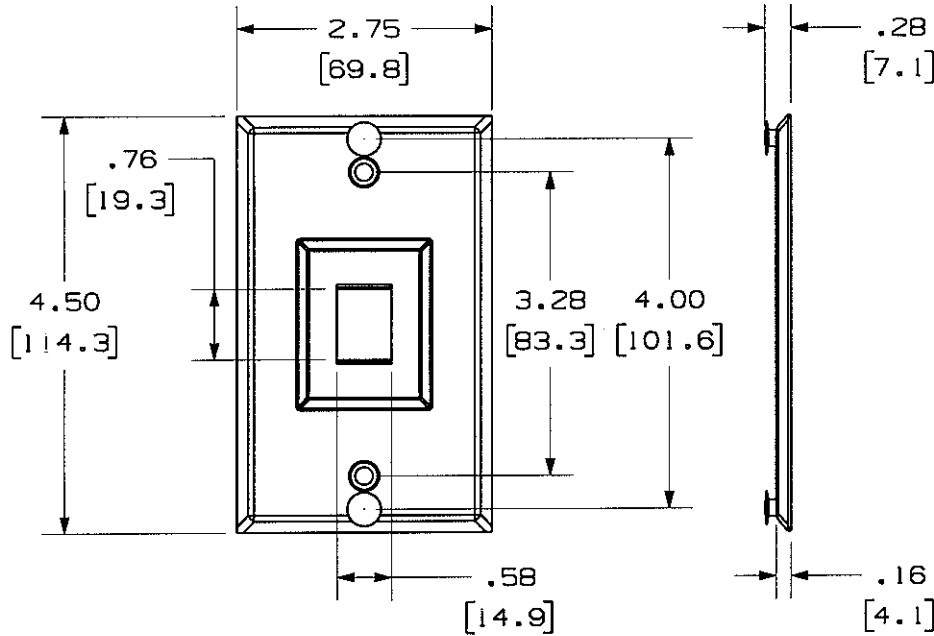

NOTES:

- SEE CATALOG FOR COMPLETE LIST OF PARTS APPLICABLE FOR USE WITH THIS PART.
- DIMENSIONS IN PARENTHESES ARE IN METRIC.
- KWP6PY CONTAINS:
 - 1- WALL PLATE
 - 1- KEYSTONE TX6 PLUS JACK MODULE
 - 2- MOUNTING SCREW

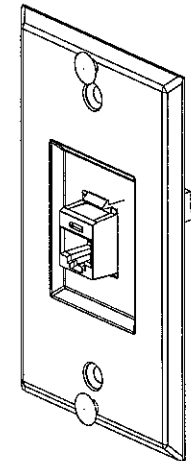

DRAWING FILENAME	M02479B0_DC41_00A.PRT	SIZE	A
------------------	-----------------------	------	---

PHONE PLATE WITH KEYSTONE TX6 PLUS JACK MODULE CUSTOMER DRAWING

<p>THIRD ANGLE PROJECTION</p>	<p>PANDUIT™ CORP. TINLEY PARK, ILL 60477</p>	I.I. NUMBER	N/A
		PRODUCT SPEC	N/A
		WORK INSTRUCTION	N/A
		SCALE	NONE
DRAWN BY	JSP	MATERIAL	20 AWG 430 STAINLESS STEEL
DATE	5-3-06	PART NO.	KWP6PY
CHK'D	<i>[Signature]</i>	DRAWING NO.	02479-041

REV	DATE	BY	CHK	DESCRIPTION	ECN	R	CUST	SUP	OTH
R	5-3-06	JSP	<i>[Signature]</i>	RELEASED TO PRODUCTION	02479-041		<i>[Signature]</i>	<i>[Signature]</i>	