

THIS COPY IS PROVIDED ON A RESTRICTED BASIS AND IS NOT TO BE USED IN ANY WAY DETRIMENTAL TO THE INTERESTS OF PANDUIT CORP.

|             |                                  |
|-------------|----------------------------------|
| PANDUIT P/N | WEIGHT                           |
| CMB**       | .51 LB/100 PCS<br>(232g/100 PCS) |
| IAPCMBWH-X  |                                  |

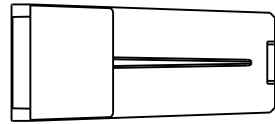

NOTES:

1. SEE CURRENT CATALOG FOR ADDITIONAL PART NUMBER SUFFIXES TO INDICATE COLOR AND OR PACKAGE QUANTITY.
2. SEE CATALOG FOR COMPLETE LIST OF PARTS APPLICABLE FOR USE WITH THIS PART.
3. DIMENSIONS IN PARENTHESES ARE IN METRIC.

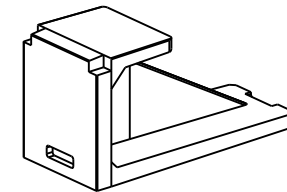
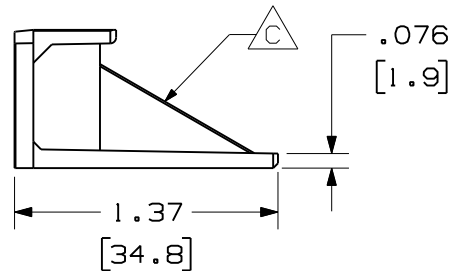
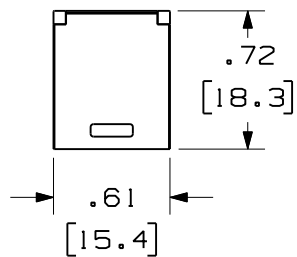

|                  |      |
|------------------|------|
| MODEL FILENAME   | SIZE |
| DRAWING FILENAME | A    |

MINI-COM BLANK MODULE  
CUSTOMER DRAWING

**PANDUIT**<sup>®</sup>  
TINLEY PARK, IL 60487

|                          |           |
|--------------------------|-----------|
| I.I. NUMBER              |           |
| PRODUCT SPEC/ PKG SPEC   |           |
| ASSY METHOD/ TEST METHOD |           |
| SCALE                    | NONE      |
| PART NO.                 | SEE TABLE |
| DRAWING NO.              | 35241-01  |

|                        |  |
|------------------------|--|
| THIRD ANGLE PROJECTION | ALL DIMENSIONS ARE GIVEN IN INCHES, UNLESS OTHERWISE SPECIFIED.<br>DIMENSIONAL TOLERANCES ARE:<br>(.X) ± (.XXX) ±.010(.3)<br>(.XX) ±.03(.8) ANGLES ± |
| DRAWN BY<br>DW         | REVIEW DRAWING NUMBERS   |
| DATE<br>06-22-95       | MAT'L<br>A ABS   |
| CHK'D<br>CEF           |  |

| REV | DATE     | BY  | CHK  | DESCRIPTION  | ECN      | R    | CUST | SUP | OTH |
|-----|----------|-----|------|--|----------|------|------|-----|-----|
| 3   | 6-8-11   | BJN | JCO  | E. ADDED SUPPLEMENTAL P/N IAPCMBWH-X                               | 35241-01 | JCO  | JCO  |     |     |
| 2   | 6-14-01  | JsP | AMYR | D. WEIGHT WAS .47LB/ 100PCS.<br>C. ADDED RIB TO PART FOR STRENGTH. | 35241-01 | AMYR | AMYR |     |     |
| 1   | 08-29-95 | DW  | CEF  | B. CORRECTED WEIGHT.<br>A. REV'D MATERIAL WAS ABS.                 | 35241-01 |      |      |     |     |
| R   | 08-15-95 | DW  | CEF  | RELEASED TO PRODUCTION.  | 35241-01 |      |      |     |     |