



PANDUIT PART NUMBER	WEIGHT
FROVRA12X4	1.00 LB/EACH (453g/EACH)



**△ D NOTES:**

1. SEE CURRENT CATALOG FOR ADDITIONAL PART SUFFIXES TO INDICATE COLOR AND/OR PACKAGE QUANTITY.
2. THE FIBERRUNNER 12x4 OUTSIDE VERTICAL RIGHT ANGLE FITTING IS DESIGNED WITH A MINIMUM 2" (50.8) BEND RADIUS TO PROTECT FIBER OPTIC CABLES.
3. DIMENSIONS IN PARENTHESES ARE IN METRIC.

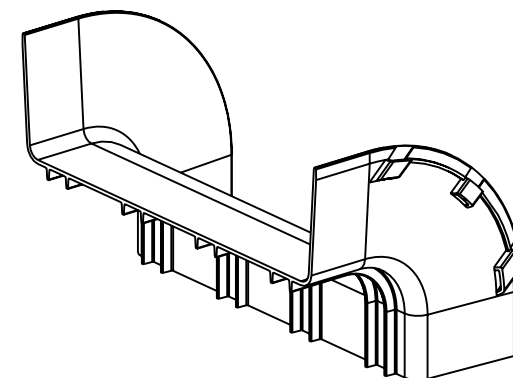
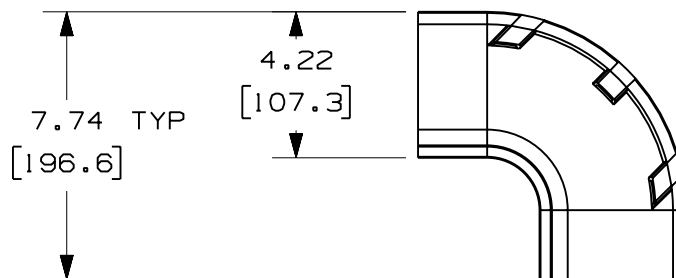
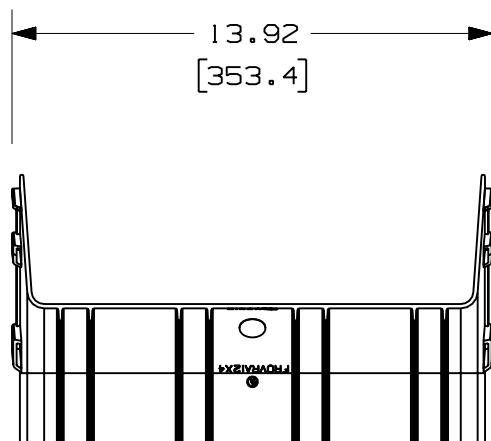

ENG. REF.: D37617CO\_DC\_FROVRA12X4\_01.prt

CAD FILENAME/LAYERS **△ B** FROVRA12X4.pdf

**PANDUIT** CORP TINLEY PARK, ILLINOIS  
**FIBERRUNNER 12x4 OUTSIDE VERTICAL RIGHT ANGLE FITTING (FROVRA12X4)**  
 CUSTOMER DRAWING

UNLESS OTHERWISE SPECIFIED, DIMENSIONAL TOLERANCES ARE:  
 (.X) ± (.XXX) ±  
 (.XX) ± .03 (.8) ANGLES ±

UNLESS OTHERWISE SPECIFIED, ALL DIMENSIONS ARE GIVEN IN INCHES, THIRD ANGLE PROJECTION.

REV	DATE	BY	CHK	DESCRIPTION	ECN	R	CUST	SUP	GMBH
-	-----	---	---	D. REVISED GENERAL NOTES C. REVISED PART WEIGHT	-----	--	--		
1	7-10-06	DTP	RN	B. REVISED CAD FILENAME A. REVISED AND REDRAWN	37617-80	RN	RN		

DRAWN BY: JHNU  
 DATE: 1-4-01  
 CHK'D: LD

MAT'L: ABS

SCALE: NONE  
 DRAWING NO.: 37617-80  
 DWG SIZE: A