



PANDUIT PART NUMBER	WEIGHT
FRDDSHC6	0.92 LB/EACH (416g/EACH)



NOTES:

1. SEE CURRENT CATALOG FOR ADDITIONAL PART SUFFIXES TO INDICATE COLOR AND/OR PACKAGE QUANTITY.
2. THE FIBERRUNNER 6x4 DUAL DOWNSPOUT WITH 4x4 EXITS HINGED COVER INCLUDES:
ONE (1) HINGED COVER,
THREE (3) HINGED INSERTS
3. DIMENSIONS IN PARENTHESES ARE IN METRIC.

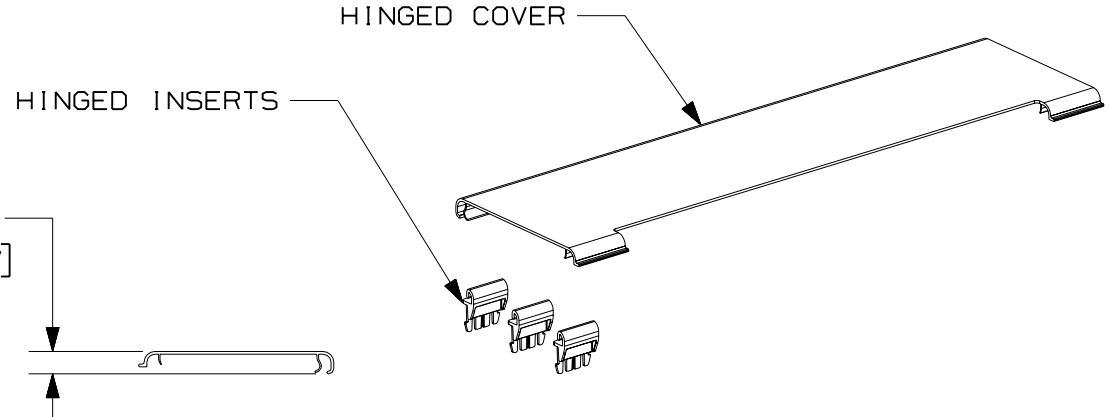
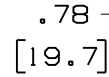
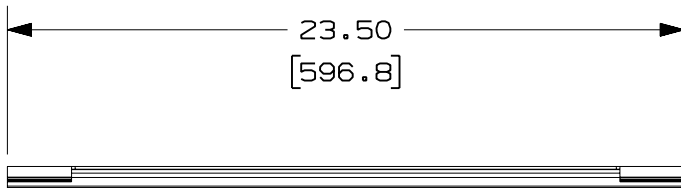
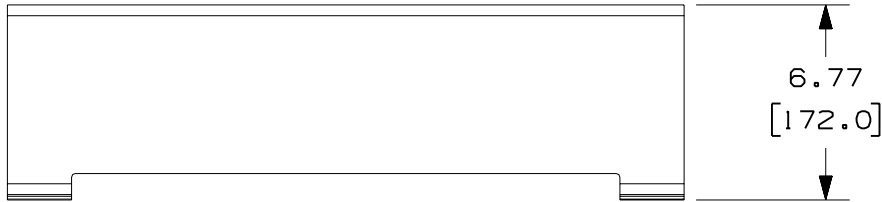

ENG. REF.: D38394BI_DC_FRDDSHC6_01.prt

CAD FILENAME/LAYERS



FRDDSHC6.pdf

PANDUIT CORP TINLEY PARK, ILLINOIS
 FIBERRUNNER 6x4 DUAL DOWNSPOUT WITH
 4x4 EXITS HINGED COVER (FRDDSHC6)
 CUSTOMER DRAWING



UNLESS OTHERWISE SPECIFIED,
 DIMENSIONAL TOLERANCES ARE:

(.X) ± (.XXX) ±
 (.XX) ± .03 (.8) ANGLES ±

UNLESS OTHERWISE SPECIFIED,
 ALL DIMENSIONS ARE GIVEN IN
 INCHES, THIRD ANGLE PROJECTION.

DRAWN BY: MSO
 DATE: 12-4-02
 CHK'D: DJWA

MAT'L:

PVC & ABS

SCALE: NONE

DRAWING NO.: 38394-06

DWG
 A
 SIZE

REV	DATE	BY	CHK	DESCRIPTION	ECN	R	CUST	SUP	GMBH
-	-----	---	---	E. REVISED PART WEIGHT	-----	--	--		
-	-----	---	---	D. REVISED GENERAL NOTES C. REVISED CAD FILENAME	-----	--	--		
1	7-6-06	DTP	RN	B. REVISED DRAWING TITLE A. REVISED AND REDRAWN	38394-06	RN	RN		