

THIS COPY IS PROVIDED ON A RESTRICTED BASIS AND IS NOT TO BE USED IN ANY WAY DETRIMENTAL TO THE INTERESTS OF PANDUIT CORP.

HSTT 12 - 48 0 2

COLOR  
 BLANK = BLACK 8 = BLUE  
 2 = RED 10 = WHITE  
 4 = YELLOW 45 = YELLOW/GREEN  
 5 = GREEN C = CLEAR

QUANTITY PER CARTON (48 IN ONLY)

NUM = 25 pcs.  
 10 = 5 pcs.  
 2 = 2 pcs.

LENGTH IN"  
 INCHES FEET:  
 .5 M=1000  
 1 D=500  
 48 T=200  
 C=100  
 L=50  
 Q=25

TUBING SIZE - EXPANDED I.D.

TT = THIN WALL  
 TTV = THIN WALL VW-1 RATED

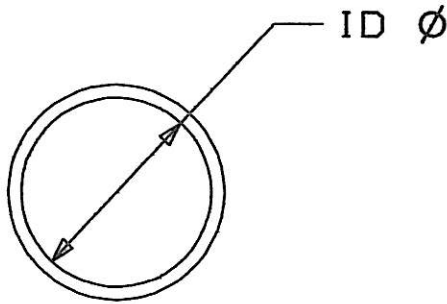

PANDUIT PART NUMBER	Min. Exp. I.D In. (mm)	Max. Rec. I.D In. (mm)	RECOVERED WALL In. (mm)
HSTT05	.046 (1.2)	.023 (.6)	.016±.003 (.406±.076)
HSTT06	.063 (1.6)	.031 (.8)	.017±.003 (.432±.076)
HSTT09	.093 (2.4)	.046 (1.2)	.020±.003 (.508±.076)
HSTT12	.125 (3.2)	.062 (1.6)	.020±.003 (.508±.076)
HSTT19	.187 (4.8)	.093 (2.4)	.020±.003 (.508±.076)
HSTT25	.250 (6.4)	.125 (3.2)	.025±.003 (.635±.076)
HSTT38	.375 (9.5)	.187 (4.8)	.025±.003 (.635±.076)
HSTT50	.500 (12.7)	.250 (6.4)	.025±.003 (.635±.076)
HSTT75	.750 (19.0)	.375 (9.5)	.030±.003 (.762±.076)
HSTT100	1.000 (25.4)	.500 (12.7)	.035±.005 (.889±.127)
HSTT150	1.500 (38.1)	.750 (19.0)	.040±.006 (1.016±.152)
HSTT200	2.000 (50.8)	1.000 (25.4)	.045±.007 (1.143±.178)
HSTT300	3.000 (76.2)	1.500 (38.1)	.050±.008 (1.270±.203)
HSTT400	4.000 (101.6)	2.000 (50.8)	.055±.009 (1.397±.229)

NOTES:

- SHRINK RATIO: 2:1
- MATERIAL: CROSSLINKED POLYOLEFIN
- "ALL WARRANTIES, INCLUDING MERCHANTABILITY AND FITNESS FOR A PARTICULAR PURPOSE, ARE EXCLUDED. (USER IS RESPONSIBLE TO DETERMINE SUITABILITY OF PRODUCT FOR INTENDED USE.)"

DIMENSIONS IN BRACKETS ARE METRIC [ mm ]

CAD FILENAME/LAYER: G00239KH\_PB\_HSTT\_00

**PANDUIT** CORP. TINLEY PARK, ILLINOIS

HSTT THIN WALL HEAT SHRINKABLE TUBING

UNLESS OTHERWISE SPECIFIED, DIMENSIONAL TOLERANCES ARE:  
 (.X) ±0.05 (1.3) (.XXX) ±0.010 (0.25)  
 (.XX) ±0.02 (0.5) ANGLES ± 5°

UNLESS OTHERWISE SPECIFIED, ALL DIMENSIONS ARE GIVEN IN INCHES, THIRD ANGLE PROJECTION.

DRAWN BY LGRAVITT

MAT'L:

SCALE NONE

DATE 5/12/03

SEE NOTES

DRAWING NO.

GB0239KH

DWG SIZE A

R	5/12/03	LGG	<i>[Signature]</i>	INITIAL RELEASE	GB0239KH	R	<i>[Signature]</i>	
REV	DATE	BY	CHK	DESCRIPTION	ECN - R	CUST	SUP	