

PANDUIT P/N	WEIGHT
FMP6	.243 LB/10 PCS. (110 G/10 PCS.)

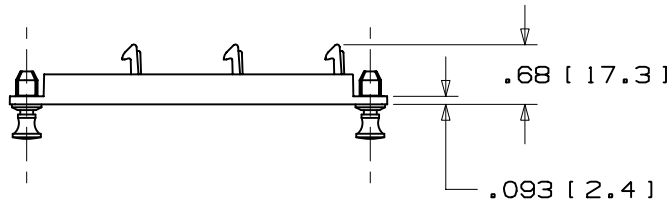

NOTES:

1. SEE CURRENT CATALOG FOR ADDITIONAL PART SUFFIXES TO INDICATE COLOR AND OR PACKAGE QUANTITY.
2. PANEL ACCEPTS UP TO SIX MINI-COM CONNECTOR MODULES FOR FIBER OPTIC, UTP, SFTP AND COAX APPLICATIONS.
3. DIMENSIONS IN PARENTHESIS ARE IN METRIC.

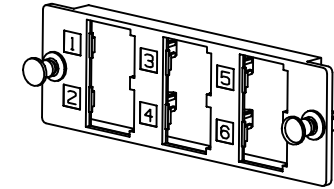
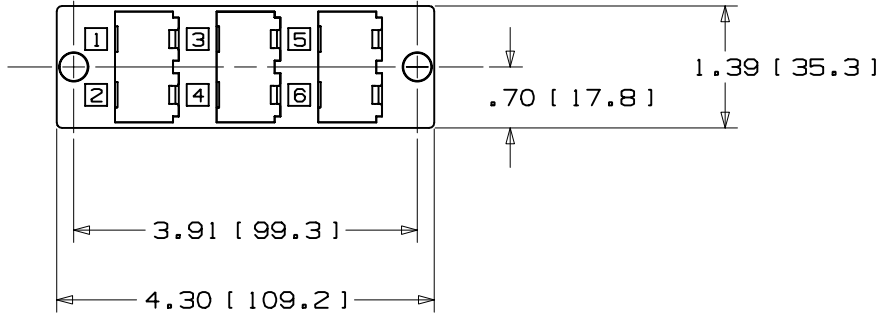

CAD FILENAME/LAYERS D35560BL\_DC\_6\_PACK\_00.PRT (5)

**PANDUIT** CORP. TINLEY PARK, ILLINOIS

MULTI-MEDIA SIX PORT PANEL  
BLANK (FMP6)  
CUSTOMER DRAWING

UNLESS OTHERWISE SPECIFIED,  
DIMENSIONAL TOLERANCES ARE:  
(.X) ± (.XXX) ± .010(.3)  
(.XX) ± .03(.8) ANGLES ±

UNLESS OTHERWISE SPECIFIED,  
ALL DIMENSIONS ARE GIVEN  
IN INCHES, THIRD ANGLE PROJECTION.

DRAWN BY  
TPC  
DATE  
10-14-96  
CHK'D

MAT'L:

ABS

SCALE HALF

DRAWING NO.

35560-12

DWG  
SIZE  
A

REV	DATE	BY	CHK	DESCRIPTION	ECN	R	CUST	SUP
R	10-14-96	TPC		RELEASED TO PRODUCTION	35560-12			