

## Cover - CVN

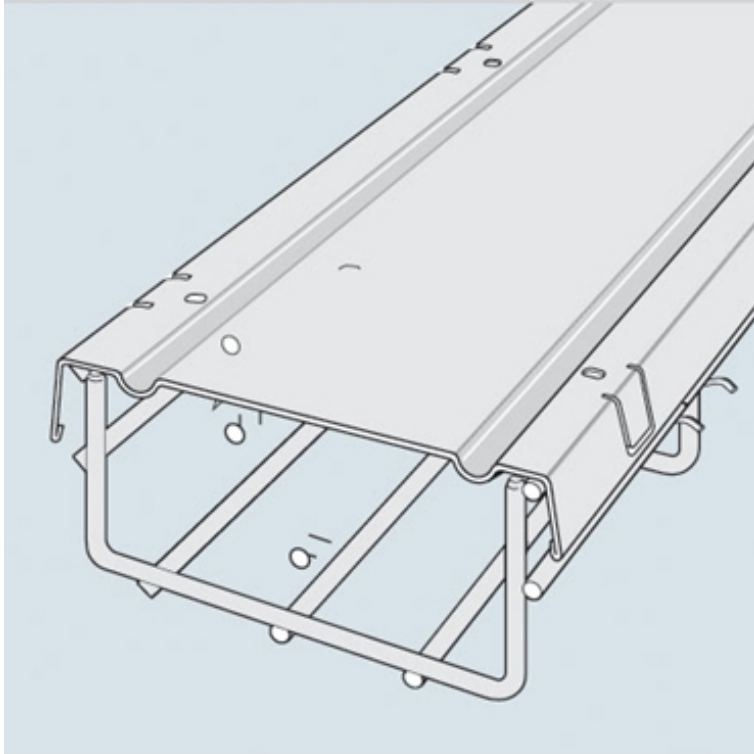

Cablofil Wiremesh Cable Tray concept based upon performance, safety and economy; three qualities which make Cablofil Wiremesh Cable Tray system preferred by installers. Cablofil adapts to the most complex configurations, and its structure gives maximum strength for minimum weight. The ease of creating fittings, carried out on site, as well as the wide range of unique and universal accessories gives complete freedom in routing combined with exceptionally fast installation.

## FEATURES

- Cover eliminates dirt and dust build-up on cable.
- Field fabricate on-site to fit changes in levels.
- Use built-in tabs for permanent attachment to tray.
- 3- 3.3' covers are included in each package to cover 1-10' section of tray.

## Specifications

The below "View Specifications Chart" highlights all sizes and finishes available.

## BUY AMERICAN ACT COMPLIANCE

Country of Origin: MULTIPLE

Buy American Act Status: Exception

Notes: While most parts within this series comply with the BAA's Country of Origin requirements, some do not. For a complete list of all parts and their respective Country of Origin, refer to the "Series Part List-COO" under "Supporting Documents" on the "Resources" tab.

Cablofil

CVN