

WALL MOUNT FILTERS

WALL MOUNT ADAPTER



The Wall Mount DSL Adapter mounts to an existing wall mount phone jack providing an unfiltered jack for your DSL connection plus one or two filtered lines for voice device communications (e.g. phone, fax, answering machine, Caller ID box) via two auxiliary phone jacks. Suttle DSL filters isolate telephone equipment impedances that interfere with ADSL communications. Features mounting lugs for wall mount phones.

- Customer installable
- Securely snaps over existing wall jack
- The single line version provides unfiltered access to line two in all ports
- Meets ANSI T1E1.421 standards for DSL filter compliance



630LCCU-xx

PART#	DESCRIPTION	DIMENSIONS
630LCCU-xx	1-line filtered, 2 voice jacks, auxiliary DSL jack	4.5"H x 3.0"W x 0.7"D
630LCCU-2F-xx	2-lines filtered, 2 voice jacks, auxiliary DSL jack	4.5"H x 3.0"W x 0.7"D

COLORS (-xx): Ivory = (50) Elec. Ivory = (52) Lt. Al. = (64) White = (85)

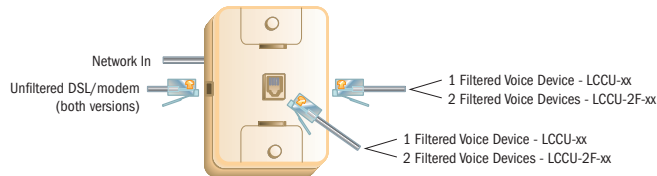

DSL TEST KITS

The Suttle DSL test unit allows an active DSL line to be tested for POTS (voice) verification without interfering with the DSL connection. The hand-held device has an RJ-14 modular jack for the input connection. The input can be made with a double-ended modular cord or with a universal test cord equipped with a modular plug on one end and test clips on the other as used with a typical Butt set.

The connection for testing is provided via two RJ-14 modular jacks, labeled "Non-Filtered" for the DSL port and "Filtered" for the POTS port, or through the test access point terminals for use with a test cord.

- Provides testing without interfering with the DSL connection
- Available with Test cords of varying length

DSL TEST KITS

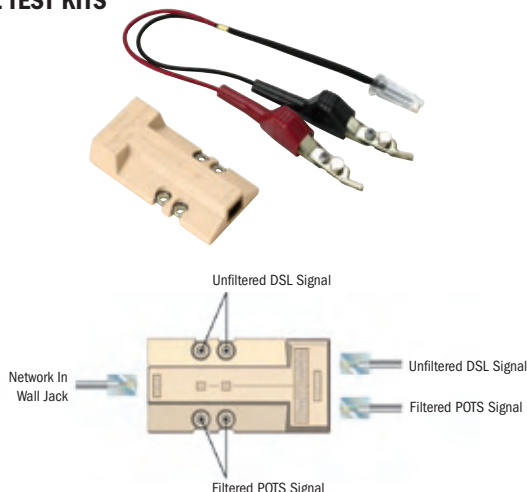

PART#	DESCRIPTION	DIMENSIONS
DSLTEST-1	DSL test unit	3.61"L x 1.84"W x 0.85"H

PART#	DESCRIPTION
DSLTESTKIT1	DSL test unit with 1 ft. test cord
DSLTESTKIT3	DSL test unit with 3 ft. test cord
DSLTESTKIT7	DSL test unit with 7 ft. test cord

PART#	DESCRIPTION
DSLTESTCORD1	1 ft. test cord
DSLTESTCORD3	3 ft. test cord
DSLTESTCORD7	7 ft. test cord