

AX103142 Modular Connectors - Optimax Enhanced Installation Tool Kit



For more Information
please call

1-800-Belden1

Description:

Optimax Enhanced Installation Tool Kit, LC/SC/ST Compatible

Usage (Overall)**Suitable Applications:**

Indoor termination of fiber cables: Patch panels, Communication outlets, Fiber-to-the-desk, Distribution frames, Direct termination to equipment, Fiber cable repair, Campus, Customer premise / Access network.

Related Parts:

Optimax connectors, Accessory kit for jacketed termination, Breakout kits

Physical Characteristics (Connectivity)**Dimensions****Dimensions:**

Height (in.)	Width (in.)	Depth (in.)
4.100	12.200	9.200

Color**Color:**

Black

Weight**Weight:**

4.250 lbs.

Included Parts**Included Parts:**

Installation tools, fiber cleaver, crimping tool, instruction manual, microscope, tweezers, alcohol wipes, marker, scissors, waste bottle, universal fiber/cable stripper and Training Video

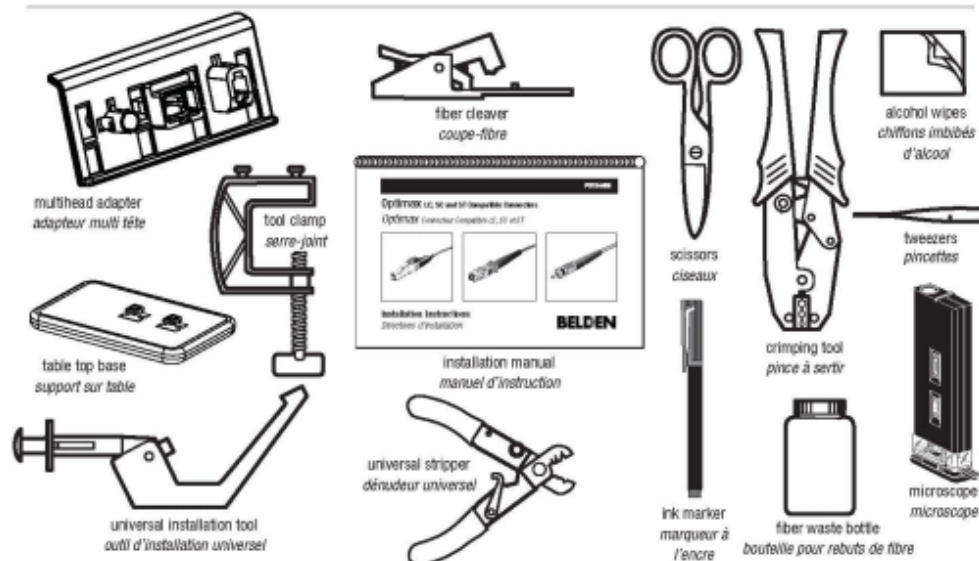
Included Parts Graphic:
Connector installation tools Outils d'installation du connecteur
**Packaging****Packaging:**

The carrying case is individually packaged in a cardboard box.

Mechanical Characteristics (Connectivity)**Storage Temperature Range:**

-40°C To +70°C

Installation Temperature Range:

-10°C To +60°C

AX103142 Modular Connectors - Optimax Enhanced Installation Tool Kit

Applicable Specifications and Agency Compliance (Overall)

Suitability

Suitability - Indoor:

Yes - Indoor

Transmission Characteristics (Connectivity)

Notes (Overall)

Notes: For Optimax termination on jacketed fibers, please use the appropriate Accessory Kit: LC - AX101984, SC - AX101794, ST - AX101793

Product Family

Part Number List:

Part Number	Description
AX103142	Optimax Enhanced Tool Kit
AX103146	Optimax Basic Tool Kit
AX103147	Optimax Enhanced Tool Kit Upgrade

Related Documents:

No related documents are available for this product

Put Ups and Colors:

Item #	Putup	Ship Weight	Color	Notes	Item Desc
AX103142	1 EA	4.453 LB			Optimax Enhanced install TK

Revision Number: 0 Revision Date: 12-21-2009

© 2012 Belden, Inc.
All Rights Reserved.

Although Belden makes every reasonable effort to ensure their accuracy at the time of this publication, information and specifications described herein are subject to error or omission and to change without notice, and the listing of such information and specifications does not ensure product availability. Belden provides the information and specifications herein on an "AS IS" basis, with no representations or warranties, whether express, statutory or implied. In no event will Belden be liable for any damages (including consequential, indirect, incidental, special, punitive, or exemplary damages) whatsoever, even if Belden has been advised of the possibility of such damages, whether in an action under contract, negligence or any other theory, arising out of or in connection with the use, or inability to use, the information or specifications described herein.

All sales of Belden products are subject to Belden's standard terms and conditions of sale.