

## specifications

Twin-70 non-metallic, multi-channel surface raceway shall be used to route, protect and conceal data, voice, fiber optic and power cabling. The raceway shall be listed as suitable for use in applications up to 600 volts between conductors by Underwriters Laboratories, Inc. per standard 5A, and by Canadian Standards Association, Inc. per 22.2 no. 62.1-03, when screw secured and installed per instructions. A full complement of fittings with a 1" minimum bend radius compliant with TIA/EIA-568-B, must be available as well as device brackets and internal junction boxes to install a variety of communication and electrical devices. The raceway shall provide two separate covers to maintain total separation of power and low voltage cabling. PANDUIT "snap-on" faceplates for data and power terminations shall be available. Twin-70 raceway must be tamper resistant yet also allow access for moves, adds and changes. Twin-70 shall be manufactured from impact-resistant material with flammability rating of V-0. Twin-70 raceway finish shall be pure of color and will resist scratches and dents, and will not peel or corrode. Twin-70 raceway shall be available in three standard colors and shall be optimized for use with the PANDUIT® PAN-NET® Communication System.

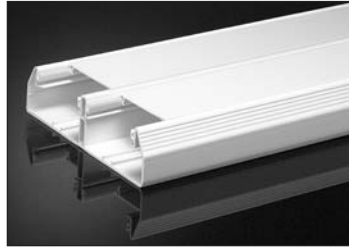

## technical information

<b>Material:</b>	Rigid PVC
<b>Flammability:</b>	UL94V-0
<b>Voltage rating:</b>	UL-5A 600VAC; CSA C22.2 No. 62.1-03 600V
<b>Approvals:</b>	UL Listed 95425 (raceway); UL Listed E116129 (fittings)
<b>NEC:</b>	Article 388
<b>Color:</b>	Off White (IW), Electrical Ivory (EI), White (WH)
<b>CSI spec form:</b>	LP-CSISPEC-Twin-70-1

## key features and benefits

<b>Separate covers throughout the system</b>	Maintains complete separation of power and data cabling systems and provides maximum safety during installation for moves, adds and changes
<b>1" bend radius control fittings</b>	Cables in the raceway will satisfy the minimum 1" bend radius requirement, preventing the potential degradation of cable performance; meets TIA/EIA standard and many warranty requirements
<b>Snap-on faceplates</b>	Faceplates snap directly onto the raceway base; cabling can be quickly accessed by removing only the faceplate, which requires less labor and lowers the cost of maintenance
<b>Each channel has a 70mm opening</b>	Accepts any NEMA standard power or communication faceplates
<b>Highly tamper resistant</b>	Very difficult for untrained personnel to enter the raceway or remove faceplates which provides maximum security for communication cabling and maximum safety for power cabling
<b>Non-metallic</b>	Lightweight, reducing installer fatigue; solid color throughout profile will not chip, peel, rust, corrode or scratch; easy to cut, reducing the need for special cutting devices; high impact resistance; durable
<b>Designer profile</b>	Aesthetically pleasing and matches a wide variety of decors
<b>Available in three standard colors</b>	Matches a variety of colors for various applications

## applications

PAN-WAY® Twin-70 Surface Raceway is a multi-channel channel raceway which provides solutions for routing low voltage, fiber optic and/or power cabling along perimeter walls. Twin-70 Raceway offers two totally independent channels which are maintained throughout the

system for independent access to power, low voltage and fiber optic cabling. Twin-70 Raceway can mount NEMA standard 70mm screw-on faceplates or superior PAN-WAY® Snap-on Faceplates directly to the independent channels.

[www.panduit.com](http://www.panduit.com)

### PAN-WAY® Twin-70 Raceway

<b>Raceway base:</b>	T702BIW*
<b>Raceway cover:</b>	T70CIW*
<b>Divider Wall:</b>	T70DW*

### TWIN-70 Raceway Fittings and Accessories

<b>Base coupling fitting:</b>	T702BCIW-X
<b>Cover coupler fitting:</b>	T70CCIW-X
<b>Outside corner fitting:</b>	T702OCIW
<b>Inside corner fitting:</b>	T702ICIW
<b>Right angle fitting:</b>	T702RAIW
<b>End cap fitting:</b>	T702ECIW
<b>Entrance end fitting:</b>	T702EEIW
<b>Tee fitting:</b>	T702TIW
<b>Transition fitting:</b>	T702TRIW
<b>Transition fitting:</b>	T702TRLIW
<b>Transition divided insert fitting:</b>	T702TRI
<b>Wire retainer:</b>	T70WR-X
<b>Device bracket:</b>	T70DB-X
<b>Standard faceplate bracket:</b>	T70SDB-X
<b>Three sided hanging box:</b>	T70HB3-X
<b>GFCI three sided hanging box:</b>	T70HB3GFCI-X

All parts listed in Off White (IW) color. To order other colors substitute Electrical Ivory (EI), and White (WH).

\*Insert raceway length of 8' or 10'

# PAN-WAY® Twin-70 Surface Raceway System

## Wire Fill

Open Channel 40% Cable Fill Capacity	
Cable Type	# of Cables
12 AWG	13
Cat 6 cables	16
Cat 5e cables	22
2 strand Fiber Optic cable	34

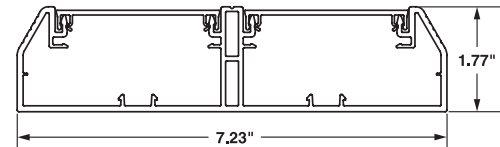

TWIN-70  
Left Internal Area = 4.59 Sq. In.  
Right Internal Area = 4.59 Sq. In.

## Twin-70 Raceway

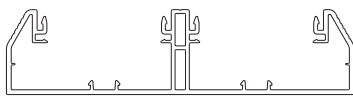

T702B



T70C

## Fittings and Accessories

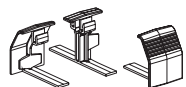

T702BC-X

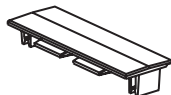

T70CC-X

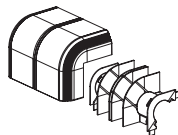

T702OC

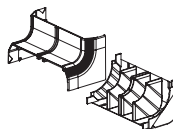

T702IC

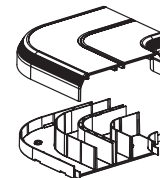

T702RA

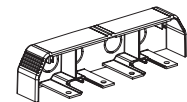

T702EC

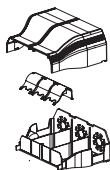

T702EE

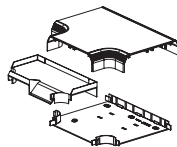

T702T

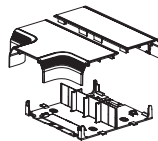

T702TR

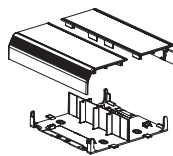

T702TRL

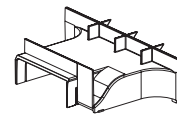

T702TRI

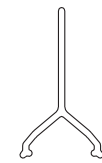

T70DW

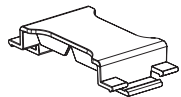

T70WR-X

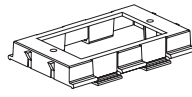

T70DB-X

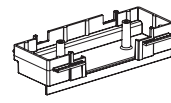

T70HB3-X

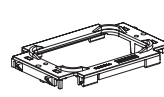

T70SDB-X

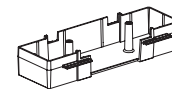

T70HB3GFCI-X

### WORLDWIDE SUBSIDIARIES AND SALES OFFICES

PANDUIT CANADA  
Markham, Ontario  
cs-cdn@panduit.com  
Phone: 800.777.3300

PANDUIT EUROPE LTD.  
London, UK  
cs-emea@panduit.com  
Phone: 44.20.8601.7200

PANDUIT SINGAPORE PTE. LTD.  
Republic of Singapore  
cs-ap@panduit.com  
Phone: 65.6379.6700

PANDUIT JAPAN  
Tokyo, Japan  
cs-japan@panduit.com  
Phone: 81.3.3767.7011

PANDUIT LATIN AMERICA  
Jalisco, Mexico  
cs-la@panduit.com  
Phone: 52.333.666.2501

PANDUIT AUSTRALIA PTY. LTD.  
Victoria, Australia  
cs-aus@panduit.com  
Phone: 61.3.9794.9020

For a copy of PANDUIT product warranties, log on to [www.panduit.com/warranty](http://www.panduit.com/warranty)



For more information  
Visit us at [www.panduit.com/srsp09](http://www.panduit.com/srsp09)  
Contact Customer Service by email: [cs@panduit.com](mailto:cs@panduit.com)  
or by phone: 800-777-3300 and reference SRSP09

© 2005 PANDUIT Corp.  
ALL RIGHTS RESERVED.  
Printed in the U.S.A.  
WW-SRSP09  
7/2005